

**zummi**

Customer Service:  
[reachout@euroactiveproducts.com](mailto:reachout@euroactiveproducts.com)

Due to variation in style and design the illustrations used in this instruction manual are generic.  
Variation in design may occur in the images shown.

Supplied by Euroactive HK, Ltd.  
79/ 80 Furze Road, Sandyford Business Estate, Dublin 18, Ireland  
International House, 12 Constance Street, London, E16 2DQ, United Kingdom  
A3/ 3FL, West Wing TST Centre, 66 Mody Road, TST East, Kowloon, Hong Kong



**zummi**

**10+**  
MONTHS

**25**  
KG

MAXIMUM  
WEIGHT

## Blaze 6-in-1 Trike

### Instruction Manual

**IMPORTANT:  
RETAIN FOR FUTURE  
REFERENCE  
READ CAREFULLY**

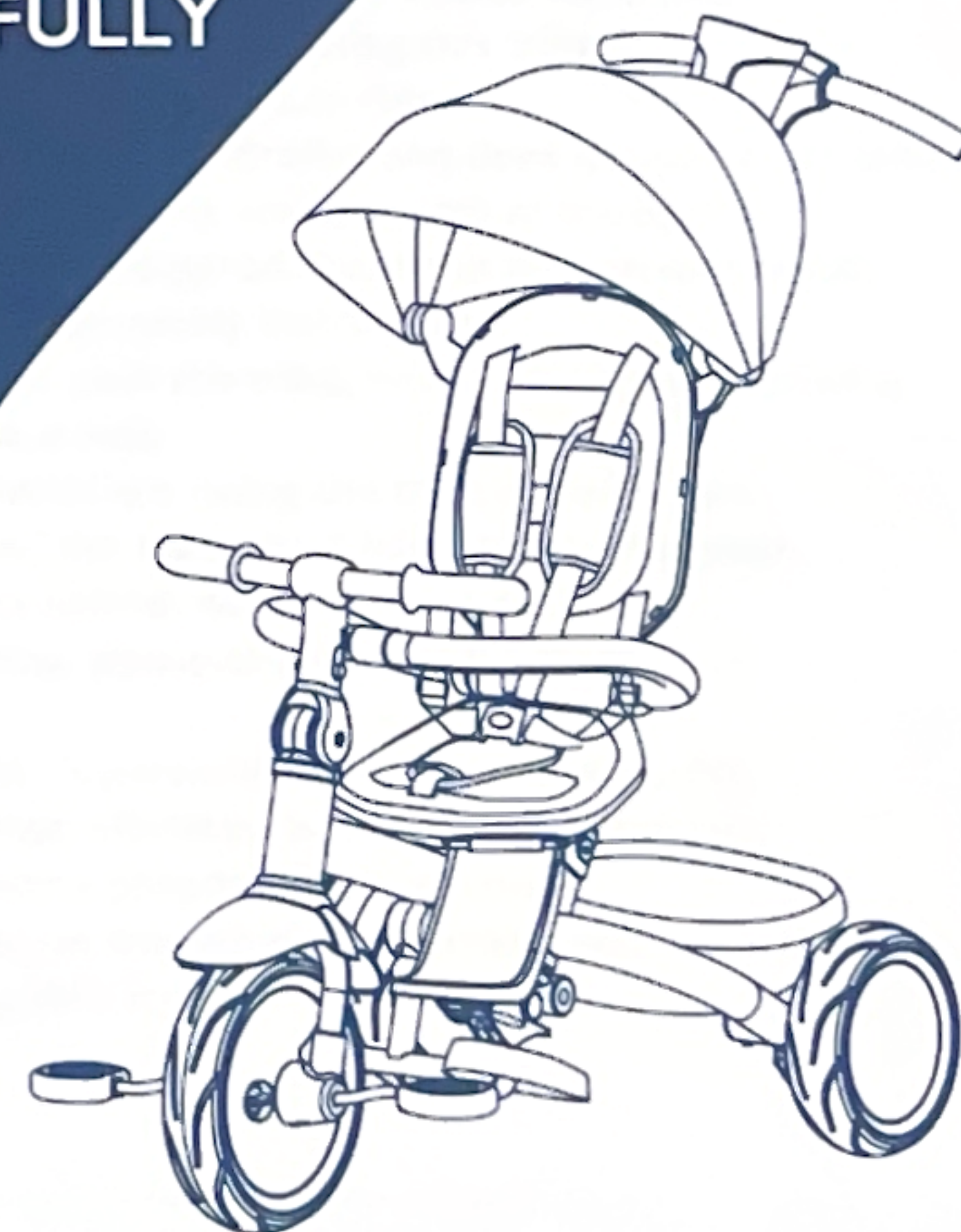



## **WARNINGS:**

Read these instructions carefully before assembly and use and keep for future reference. The child may be hurt if you do not follow these instructions.

**WARNING!** Adult assembly required. Choking hazard to children under the age of 3 years - contains small parts prior assembly.

**WARNING! TO AVOID SERIOUS INJURY:** Continuous adult supervision required.

**WARNING!** This trike is intended for one child from aged 10 months up to a maximum weight of 25kg or 6 years, whichever comes first.

**WARNING!** Before riding, please check that all fasteners are correctly secure.

**WARNING!** Never use near motor vehicles; never use near roads, swimming pools, hills, steps, or sloped driveways.

**WARNING!** Always wear shoes when using this tricycle.

**WARNING!** Never allow more than one rider.

**WARNING!** This product is not a stroller and does not meet the safety requirements for strollers. Do not use as means of transport.

**WARNING!** Adult assembly required. Read this manual completely and follow thoroughly the assembly instructions.

**WARNING!** When adults push the trike, ensure the child is wearing the properly adjusted seat belt.

**WARNING!** When children are riding the trike on their own, remove the push bar and the seat belt. Children should always wear an approved safety helmet when riding alone.

**WARNING!** Before riding, please check that all fasteners are correctly secured.

**WARNING!** For the child's personal safety, always use safety equipment such as helmet, elbow pads, knee pads and gloves.

**WARNING!** Always wear a properly fitted helmet.

**WARNING!** To be used on smooth paved terrains without any traffic. Not for use on public roads.



## ⚠ WARNINGS:

WARNING! Replace worn or broken parts immediately.  
 WARNING! Not to be used at dusk, at night, or at times of limited visibility and unfit weather.  
 WARNING! The toy should be used with caution since skill is required to avoid falls or collisions causing injury to the user or third parties.

## Parts List:

1 	2 	3 	4 
5 	6 	7 	8 
9 	10 	11 	12 
13a 	13b 	14 	15 
16 	17 	18 	



## Assembly:

### Step One



### Step Two

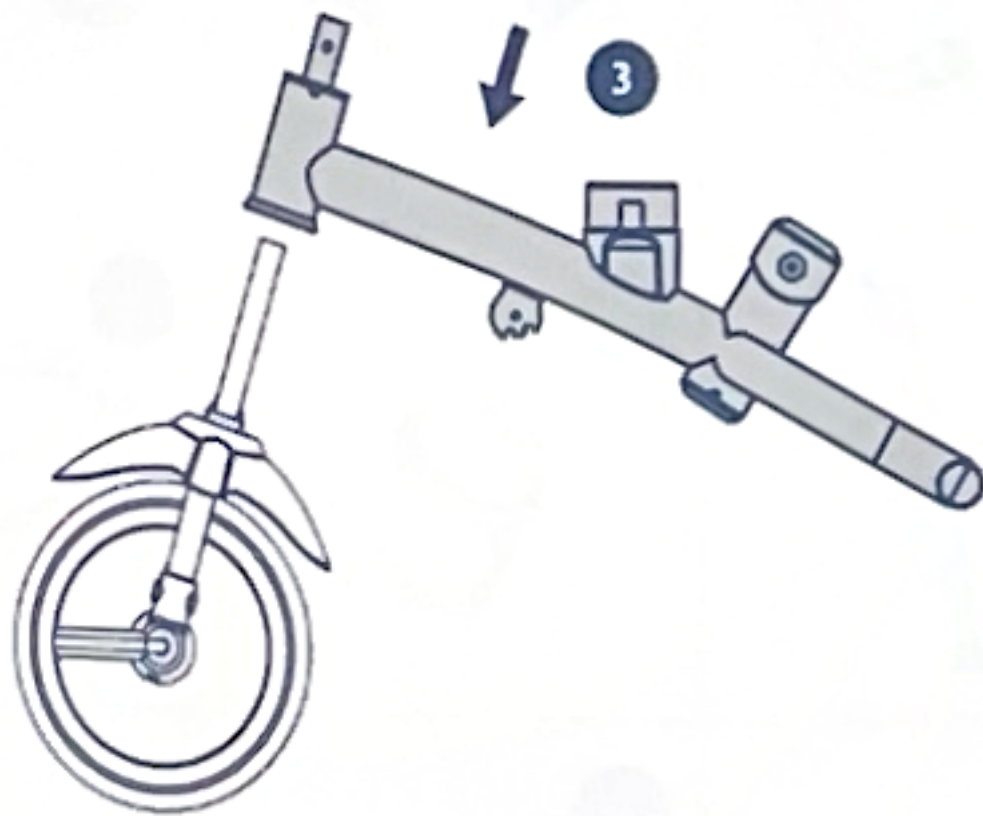

## Assembly:

### Step Three

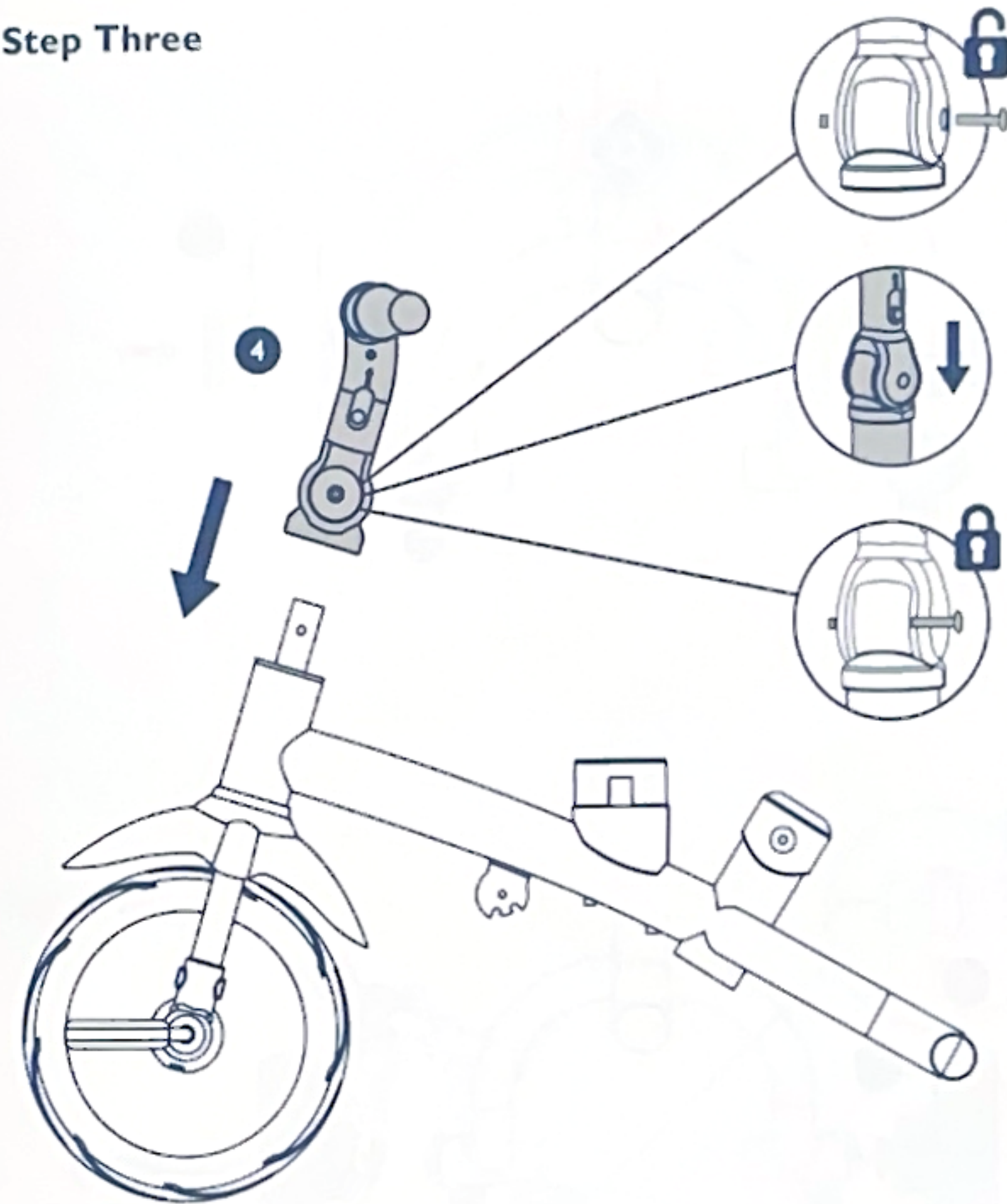



## Assembly:

### Step Four

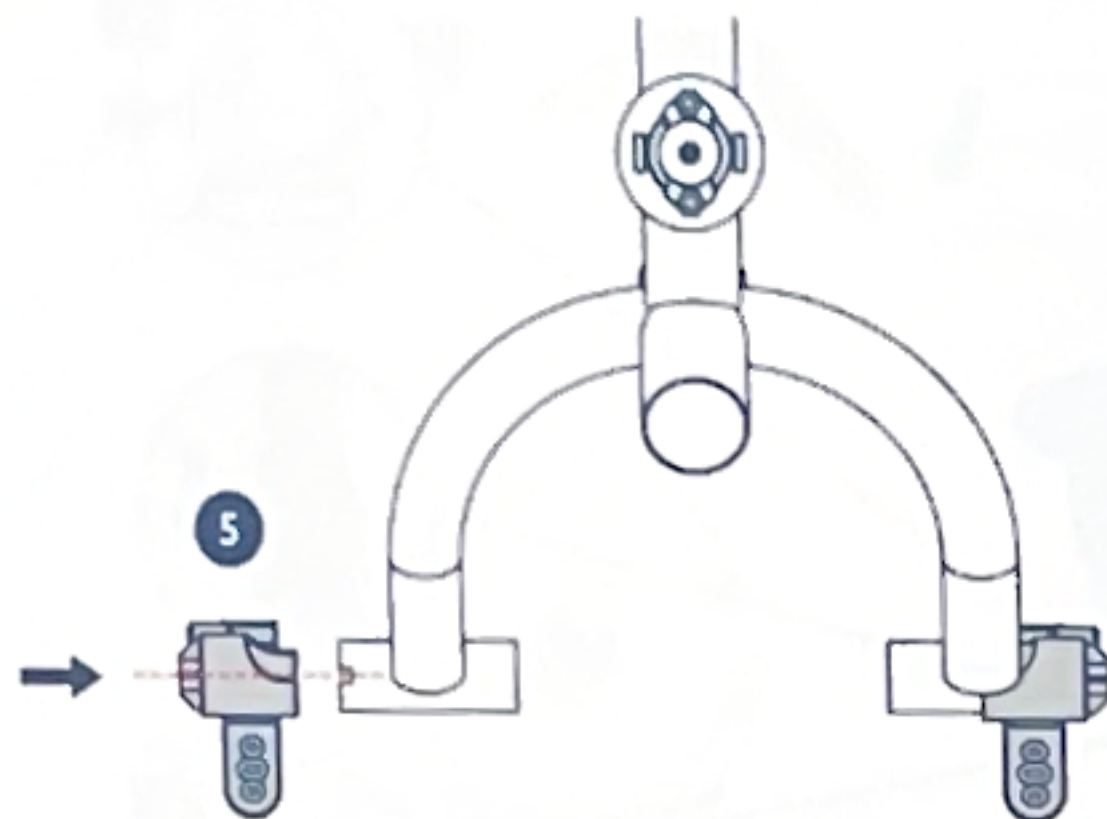

### Step Five

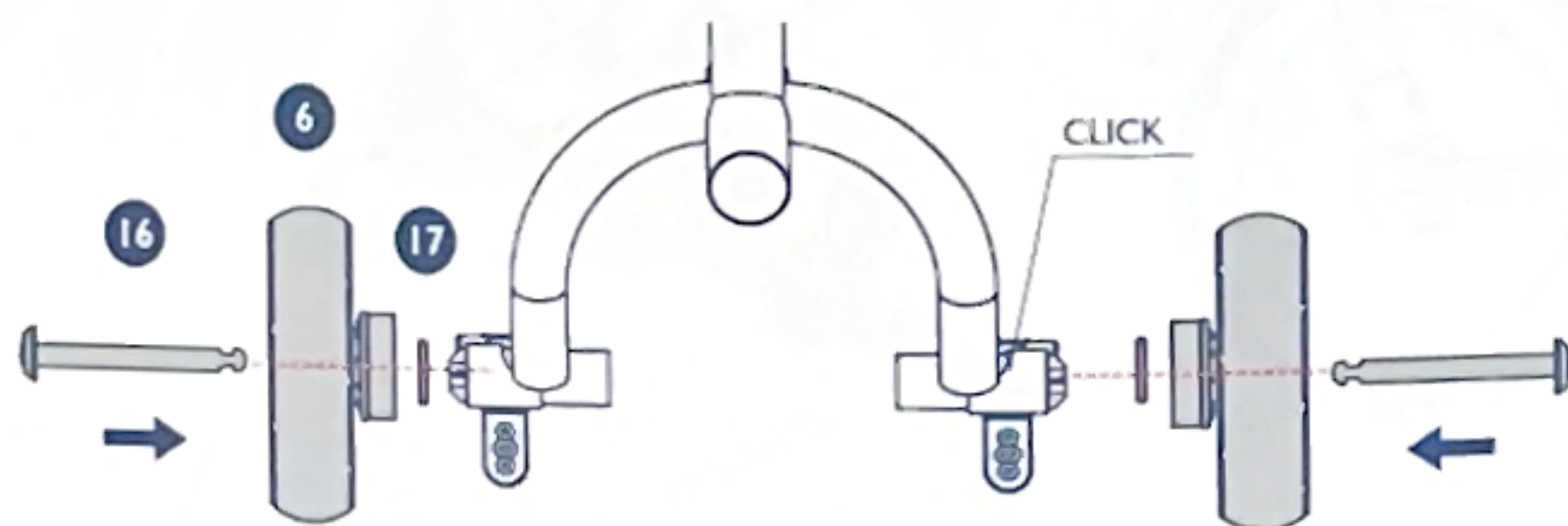

## Assembly:

### Step Six

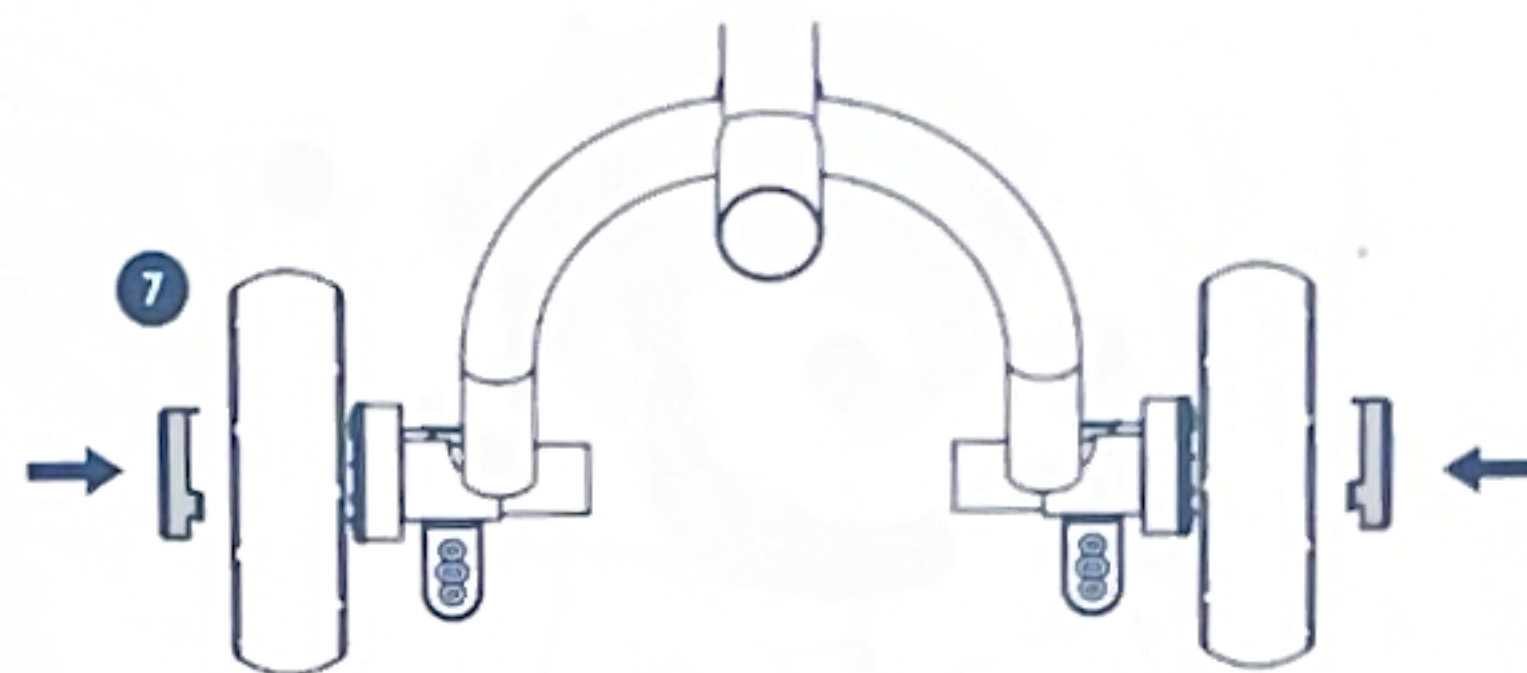

### Step Seven

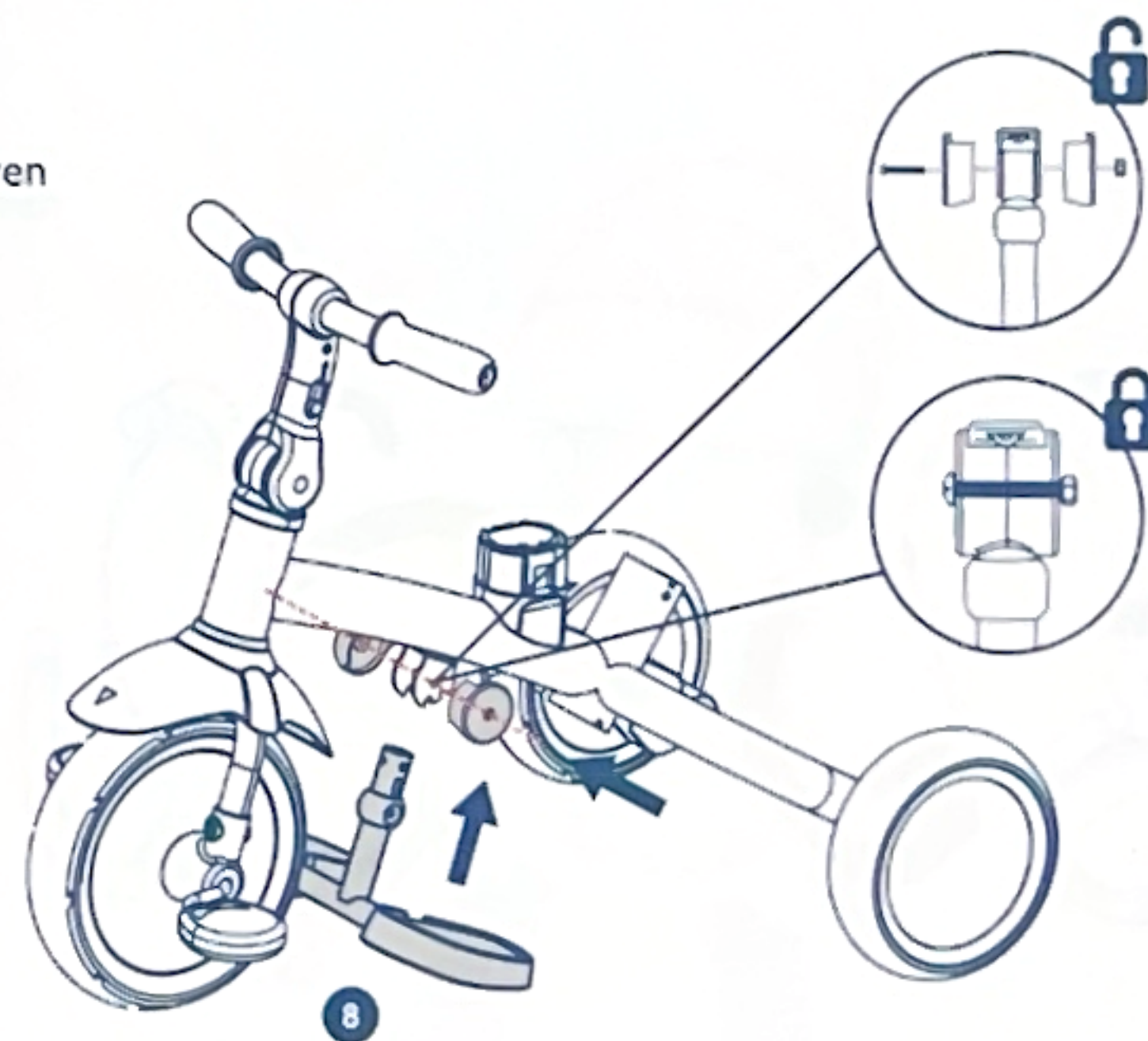



## Assembly:

### Step Eight

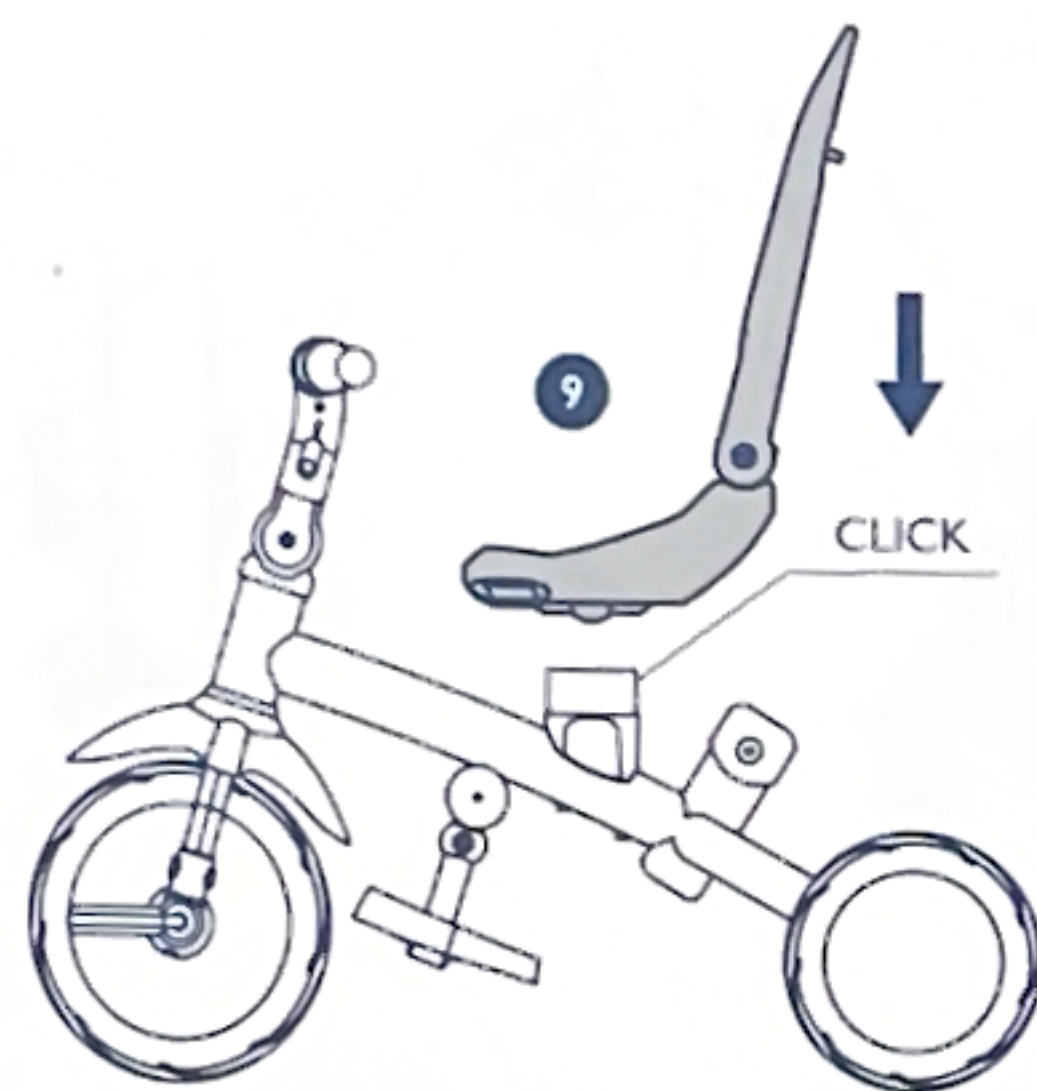

### Step Nine

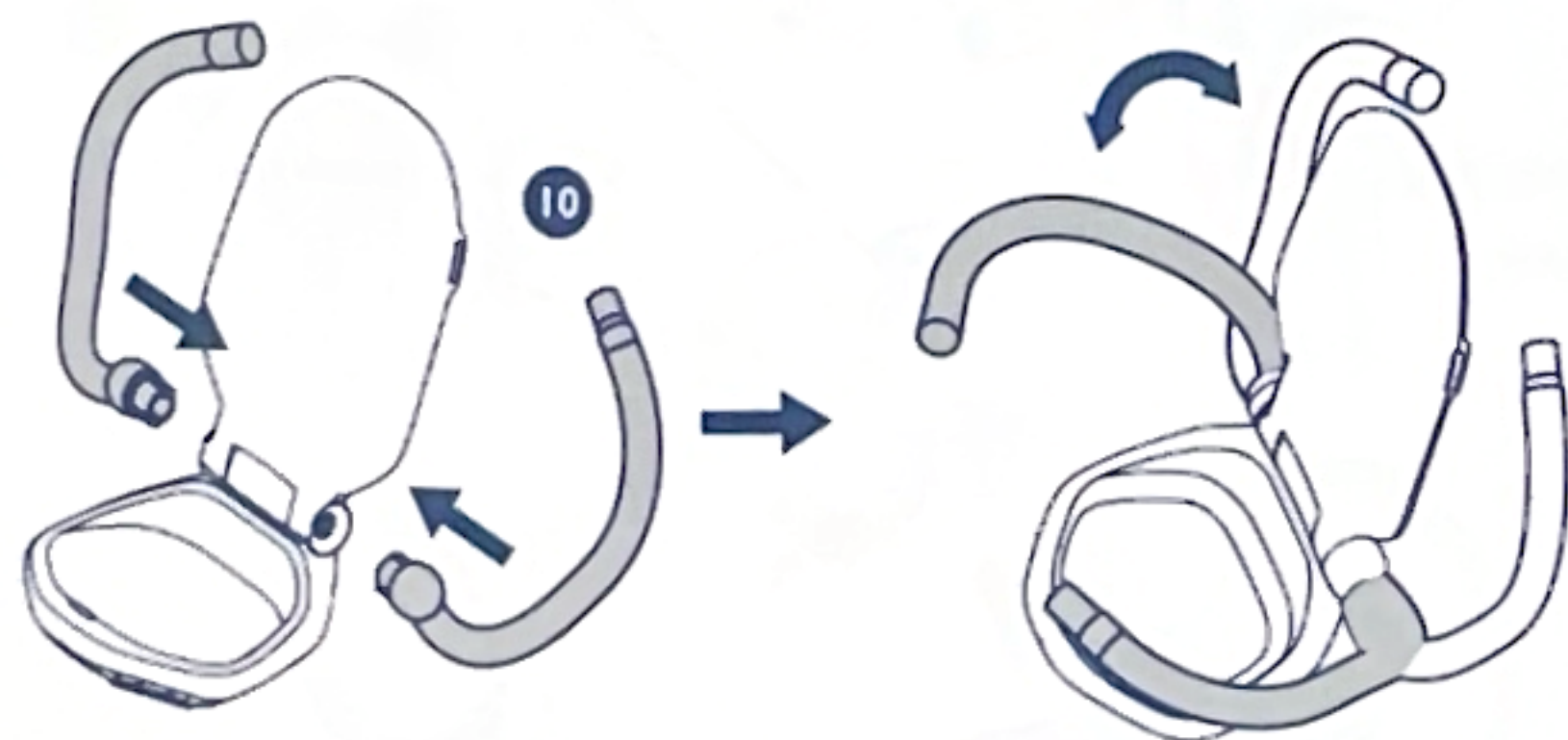

## Assembly:

### Step Ten

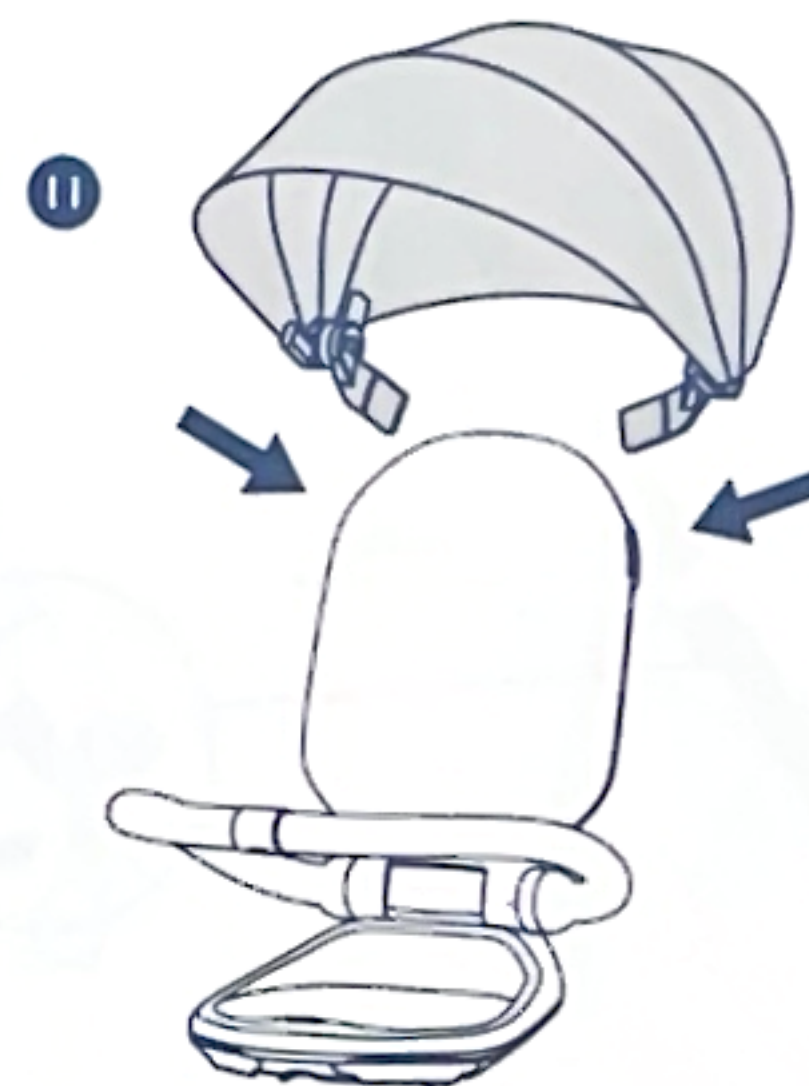

### Step Eleven





## Assembly:

### Step Twelve



### Step Thirteen

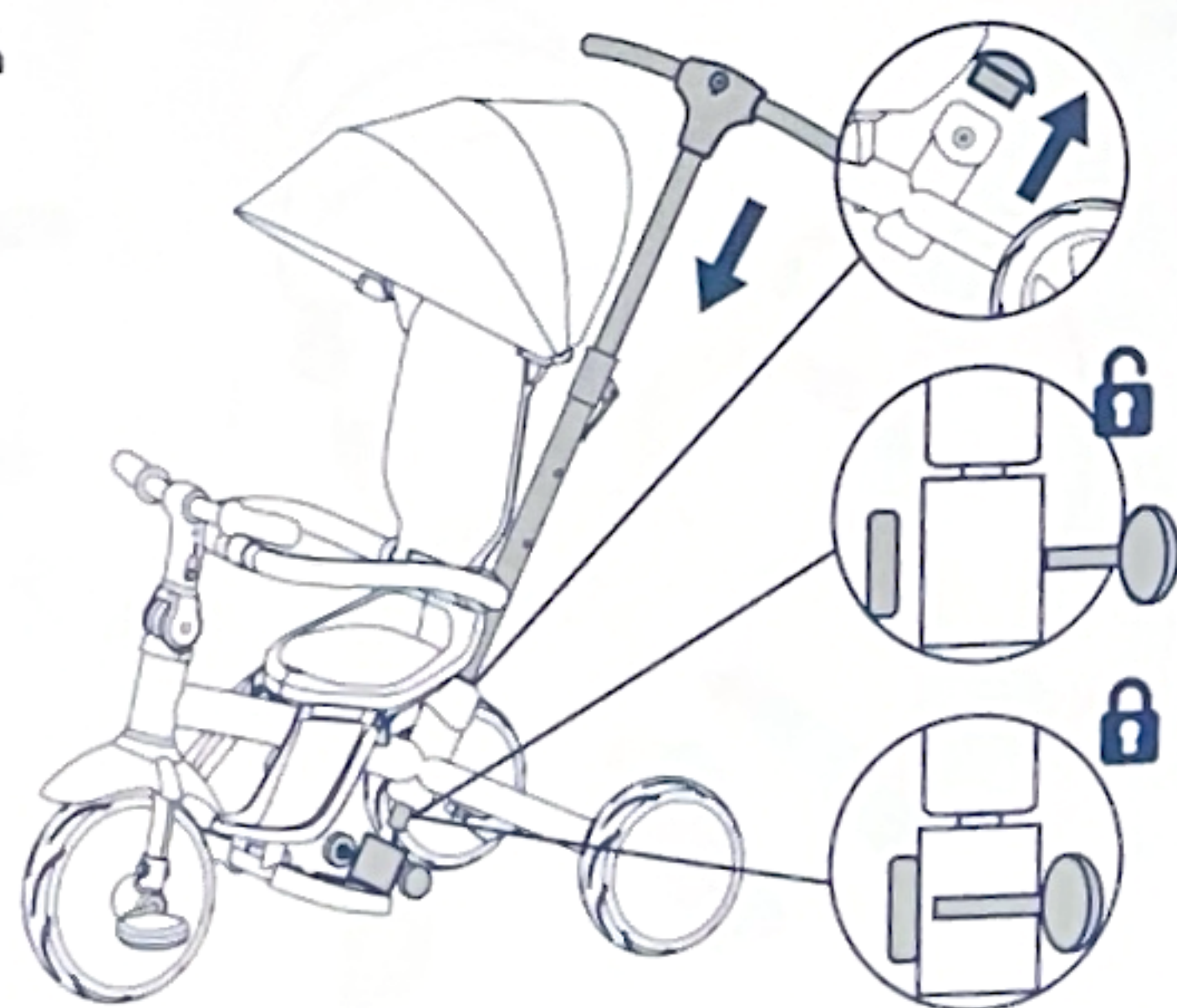

## Assembly:

### Step Fourteen

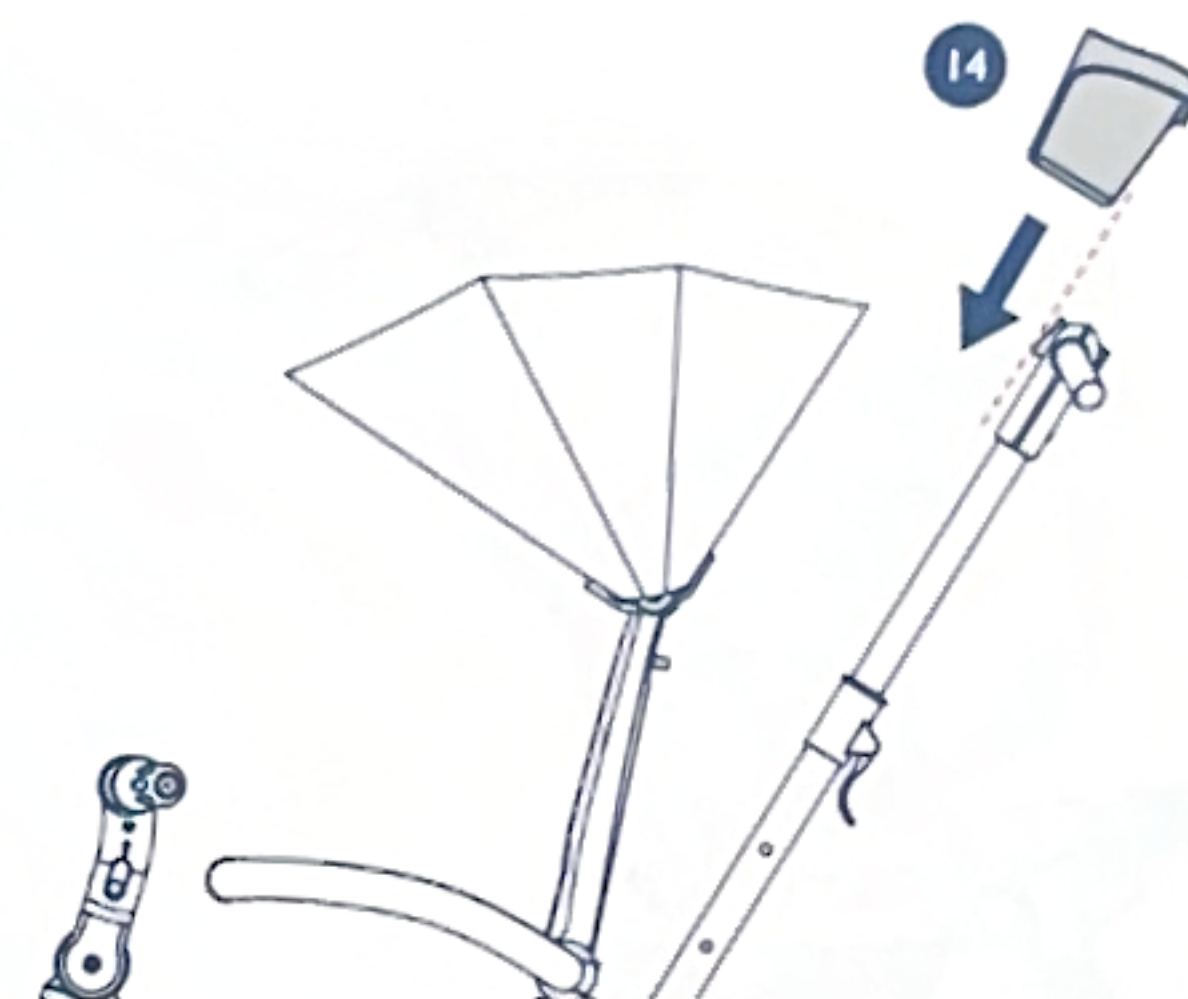

### Step Fifteen

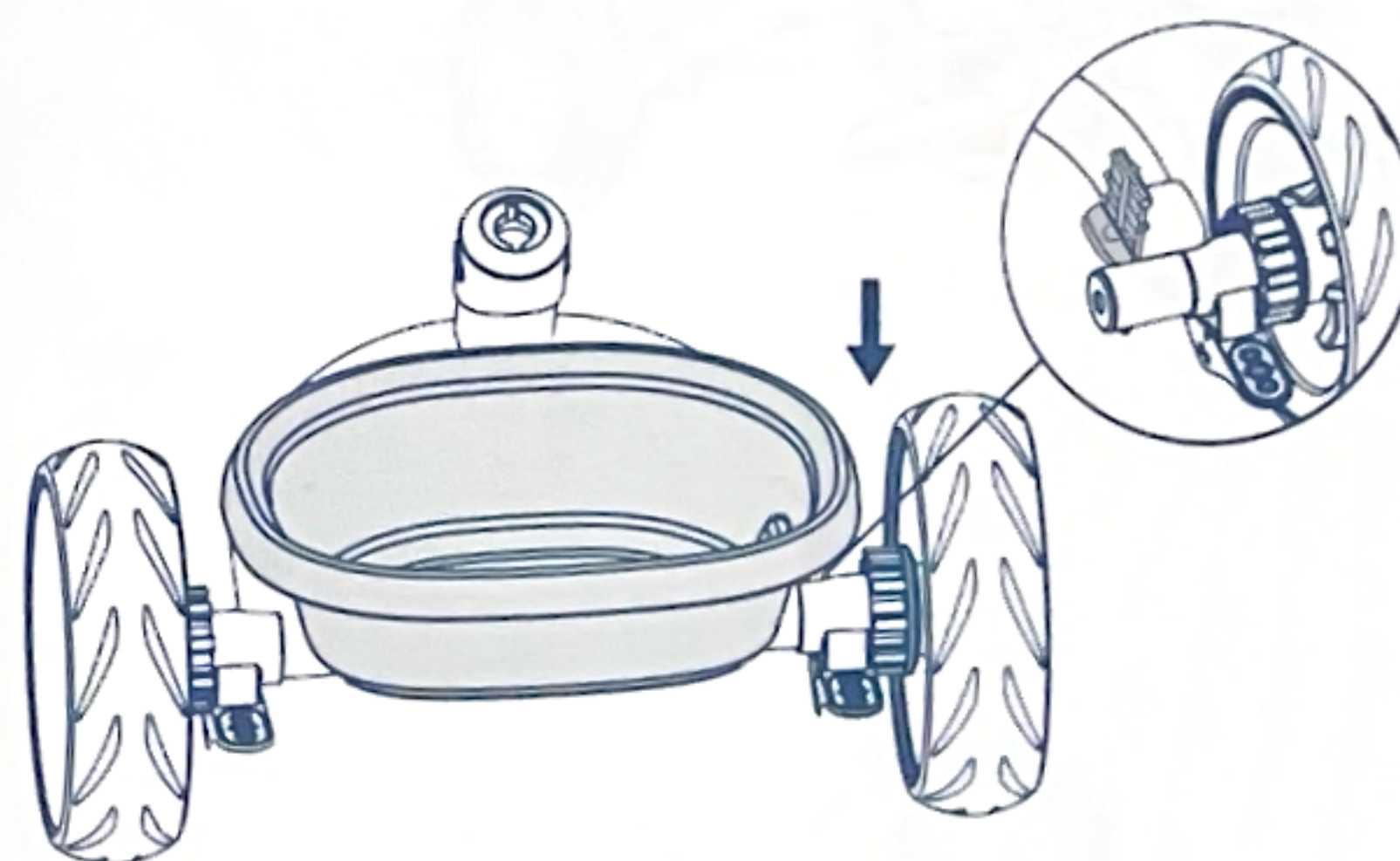



## Assembly:

---

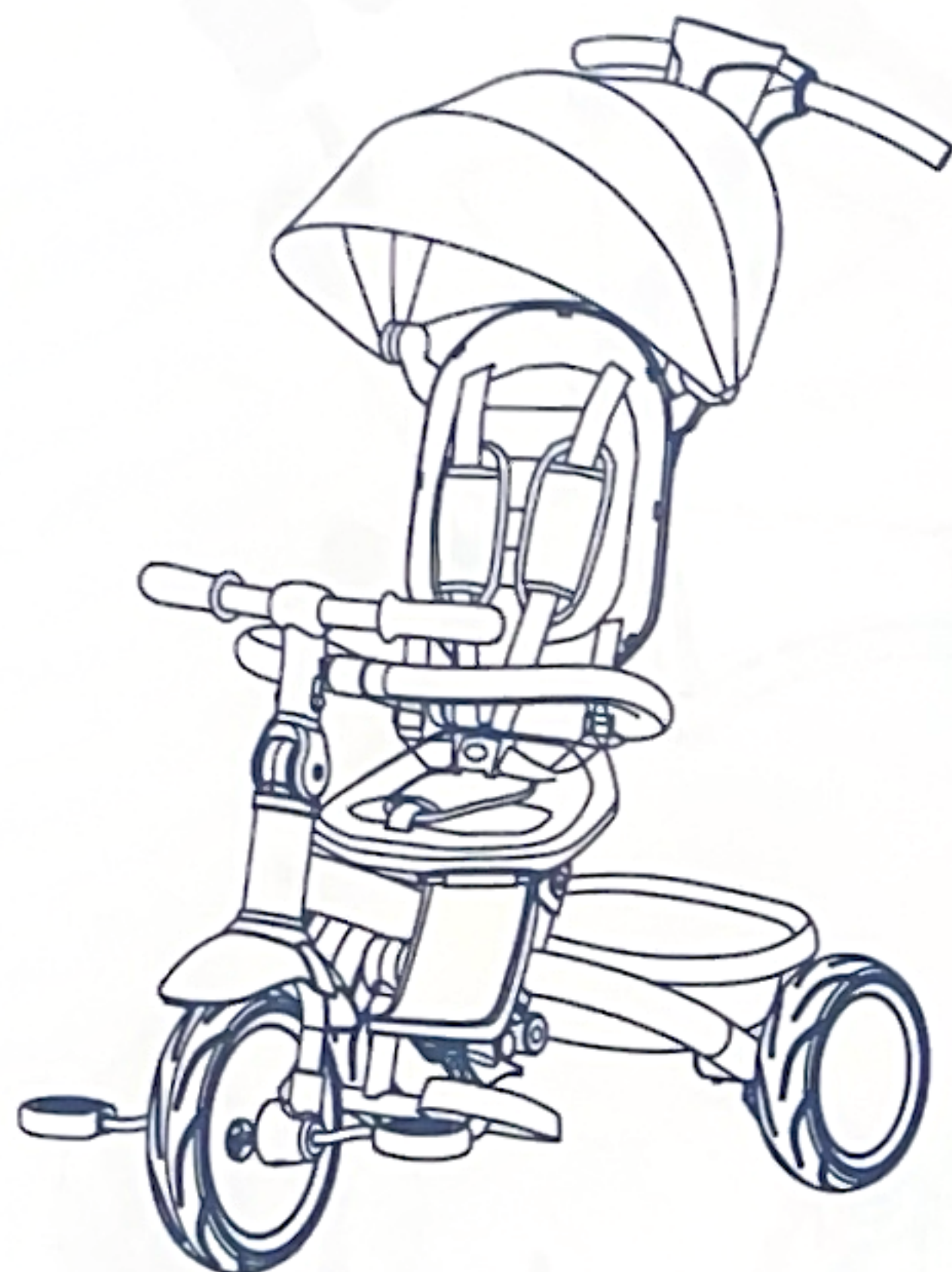

## Locking / Unlocking Wheel Pedals

---

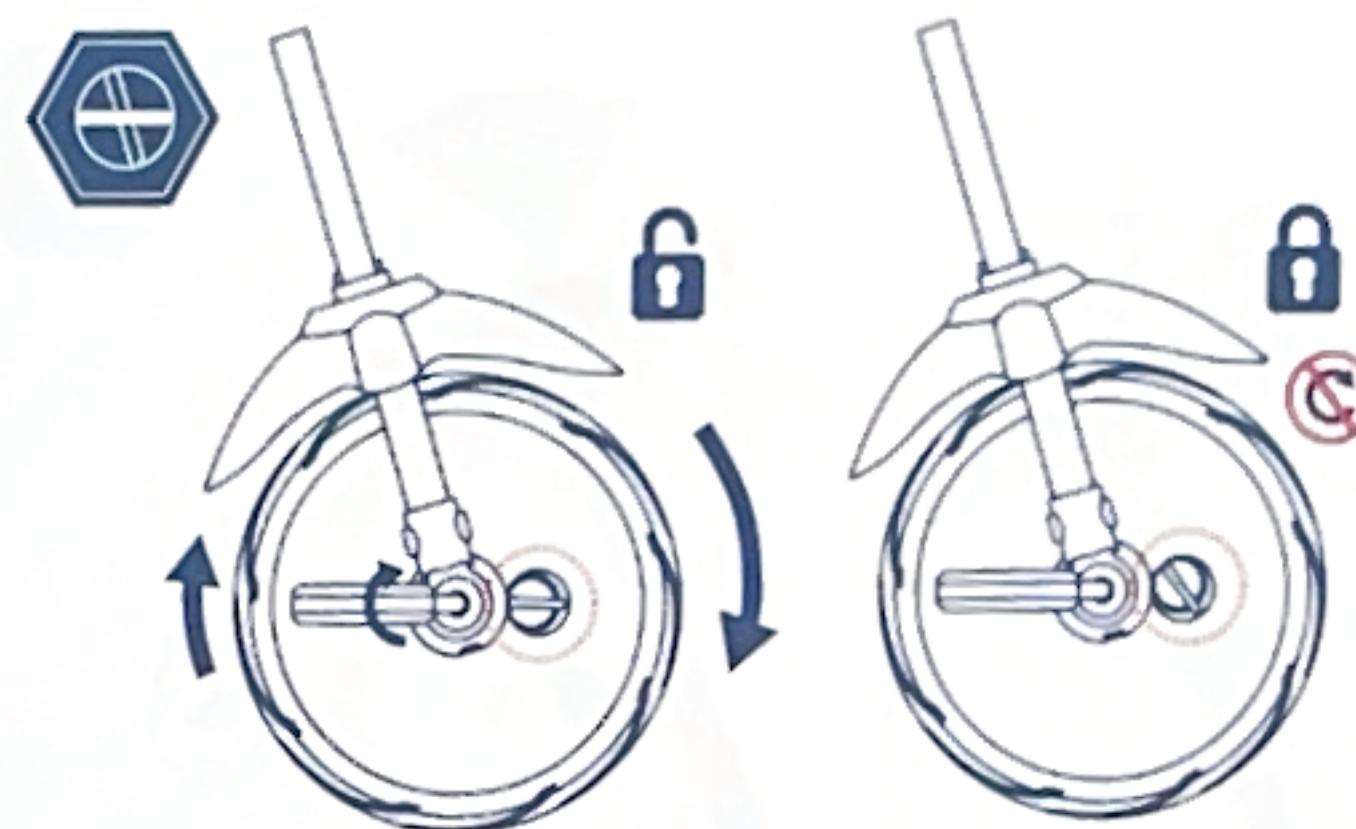

## Folding Footrest

---

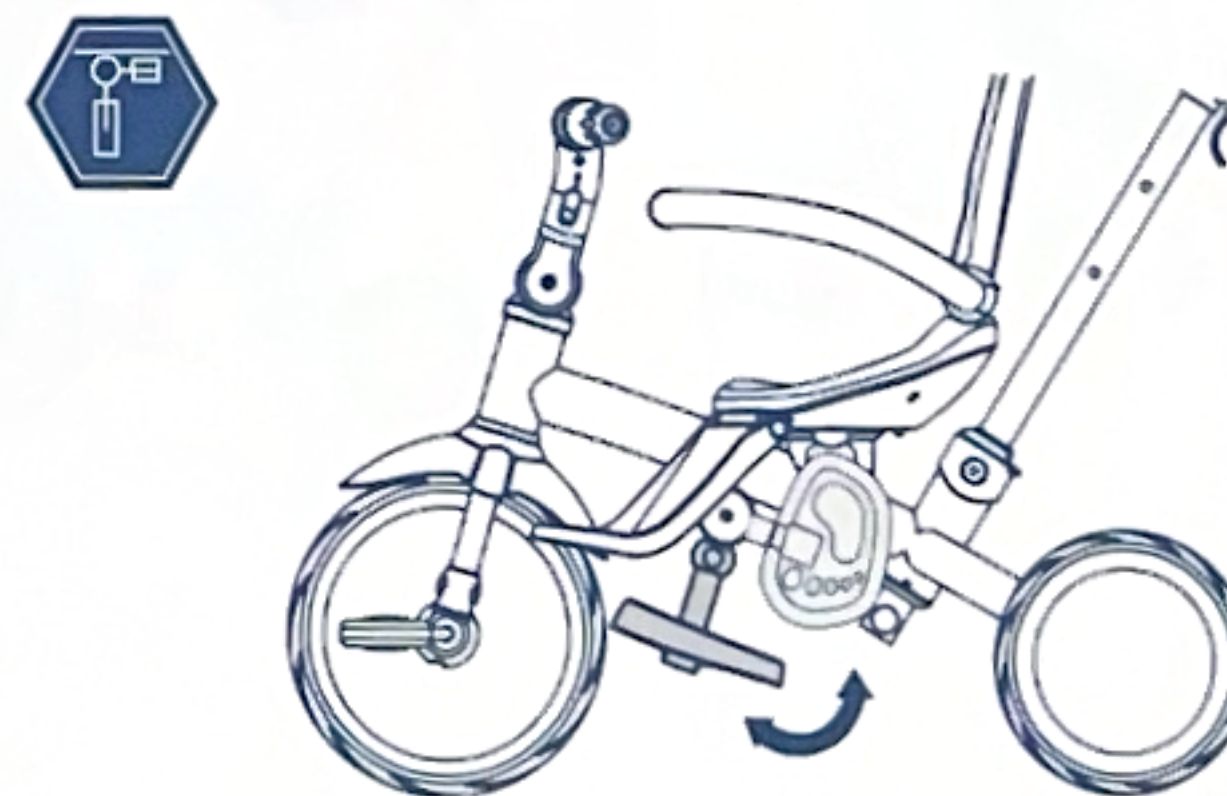



## Adjusting the pushalong bar



## Adjusting the Seat Unit

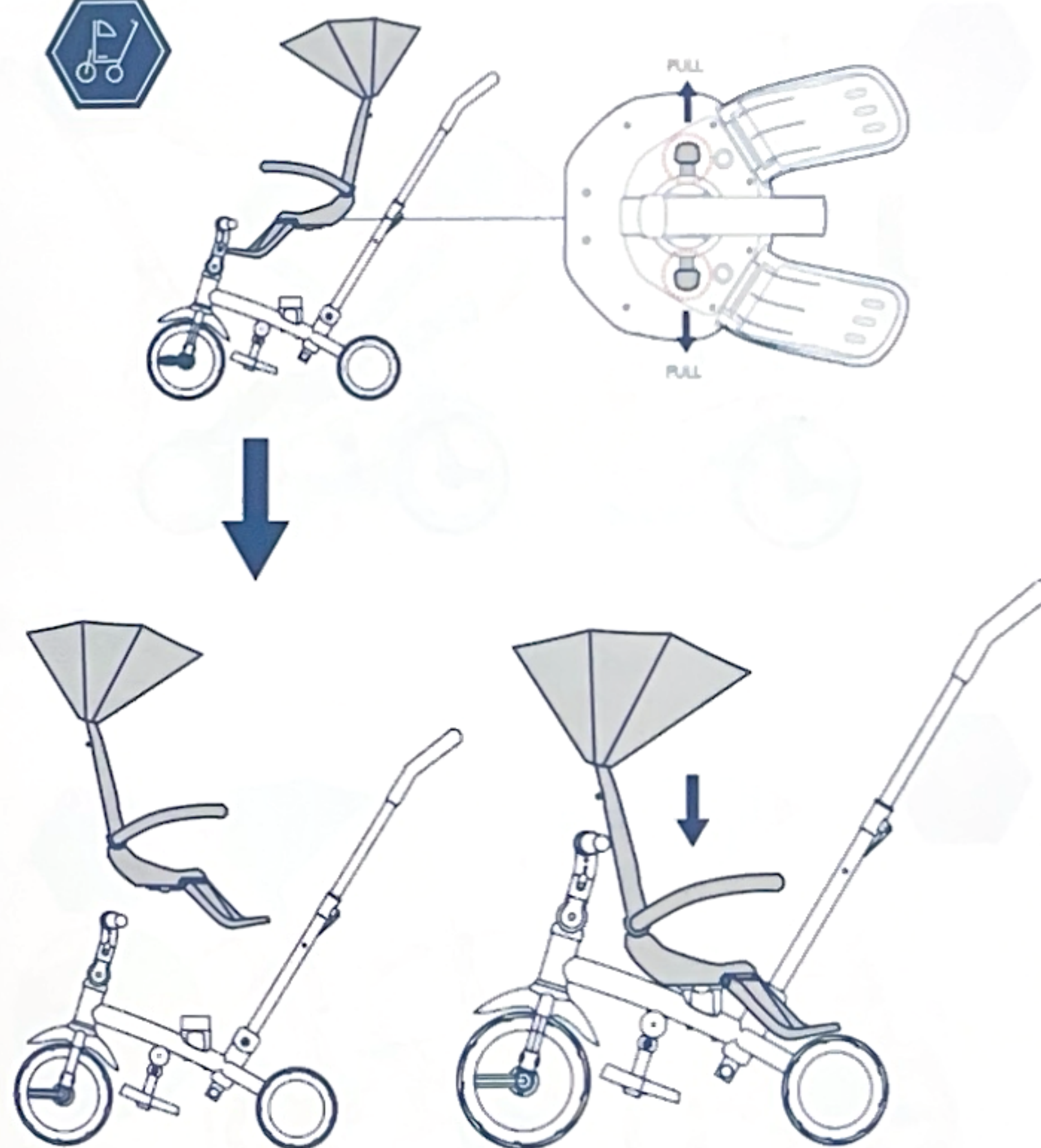



## Adjusting the Seat Unit

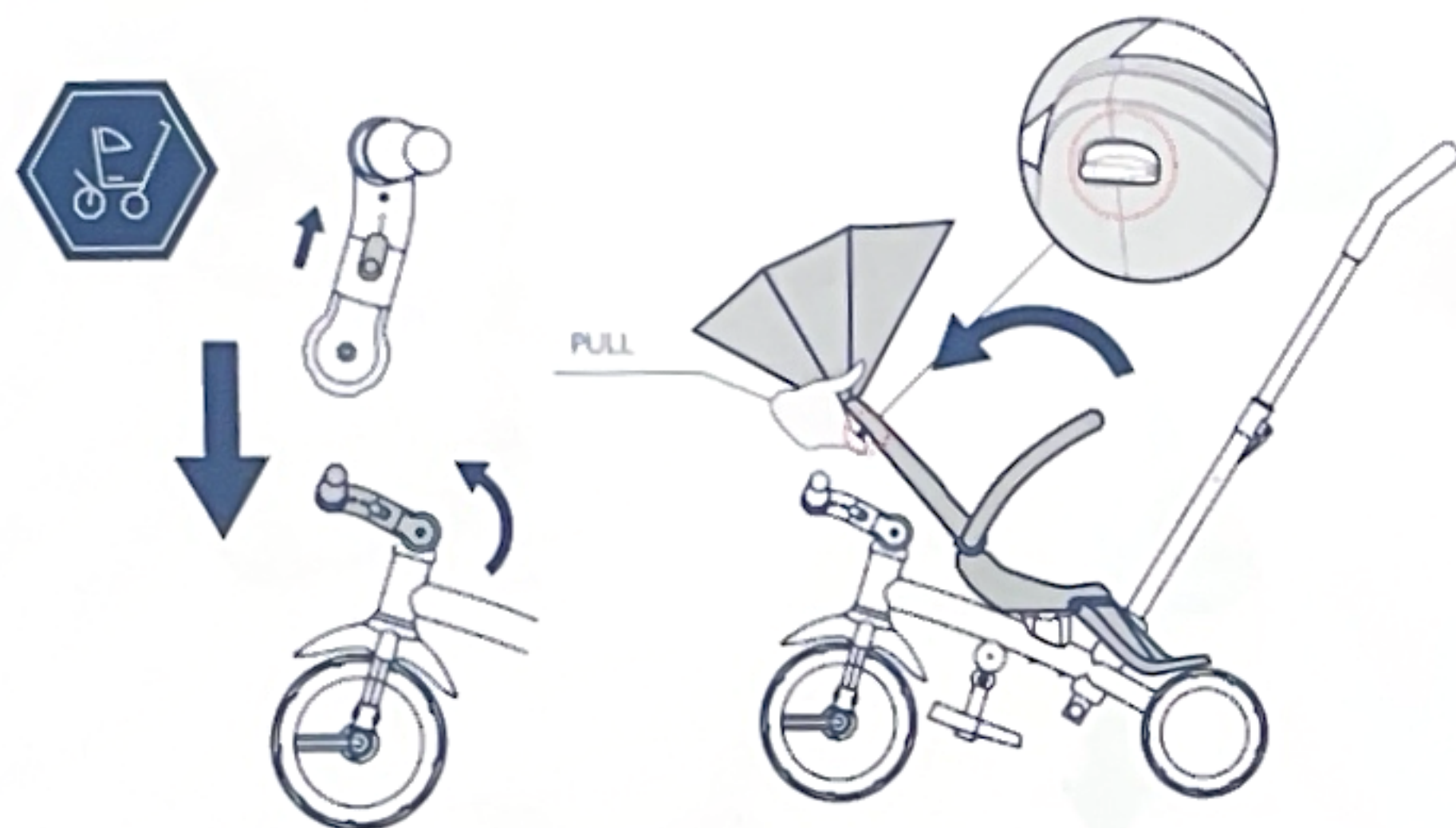

## Adjusting the Canopy

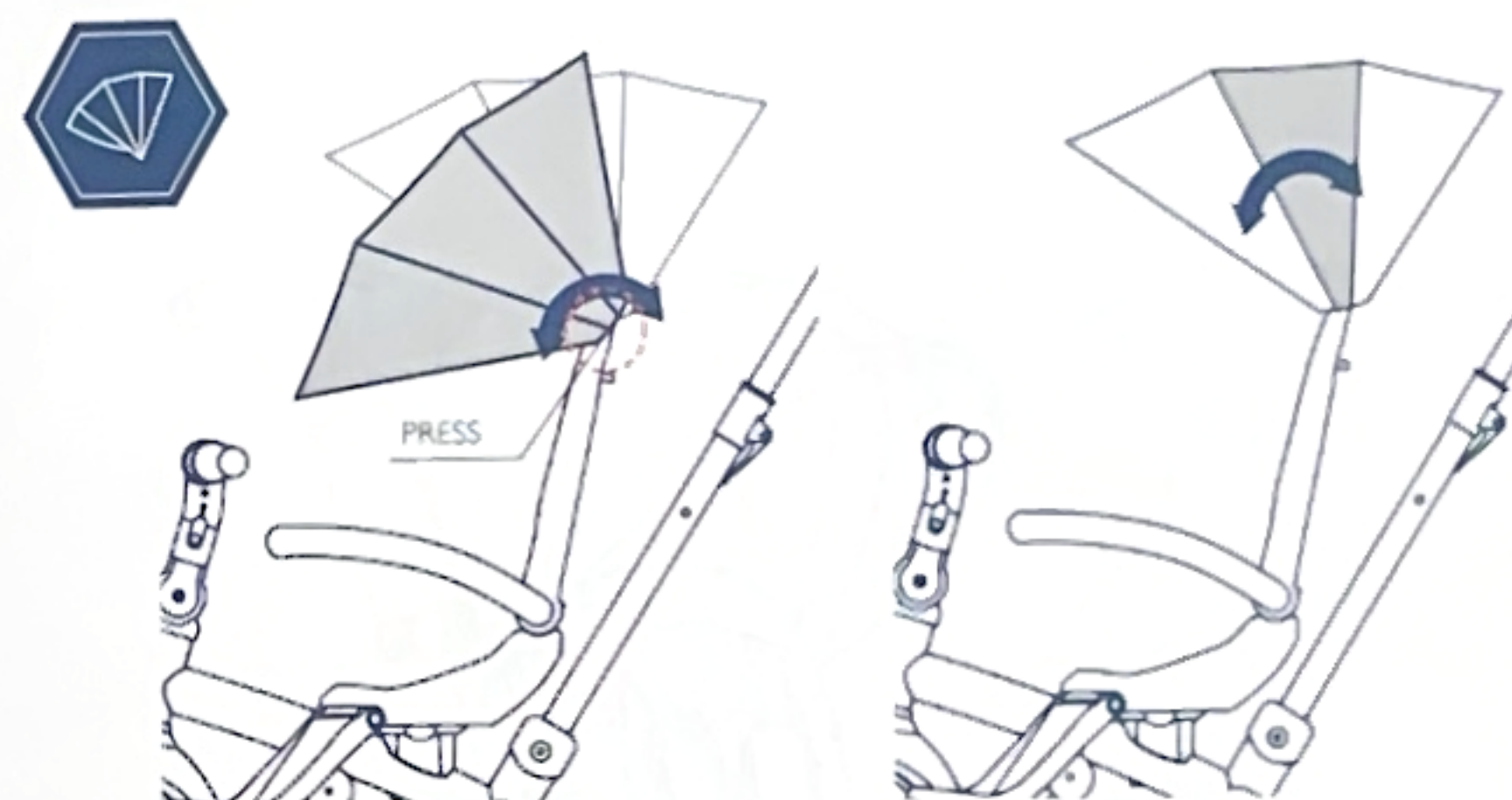

## Brakes

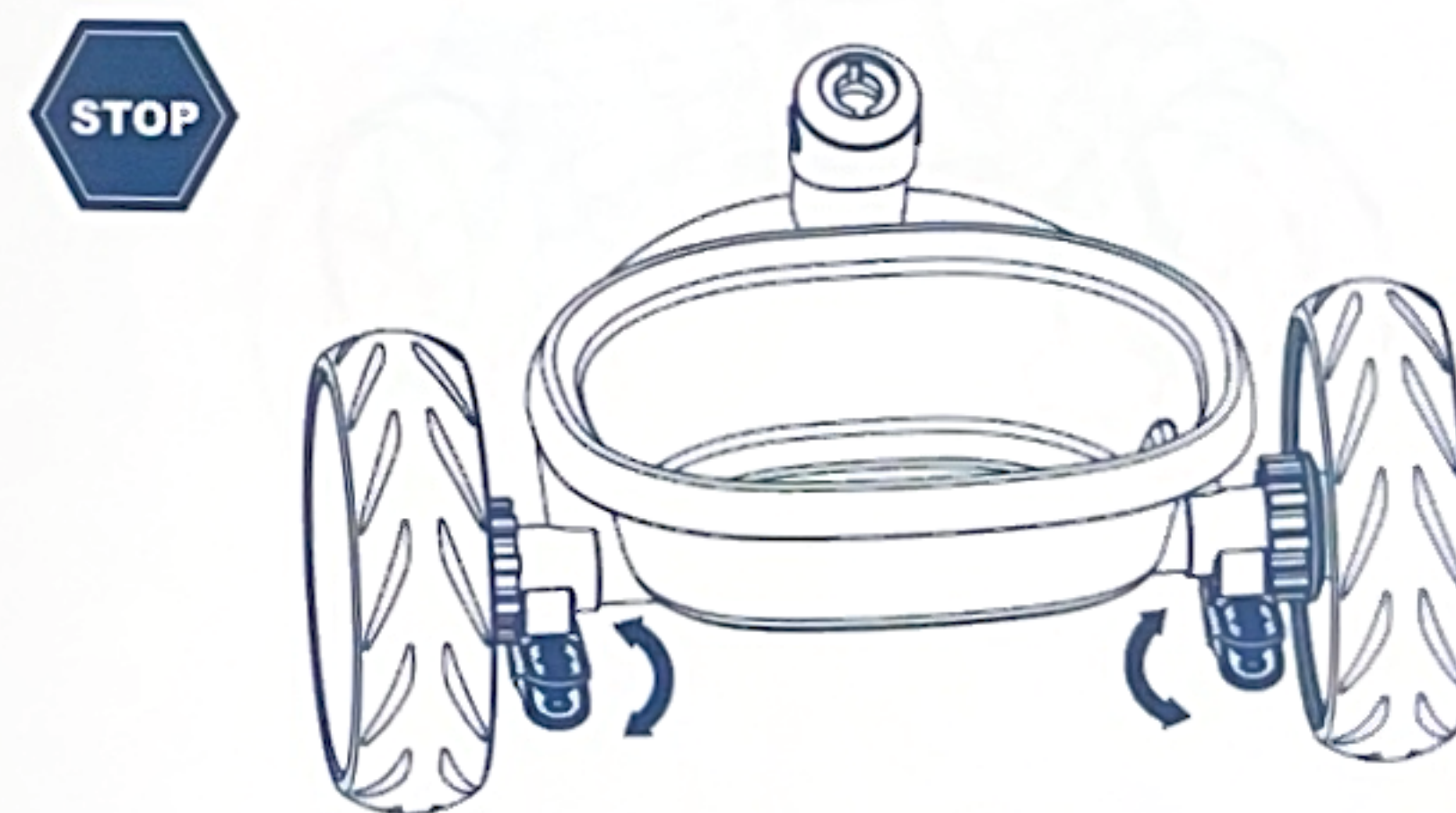



Mode from 10 months:

---

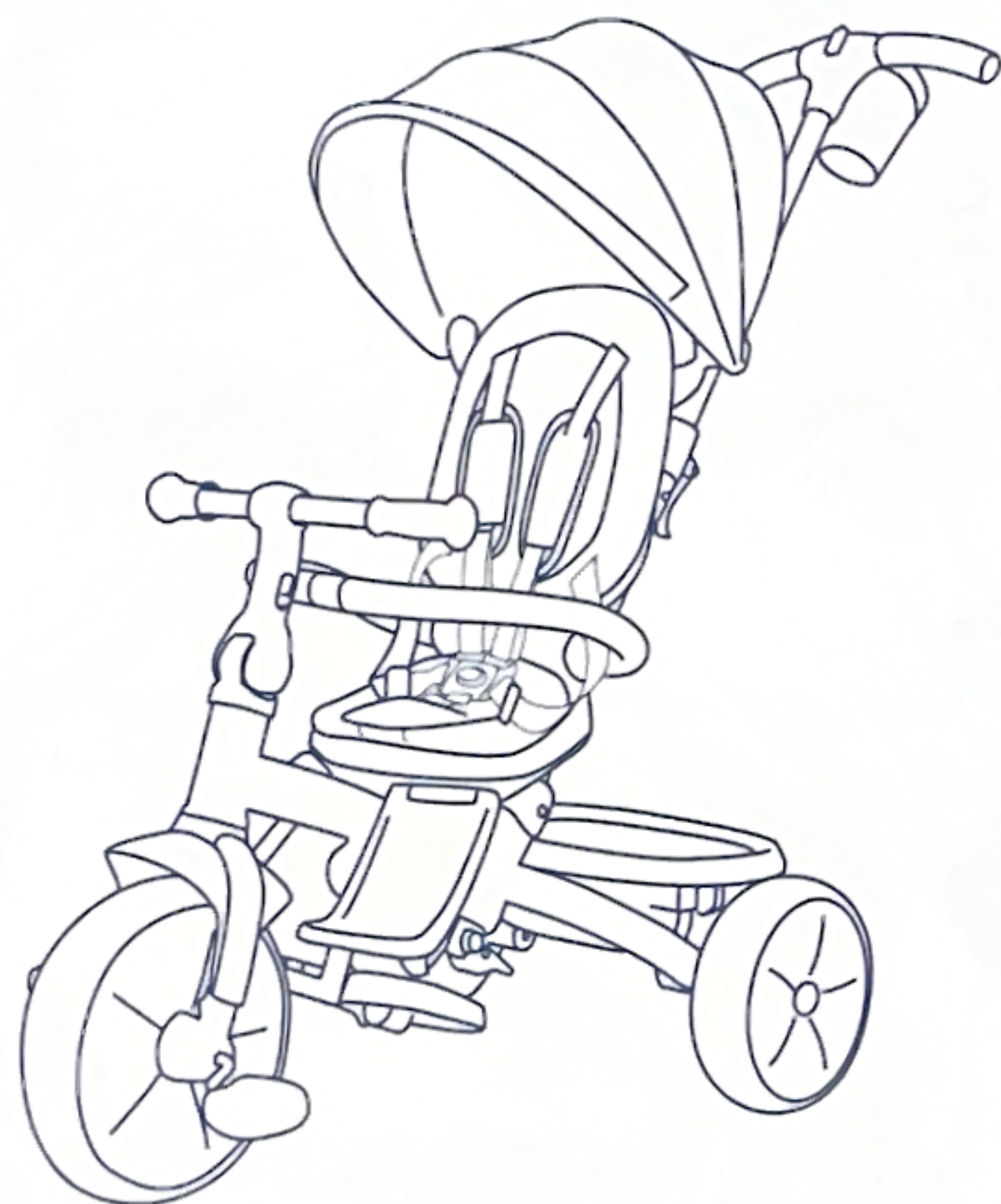

Mode from 10 months:

---

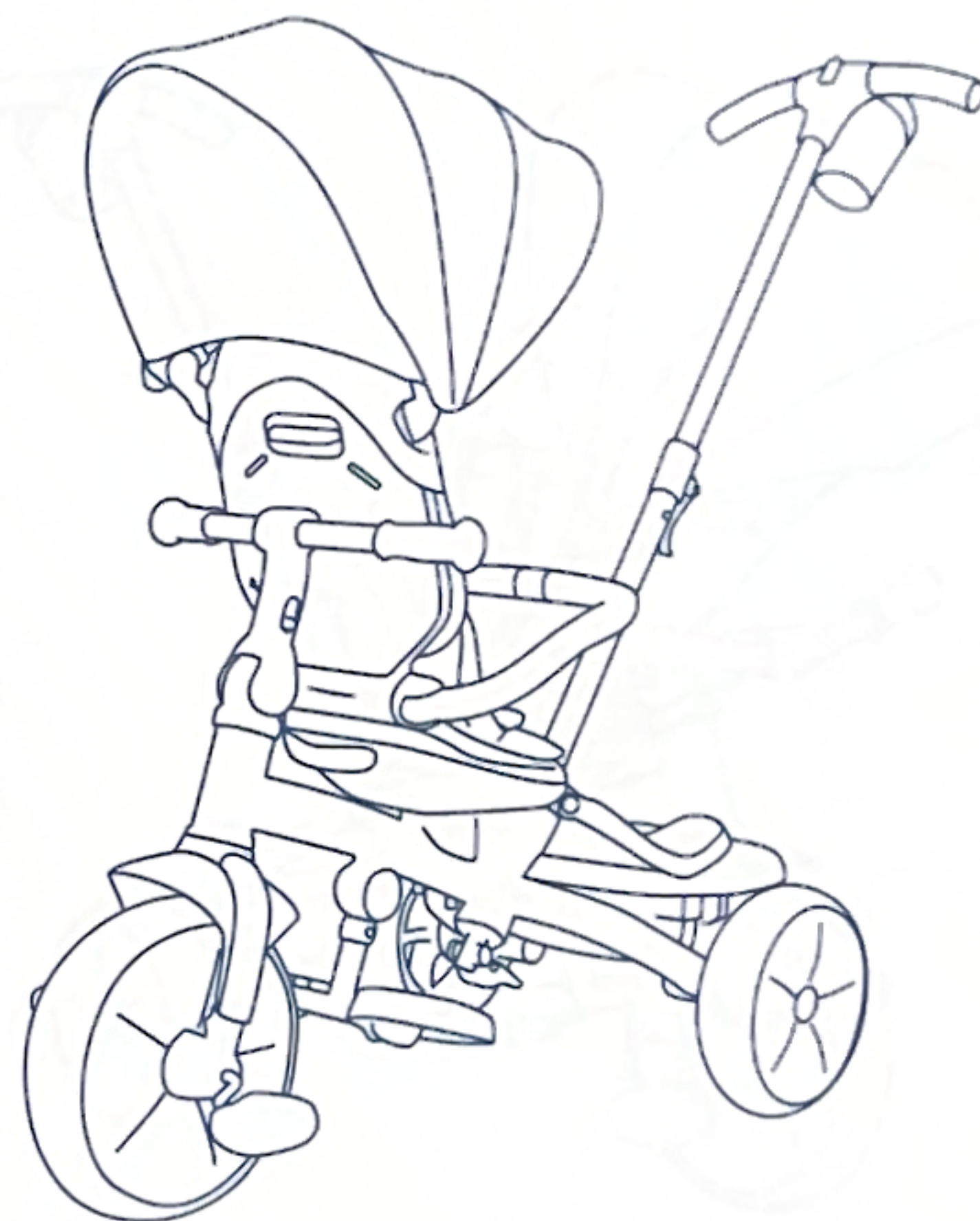



Mode from 10 months:

---



Mode from 18 months:

---

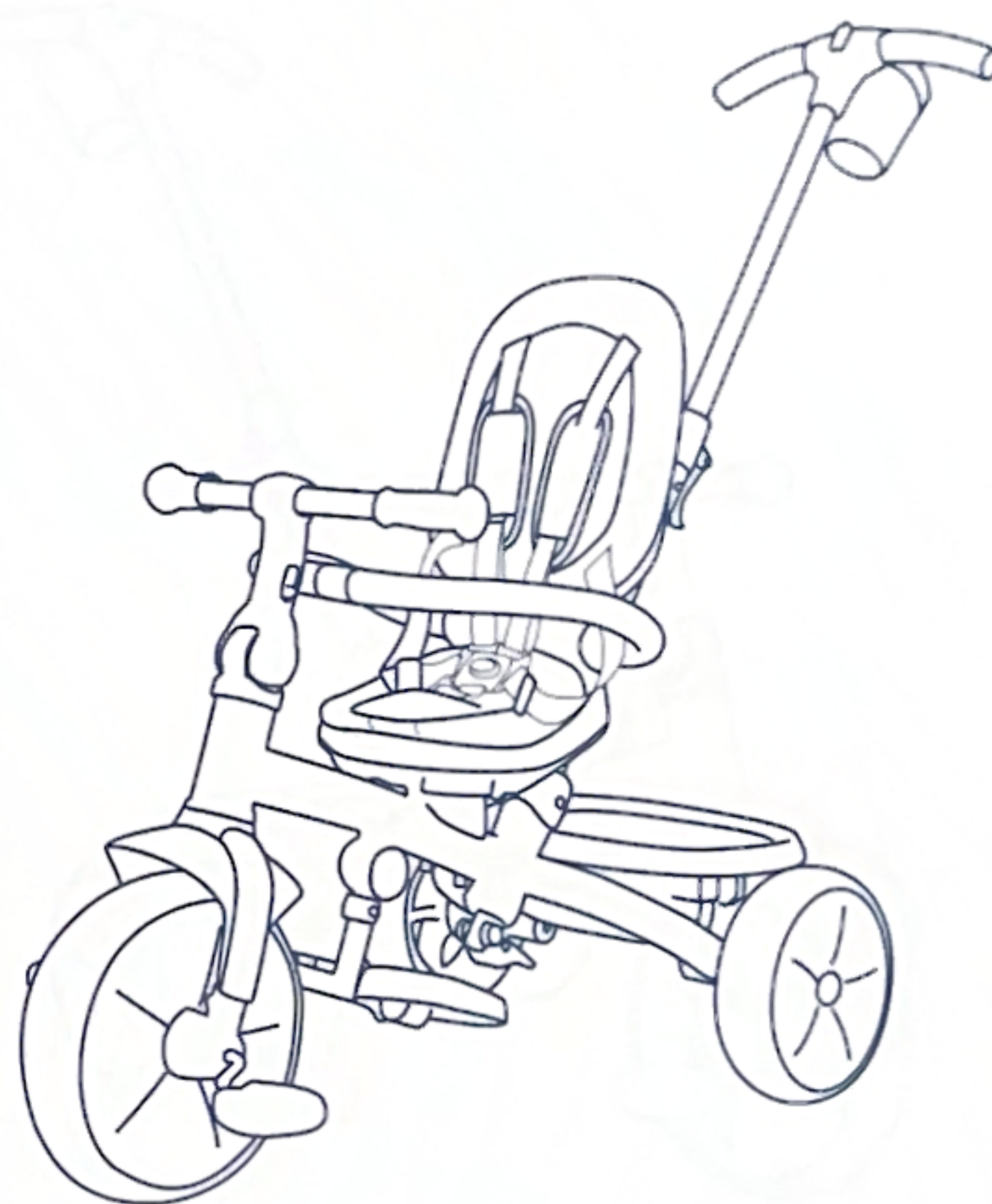



Mode from 24 months: 18 months

---



Mode from 36 months: 36 months

---

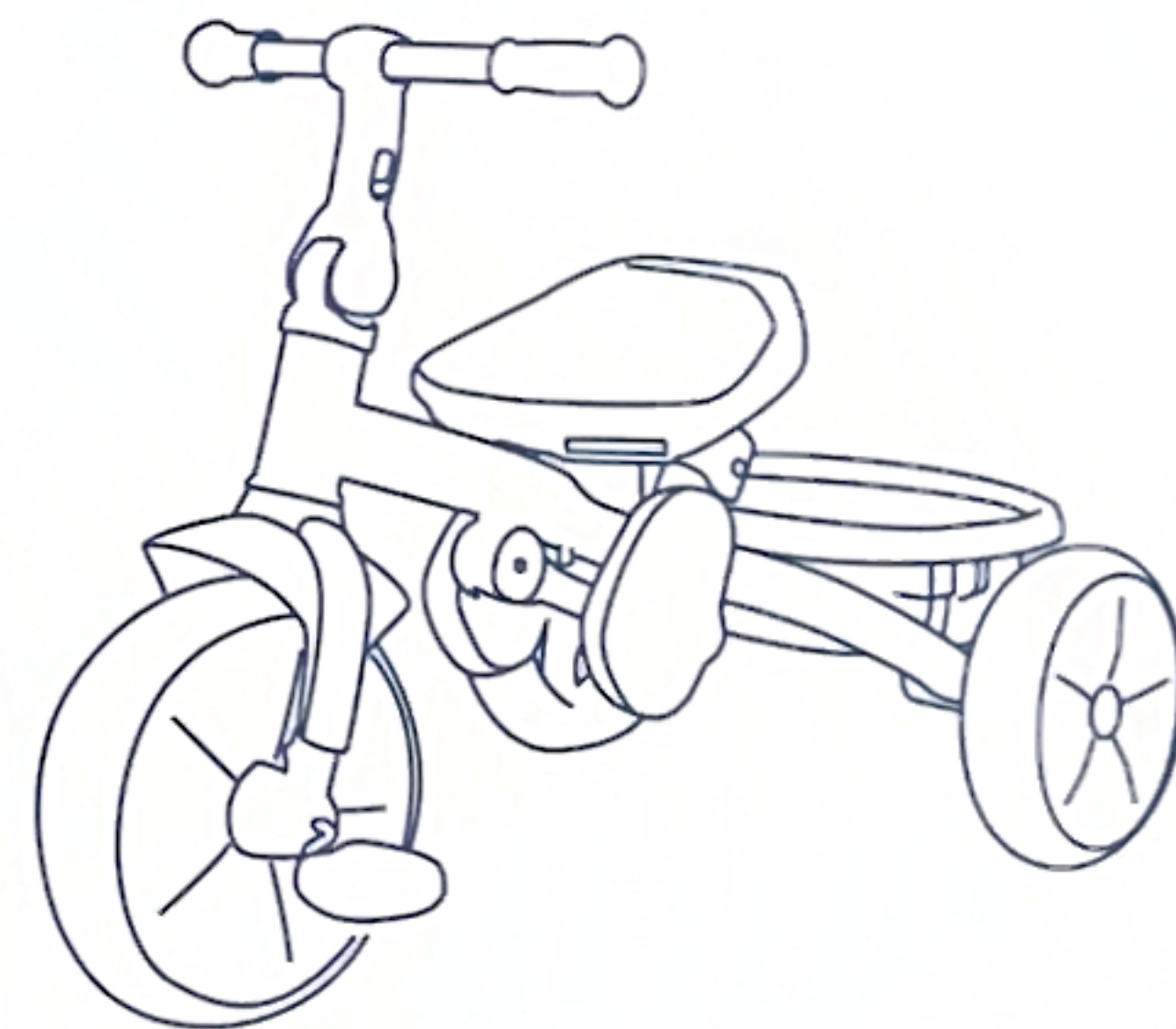



## Care and Maintenance

---

- Wipe metals and plastics with a damp cloth.
- Do not wash fabrics. Spot clean only using soft sponge with diluted detergent or water.
- Dry in the shade.
- Do not bleach.
- Do not iron.
- Do not dry clean.





**Customer Service:**

[reachout@euroactiveproducts.com](mailto:reachout@euroactiveproducts.com)

**Due to variation in style and design the illustrations used in this instruction manual are generic.  
Variation in design may occur in the images shown.**

**Supplied by Euroactive HK. Ltd.**

79/ 80 Furze Road, Sandyford Business Estate, Dublin 18, Ireland  
International House, 12 Constance Street, London, E16 2DQ, United Kingdom  
A3/ 3FI, West Wing TST Centre, 66 Mody Road, TST East, Kowloon, Hong Kong

