

nested

Nordic

Nursing Chair & Footstool

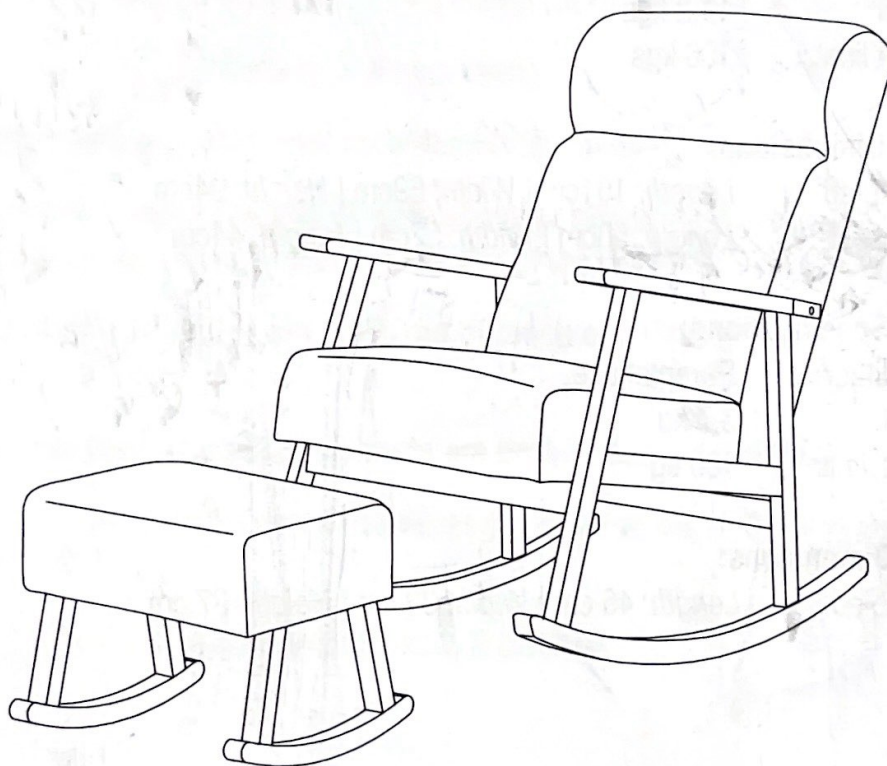

**IMPORTANT: RETAIN FOR FUTURE REFERENCE,
READ CAREFULLY**

Introduction:

Congratulations on your purchase of the Nested Nordic Nursing Chair & Footstool.

This product has been designed and developed with safety, comfort and functionality in mind. Please take the time to read this manual carefully before using this product and keep it in a safe place for future reference.

The Nested Nordic Nursing Chair & Footstool is the perfect place to relax and rest your feet when nursing or soothing your baby. The chair features a rocking base which is quick and easy to assemble and the comfortable plush fabric looks good in any nursery.

Chair Specifications:

Age suitability: Parental use
Weight: 14.2 kgs
Weight limit: 100 kgs

Chair Dimensions:

Assembled: *Length: 101cm | Width: 69cm | Height: 94cm*
Inside seat: *Length: 50cm | Width: 52cm | Height: 44cm*

Stool Specifications:

Age suitability: Parental use
Weight: 3.7 kg
Weight limit: 100 kg

Stool Dimensions:

Assembled: *Length: 46 cm | Width: 33 cm | Height: 37 cm*

Safety Precautions:

Read all instructions before assembly and use of the Chair and Footstool.
Keep instructions for future use.

WARNING:

- Adult assembly required.
- Due to the presence of small parts during assembly, keep out of the reach of children until assembly is complete.
- Do not sit on the edge of the seat, armrests or on the backrest as this could cause the chair to tip over.
- Do not sit on the edge of the stool as this could cause the stool to tip over.
- Do not use the chair or the stool as a step stool.
- Do not leave children unattended on or beside the chair or stool.
- Be aware of risk of open fire and other sources of strong heat, such as electrical bar fires, gas fires, etc. in the vicinity of the product.
- Dispose of plastic wrapping and keep out of reach of children to avoid suffocation.
- Do not use the chair or stool if any parts are broken, torn or missing.
- Take care that your child does not climb on the chair or stool, there is a risk of falling off.
- Ensure all bolts are securely and correctly tightened.

Parts:

Check what you have received:

You have received 1 box. Please check the contents of the box against the list below. If anything is missing, please contact Customer Service.

back cushion
A x1

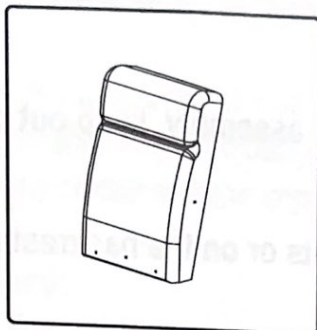

seat cushion
B x1

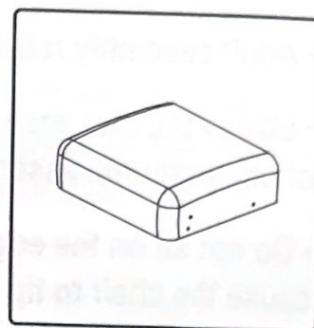

chair feet
C x2

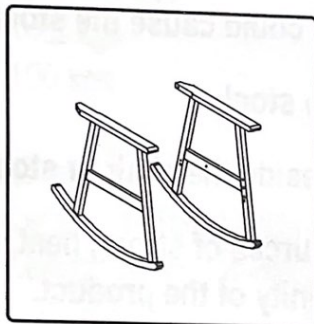

pole
D x2

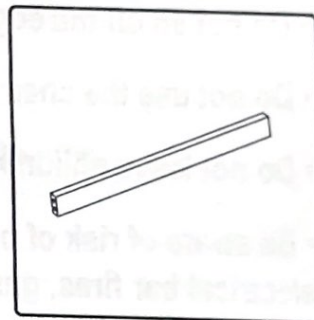

footstool cushion
E x1

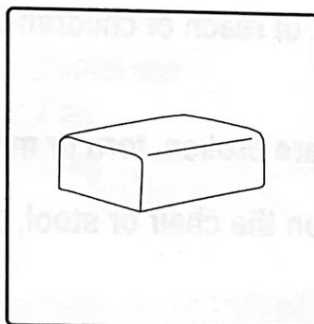

footstool feet
F x2

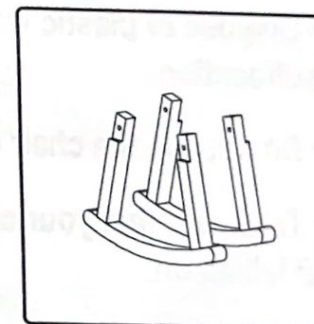

bolt/washer
G x13

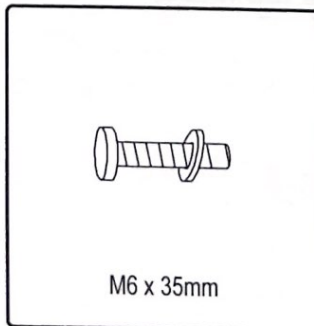

bolt/washer
H x6

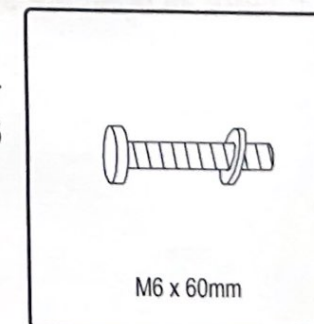

Parts:

batten
I x4



nut M6mm
J x4



allen key
K x1



washer
L x13



Chair Assembly:

- 1.1. On a flat surface, assemble the back cushion (A) to the seat cushion (B).
- 1.2. Line up the pre-drilled holes on the back cushion with the holes on the seat cushion as illustrated.
- 1.3. Place a washer (L) over a 35mm bolt/washer (G) and insert the bolt into the hole. Repeat for the remaining holes on the seat cushion.
- 1.4. Tighten bolts with allen key (K).

⚠ WARNING! DO NOT over-tighten bolts.

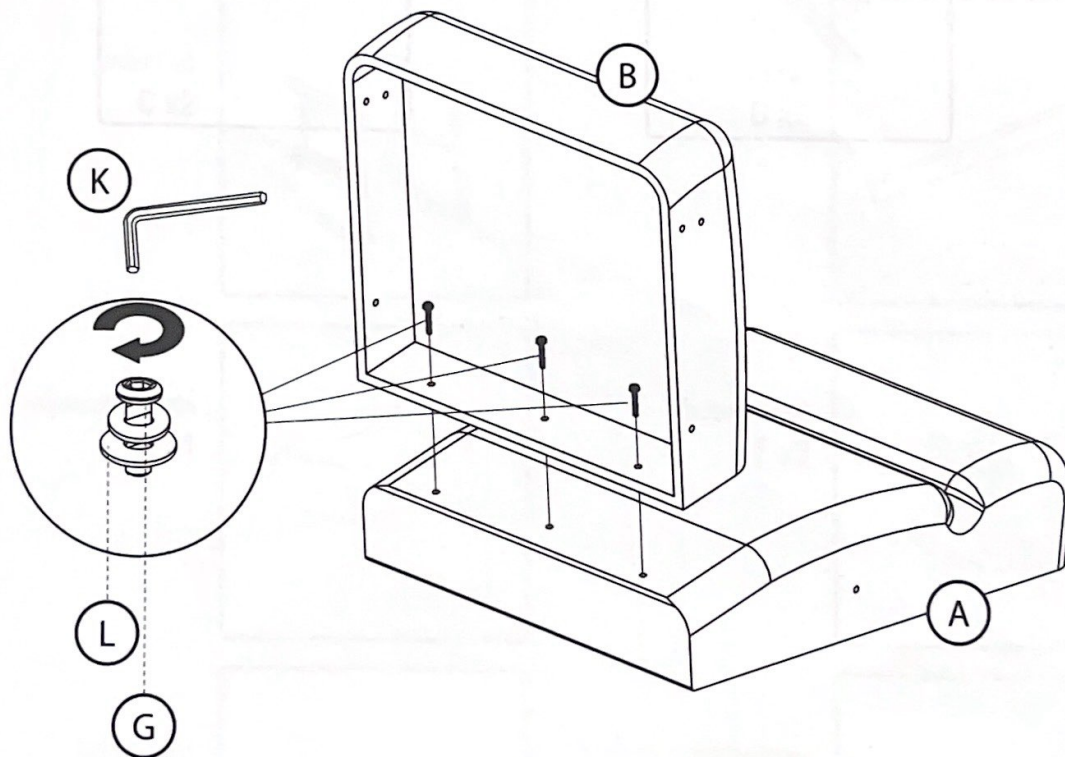

Chair Assembly:

- 2.1. Turn the assembled back and seat cushion on their side and locate one side of the chair feet (C).
- 2.2. Line up the pre-drilled holes on the seat cushion with the holes on the chair feet as illustrated.
- 2.3. For the 3 x holes aligned with the seat cushion, place a washer (L) over a 35mm bolt/washer (G) and insert the bolt into the hole. Repeat for the remaining holes on the seat cushion.
- 2.4. Secure the back cushion to the chair feet with a 60mm bolt/washer (H).
- 2.5. Tighten bolts with allen key (K).

⚠ WARNING! DO NOT over-tighten bolts.

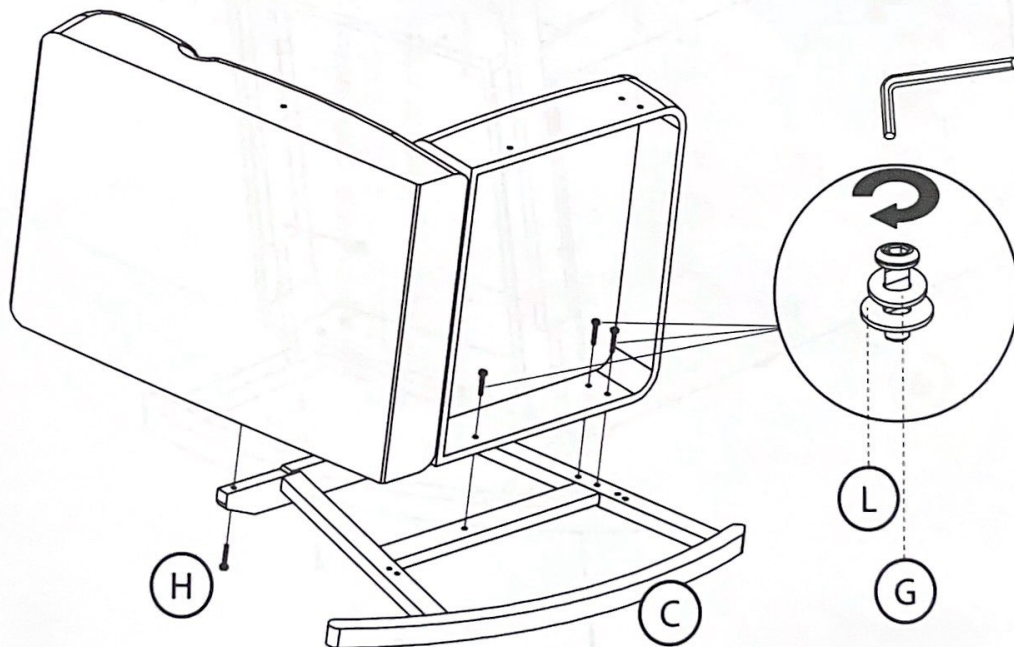

Chair Assembly:

3.1. Assemble the poles (D) to the assembled back and seat cushion and feet.

3.2. Insert the battons (I) into the ends of the poles.

3.3. Insert the nuts (J) into the holes at the side of the poles as illustrated.

3.4 Secure together with 60mm bolts/washers (H).

3.5. Tighten bolts with allen key (K).

⚠ WARNING! DO NOT over-tighten bolts.

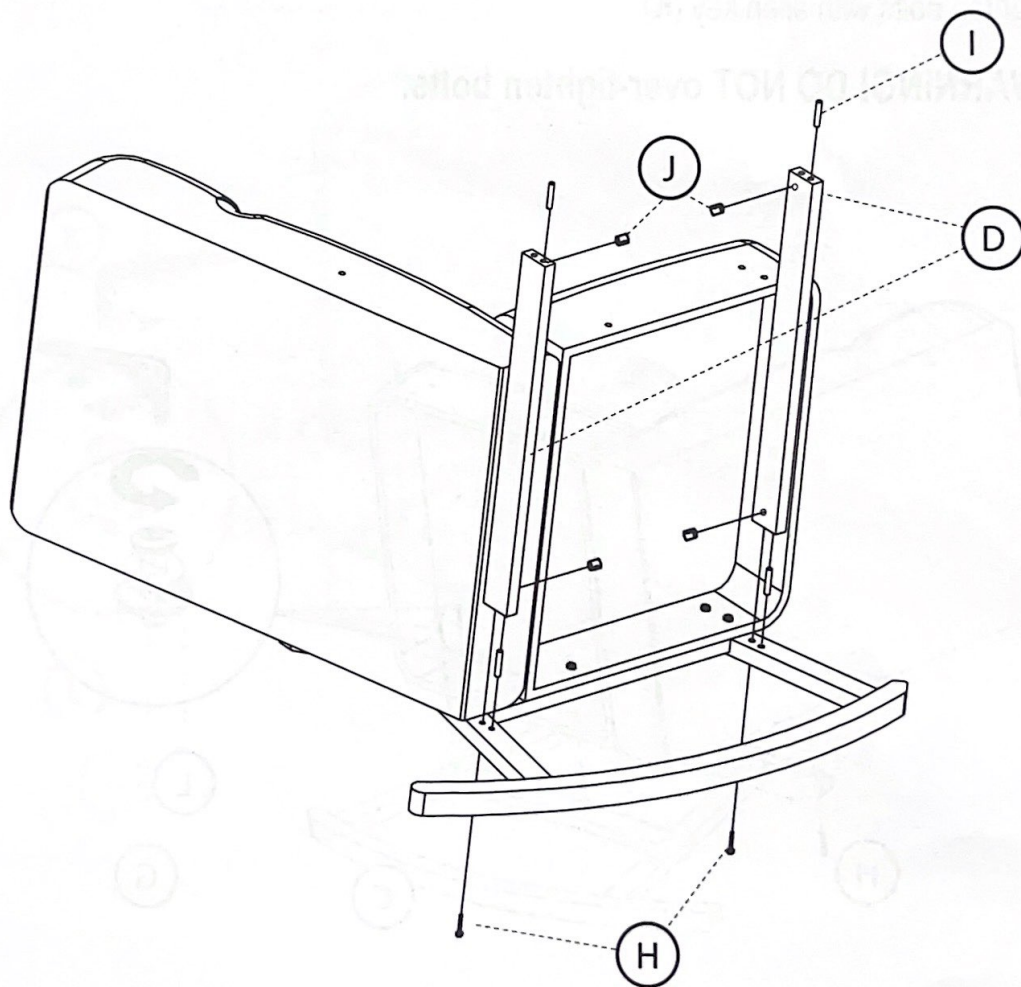

Chair Assembly:

4.1. Secure the second chair feet with remaining 35mm bolts/washers and washers and 60mm bolts/washers as illustrated.

⚠ WARNING! DO NOT over-tighten bolts.

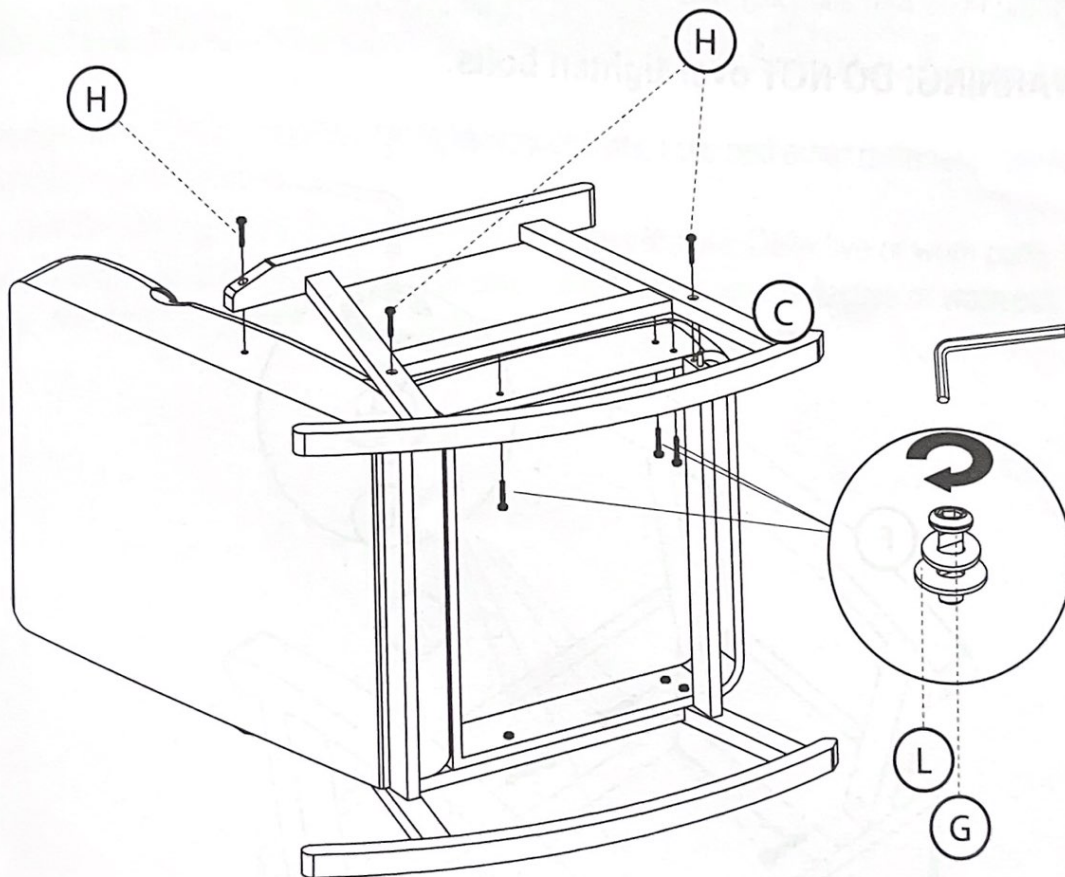

Footstool Assembly:

- 5.1. On a flat surface, assemble the footstool cushion (E) to the footstool feet (F).
- 5.2. Line up the pre-drilled holes on the footstool cushion with the holes on the footstool feet as illustrated.
- 5.3. Place a washer (L) over a 35mm bolt/washer (G) and insert the bolt into the hole. Repeat for the remaining holes.
- 5.4. Tighten bolts with allen key (K).

 **WARNING! DO NOT over-tighten bolts.**

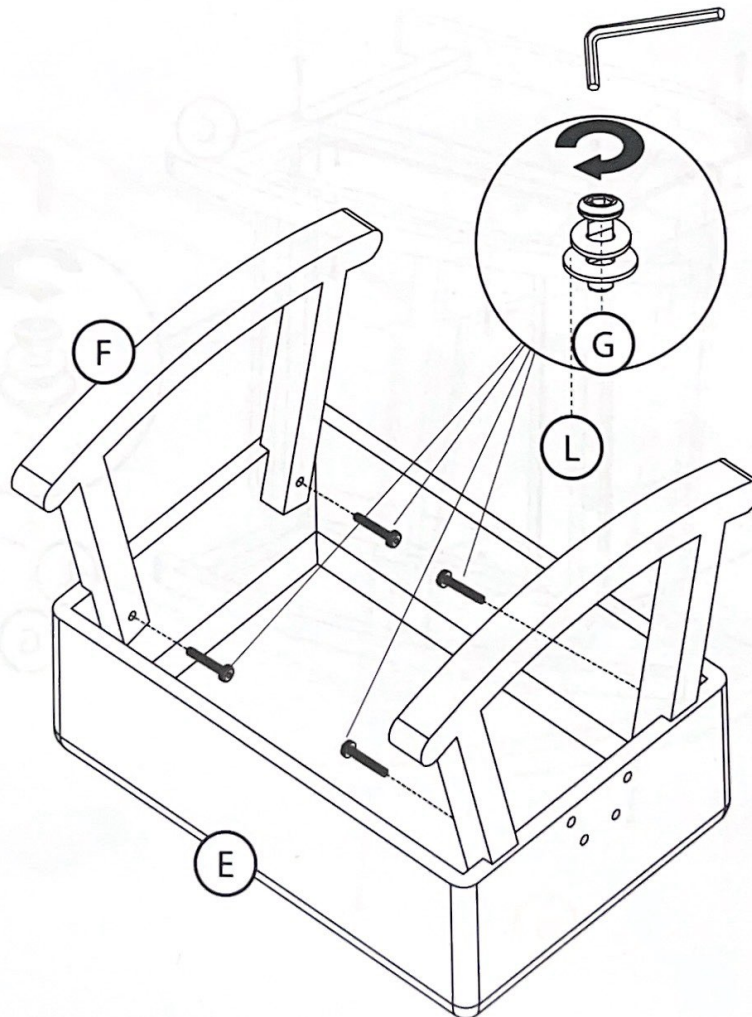

Cleaning:

To ensure the long-lasting use of your chair and stool, sponge clean or wipe cushions with damp cloth only. Leave upholstery to air dry.

Only use a mild detergent to clean legs of your stool. Dry off the chair and stool with a soft cloth. Never use abrasive cleaners.

Maintenance:

Always check parts regularly for tightness of bolts, nuts and other fasteners - tighten or replace if required.

Check the strength of the fabric covers from time to time. Defective or worn parts must be replaced; as should components which are broken, torn, defective or worn out.

Use only parts and accessories approved by the manufacturer.

Due to variation in style and design the illustrations used in this instruction manual are generic.
Variation in design may occur in the images shown.

Supplied by:
Babyfactory NZ Ltd.
58 Stonedon Drive, East Tamaki,
Auckland, New Zealand
www.babyfactory.co.nz