

CHILD INFORMATION
(KEEP WITH CAR SEAT AT ALL TIMES IN CASE OF EMERGENCY)
NAME:

DATE OF BIRTH (DD/MM/YYYY):

ADDRESS:

ALLERGIES/MEDICAL CONDITIONS:

EMERGENCY CONTACT 1:

NAME:

PHONE NUMBER:

EMERGENCY CONTACT 2:

NAME:

PHONE NUMBER:

www.cozynsafe.com

Cozy N Safe
Oxford Street, Wolverhampton, West Midlands, WV14 7DP, UK
Tel: +44 (0) 1902 494905 | Email: enq@cozynsafe.com

EU Authorized Representative: Authorised Representative service,
Euro Stock Venture Traders Ltd
Unit 1, 3 O'Connell Square, Edenderry, Co. Offaly, R45 Yr13 Republic
Of Ireland

INSTRUCTION MANUAL

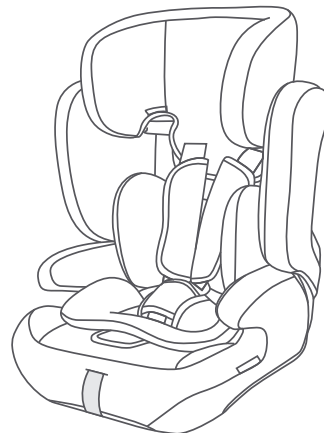

FUJI i-Size
EST-288



● 76-150CM



GENERAL SAFETY INSTRUCTIONS

Please take the time to carefully read these instructions and ensure they are always stored in the provided storage pouch on the child seat for future reference. The instructions must accompany the child seat if it is later passed on to a third party.

DANGER! To ensure the safety of your child:

- > Before closing the vehicle door, carefully check that neither your child nor any components of the child seat can become trapped in the door.
- > In the event of an accident with a collision velocity exceeding 10 km/h, it is conceivable that the child seat may incur damage, even if not immediately apparent. In such cases, the child seat must be replaced. Please dispose of it appropriately.
- > Always have the child seat inspected if it has suffered damage, such as falling to the ground.
- > Regularly inspect all crucial components for any signs of damage, with particular emphasis on ensuring the full functionality of all mechanical parts.
- > Avoid using grease or oil to lubricate any parts of the child seat.
- > Never leave your child unattended in the child seat while in the vehicle.
- > Instruct your child to enter and exit the vehicle from the pavement side exclusively.
- > When not in use, shield the child seat from direct sunlight. Prolonged exposure to direct sunshine can cause the child seat to become excessively hot, potentially harming the child's sensitive skin.
- > Ensure the seat belt fits snugly over your child's body for maximum safety. Therefore, discourage your child from wearing thick clothing under the belt.
- > During extended journeys, schedule regular breaks to allow your child the opportunity to move around and play.
- > When using the rear seat: Adjust the front seat to a position where it is forward enough to prevent your child's feet from coming into contact with the backrest of the front seat, thereby minimizing the risk of injury.

DANGER! To safeguard all vehicle occupants:

- In the event of an emergency stop or accident, unsecured objects or individuals may pose a risk of injury to other occupants in the vehicle. Hence, always ensure that...
- > Only use load-bearing contact points as specified in these instructions and those marked on the child seat.
 - > Confirm that the backrests of car seats are securely in place (e.g., ensure that any fold-down rear seat bench has snapped into position).
 - > Securely fasten all heavy or sharp-edged objects within the vehicle, such as those on the parcel shelf.
 - > Ensure all occupants in the vehicle have their seatbelts fastened.
 - > Secure the child seat whenever it is in the vehicle, even if it is not carrying a child.
- WARNING! For your protection when handling the child seat:**
- > Never use the child seat in a free-standing position, not even for testing.

- > To prevent damage, ensure the child seat is not jammed between hard objects (car door, seat rails, etc.).
 - > Store the child seat in a safe place when not in use. Avoid placing heavy objects on the seat and refrain from storing it directly next to heat sources or in direct sunlight.
 - > Position the rigid items and plastic parts of a child restraint in a way that they do not become trapped by a movable seat or in a vehicle door during everyday use.
 - > Do not use the child restraint without the cover.
 - > Only replace the seat cover with the one recommended by the manufacturer, as it is an integral part of the restraint performance.
- WARNING! For your protection when handling the child seat:**
- > Never use the child seat in a free-standing position, not even for testing.
 - > To avoid damage, ensure that the child seat is not jammed in between hard objects (car door, seat rails, etc.).
 - > Keep the child seat in a safe place when not in use. Do not place heavy objects on the seat and do not store directly next to heat sources or in direct sunlight.
 - > The rigid items and plastic parts of a child restraint must be so located and installed that they are not liable, during everyday use of the vehicle to become trapped by a movable seat or in a door of the vehicle.
 - > The child restraint must not be used without the cover.
 - > The seat cover should not be replaced with any other than the one recommended by the manufacturer, because the cover constitutes an integral part of the restraint performance.

USE IN THE VEHICLE

Use as Intended:

This child seat has been meticulously designed, tested, and approved in compliance with the European Standard for Child Safety Equipment (UN129/03). Its purpose is to secure a child within the vehicle. It is not a toy and is not suitable for use as a seat outside the vehicle.

SAFETY NOTES

Elimination of the Protective Function through Modifications:

Unauthorized technical changes can diminish or entirely eliminate the protective function of the seat. The certification becomes void if any modifications are made to the child seat.

- > Do not make any technical changes to the child safety seat.
- > Only the manufacturer is permitted to make modifications to the child safety seat.

Risk of Injury through Improper Use:

If this product is not used as intended, serious injury or death may occur.

- > Never secure the child seat with a 2-point seat belt.
- > Read and follow the instruction manual for the vehicle used to transport this child seat.
- > If in doubt, consult the manufacturer or the vendor of the child restraint system.
- > Use the child seat according to the body height of the child to be secured.

Parts List

Ensure that all parts are present and accounted for. If any components are missing, please promptly contact the retailer for assistance.

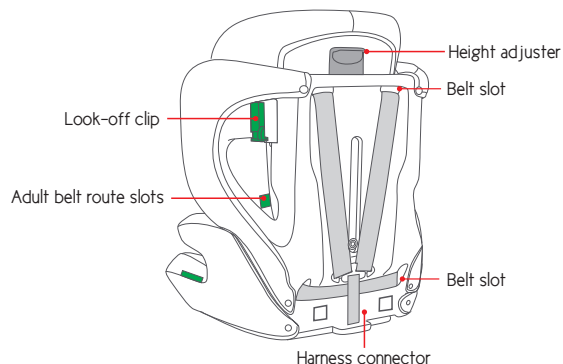
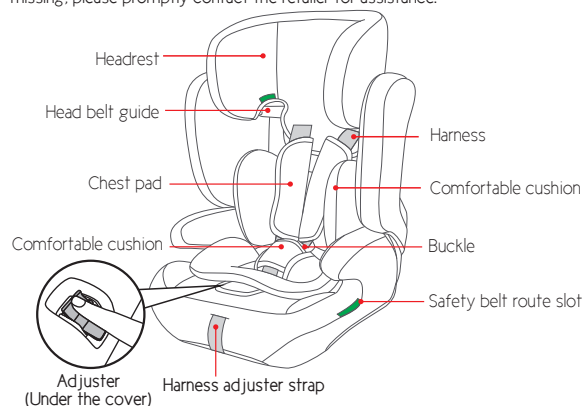

■ : routing label

Concerns on Installation

see images ① - ②

Suitability Note:

This child seat is only appropriate for use in vehicles equipped with 3-point safety belts that are approved to UN/ECE Regulation No.16 or other equivalent standards.

! If the buckle strap of the car seat is excessively long, the child restraint system cannot be securely installed. This poses a significant danger. If there is any doubt, please consult the child restraint system manufacturer for guidance.

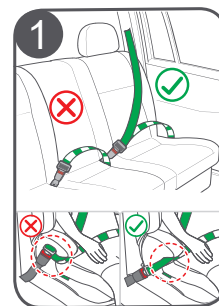

2

NOTICE



- Important Installation Guidelines:**
- DO NOT install the car seat on rearward-facing or side-facing seats in the vehicle.
 - DO NOT place the car seat on seats equipped with an active front airbag.
 - A car seat can be installed in the middle seat only if the seat is equipped with a three-point car seat belt.
 - If the car seat is installed in the front seat of the vehicle, the front airbag must be deactivated.
 - It is recommended to install the seat only in the rear seats of the car.

Scope of application for children

This child seat is approved for two installation methods. Choose the installation method based on the size of the child to be secured.

see images ④

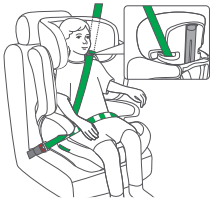
3	Suitable for	Figure for Installation
76 -105 cm/9kg-18kg		
100 -150 cm/15kg-36kg		

Suitable for /9kg-18kg installation

see images ④ - ⑧

1. Position the child safety seat against the car seat. ④

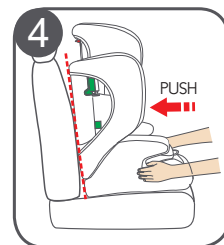

2. Pull out the diagonal belt along with the lap belt through the belt route slot on the backrest. ⑤

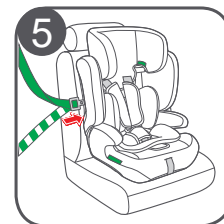

3. Insert the belt into the car seat belt buckle until you hear a distinct "CLICK". ⑥

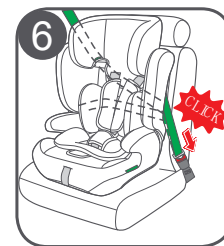

4. Clip the diagonal belt into the locking clip . ⑦

! Pull the car seat belt following the direction of the red arrow and ensure that the belt is tightened sufficiently.



! Note: Please refer to the picture and ensure that the safety belt is clipped into the locking clip correctly.

5. Release the buckle. Place the child into the safety car seat. Align the left and right buckle tongues into one tongue. Insert the aligned tongues into the buckle until you hear a distinct "Click." ⑧

! Notice: Ensure that the harness is not twisted.

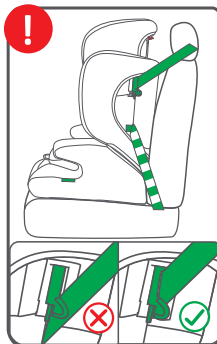
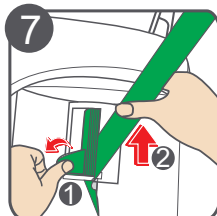

Suitable for 100 -150 cm/15kg-36kg installation

see images ⑨ - ⑫

1. Place the seat against the car seat. ⑨

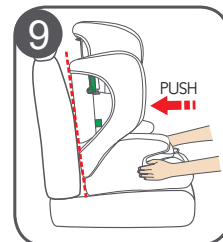

2. Removing Car Seat Pad Procedure. ⑩
1. Hide the strap of both sides behind the backrest cover. (Refer to image ⑩ - ⑫ for details). ⑩ - ⑪
2. Place the buckle in the base (under the cover). ⑩ - ⑫

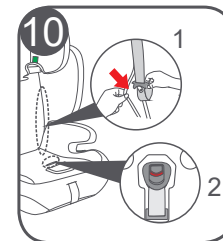

3. Installing the Baby Car Seat. ⑪
Follow the routine to install the baby car seat. Ensure the baby car seat is stored in a safe place or securely installed when not in use.

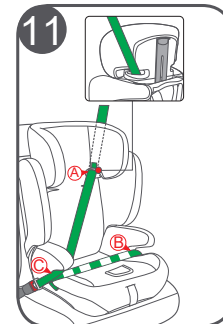

! Stock the baby car seat in a safe place or ensure the baby car seat is firmly installed when not using it.

4. Securing the Child:
Place the child into the safety car seat. Pull the car seat belt along the designated route and lock. 12

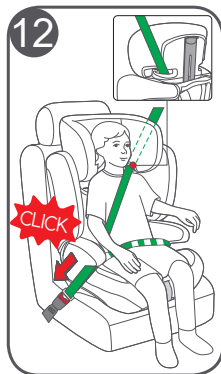

Using the buckle

see images 13 - 14

Locking Method:

Align the left and right buckle tongues into one tongue and insert them into the buckle until you hear a distinct 'Click'. 13

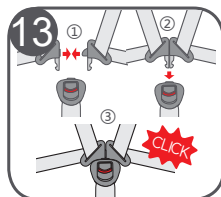

Unlocking Method:

Press the red button of the buckle downwards; the two metal sections will pop up. 14

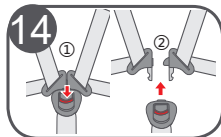

Adjustment for Head Support and Shoulder Harnesses

Note

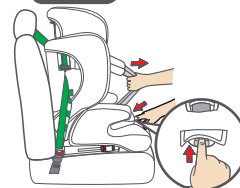

1. Adjusting Safety Harness:

Press the safety harness adjustment button while simultaneously pulling the safety harness to the limit.

! Do not pull the shoulder pads.

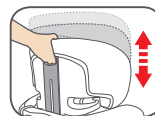

2. Adjusting Headrest and Belt Slot:

Adjust the height of the headrest and belt slot to the suitable height for the child.

! The height for the harness is adjusted by lifting the headrest.

5-point seat belt



Car seat belt



Instructions for use of cushion

Note

Please use the cushion for children less than 87cm. Put the cushion in the child restraint system, and then adjust the harness and cushion following the provided picture.

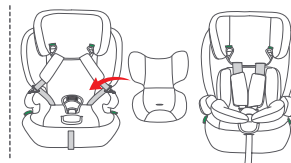

Steps of backrest and base assembly

see images 15 - 17

1. Aligning Base and Backrest
Ensure that the base and backrest are aligned in a straight line. 15

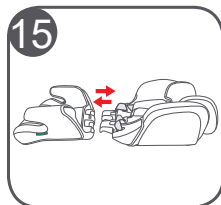

2. Securely Placing Backrest Hooks Inside Base:
Ensure that the backrest hooks are securely placed inside the base. 16

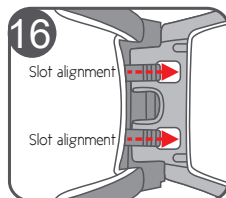

3: Lifting Backrest Up.
Gently keep pressure on the hooks as you lift the backrest up. 17

! Do not force, as it may cause damage.

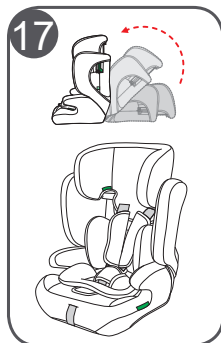

Remove the cover

see images 18 - 24

1. Release the Harness 18
Gently loosen the harness.

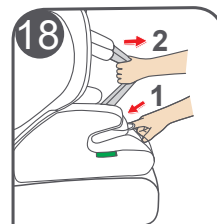

2. Unlock the Buckle
Press the red button 19 to release the buckle of the harnesses.

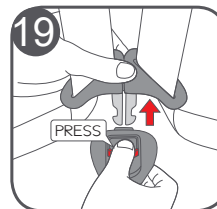
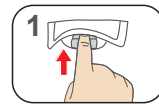

3. Secure the Removed Cushion
Store the removed cushion 20 securely for future use.

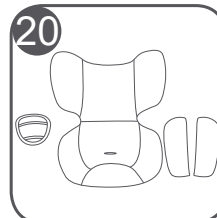

4. Secure the Buckle in the Base:
Place the buckle in the base (under the cover)
for safekeeping. 

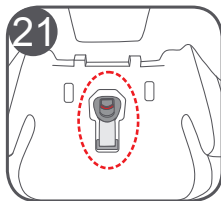

5. Conceal the Straps:
Hide the straps on both sides behind the
backrest cover for a neat and secure
arrangement. 

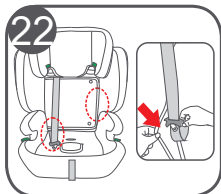

6. Unlock Snap Fastener
Turn the seat to the back and release the snap
fastener. 

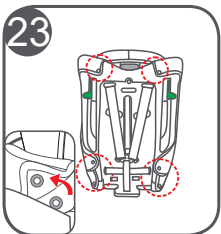

Remove Fabric Cover:

7. Remove Fabric Cover:
Pull in all directions to detach the cover. 

! Follow the reverse order to put on the
fabric cover, repeating the procedure.

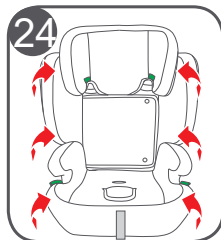

Care and Maintenance

! In regular use, periodically inspect the child seat. Replace the child seat after an accident.

! Store the child seat in a dry and ventilated place to prevent dampness and mold.

! If the child seat gets dusty, clean the seat belt and plastic parts by wiping them with a damp sponge and allow them to dry naturally.

! In case of spills or stains on the buckle, disassemble the seat belt from the child seat and rinse it gently with warm water. Let it dry naturally.

! For cleaning the entire fabric cover of the child seat, refer to the washing instructions.

Washing instruction

When cleaning the entire fabric cover of the child seat, avoid using solvents, chemical detergents, or lubricants on any part of the seat. Follow the guidelines below for proper cleaning



Hand wash.
water
temperature
below 30°C



Do not bleach



Dryclean any
solvent except
trichloroethylene



Do not tumble dry



Do not iron