

MAINTENANCE

- This stroller requires regular maintenance by the user.
- Regular lubrication of moving parts will extend the life of your stroller and make opening and folding easier.
- Check your stroller regularly. If any parts, like bolts, screws, fabric pieces or stitching are found to be loose, broken or damaged, always repair or replace them.
- Regularly inspect the locking devices, brakes, wheels, harness assembly, catches, seat adjusters, joints and fixings to ensure they are secure and in full working order. These should be free to move at all times.
- Brakes, wheels and tyres are subject to wear and should be replaced if necessary.
- Do not leave the stroller in sunlight for prolonged periods—some fabrics may fade.
- Your stroller should be serviced and reconditioned before using it for a second baby, or within 18 months, whichever is the sooner.
- Where damage or dysfunction occurs, stop using the stroller.

CLEANING

- Plastic and metal parts may be sponged clean with warm water and a mild detergent.
- Never clean with abrasive, ammonia based, bleach based or spirit type cleaners.
- Storing a damp stroller will encourage mildew to form.
- Dry thoroughly before storing.
- After exposure to damp conditions, dry off with a soft cloth, open fully and allow to the air.

Supplied by:

The Babyfactory NZ Ltd
58 Stonedon Drive, East Tamaki
Auckland, NZ. www.babyfactory.co.nz

Babyco Australia
www.babyco.com.au

Edinburgh

EZI STROLLER

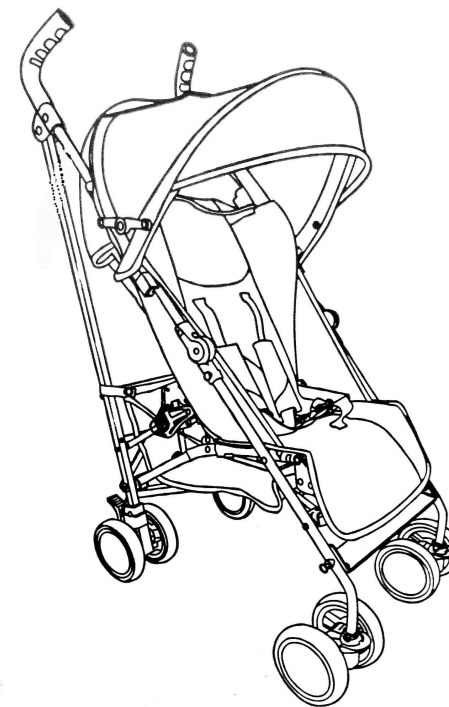

Model: SH162A

TBF 221001 - 3

Keep this booklet in a safe place for future reference

Note: Colour and features of product may differ from the diagrams shown

PLEASE READ THESE INSTRUCTIONS CAREFULLY BEFORE USING

Instruction Booklet

WARNING

READ INSTRUCTIONS CAREFULLY BEFORE ASSEMBLY AND USE OF THE STROLLER



ALWAYS APPLY THE BRAKES WHENEVER THE STROLLER IS STATIONARY.

DO NOT LEAVE CHILD UNATTENDED.

SECURE THE CHILD IN THE HARNESS AT ALL TIMES.

DO NOT CARRY EXTRA CHILDREN OR BAGS ON THIS STROLLER.

MAKE SURE CHILDREN ARE CLEAR OF ANY MOVING PARTS IF YOU ADJUST STROLLER.

1. Check that all safety locks are fully engaged before using stroller.
2. Do not use near an open fire or exposed flame.
3. Do not use accessories not approved by manufacturer, as these may be unsafe to operate with this stroller.
4. Never use stroller on stairs or escalators. Use extra care when going up or down a step or curb.
5. DO NOT place parcels, shopping bags etc on handle or canopy. They may fall onto the child or change the balance of stroller and make it unstable.
6. This stroller is designed for use on flat or gently sloping surfaces. On uneven or steep sloping surfaces the stroller may become unstable and tip over.
7. This stroller is suitable from birth to **15kgs**.
8. Do not place goods of more than 3 kgs in the storage basket.
9. THIS PRODUCT IS NOT INTENDED FOR COMMERCIAL USE.

SAFETY BELT ADJUSTMENT

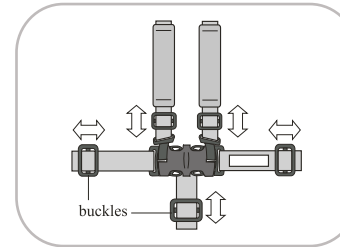

Tighten straps snugly around your child.
To tighten strap, slide buckles up.
To loosen strap, slide buckles down.

NOTE: Use this harness at all times.
Never leave your child unattended. Always keep your child in view.

USING RESTRAINT SYSTEM

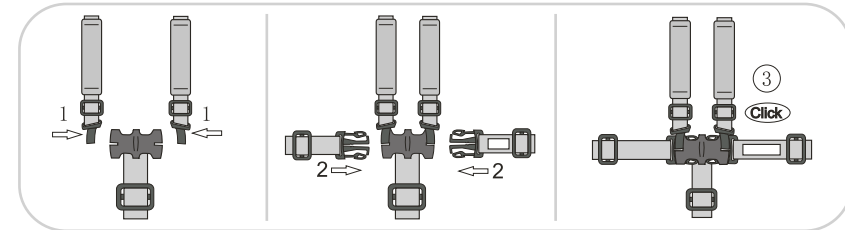

Place your child in the stroller, with the crotch strap between the child's legs. Fit clips together (figure1). Slide clips into buckle (figure2) until you hear a "click" (figure3).

RELEASING RESTRAINT SYSTEM

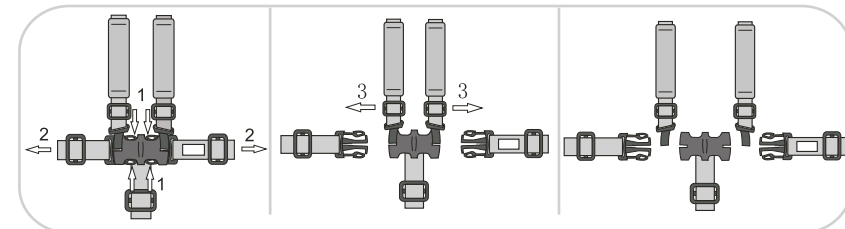

To release harness, squeeze edges of buckle firmly.

NOTE: Never leave the harness buckled when not fitted to a child in the stroller, because the harness can form loops which may pose a strangulation hazard.

SWIVEL WHEEL OPERATION

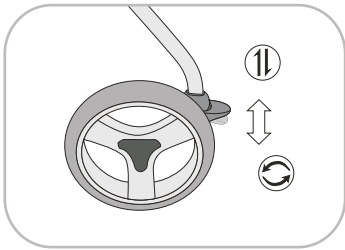

Lock the swivel wheel when using the stroller in a straight direction for a long period.

To lock, lift the pedal upwards.

To unlock, press the pedal downwards.

ATTENTION:

Before moving backwards the swivel wheels must be released!!!

Failure to follow the rules of swivel wheel operation may cause mechanical damage to the wheel system, which will not be covered by the guarantee.



WARNING

- BRAKES

ALWAYS APPLY THE BRAKES WHENEVER THE STROLLER IS STATIONARY.



WARNING

- USE OF TETHER STRAP

USE THE HAND TETHER STRAP TO STOP THE STROLLER ROLLING AWAY.



WARNING

- USE OF FOLDING LATCH

ALWAYS ENGAGE THE FOLDING LATCH WHEN THE STROLLER IS FOLDED DOWN.

TO AVOID DANGER OF INJURY WHILE TRANSPORTING OR LIFTING THE STROLLER, ALWAYS USE THE CARRY HANDLE ON THE SIDE FRAME.

WHEN FOLDING OR UNFOLDING THE STROLLER. BE AWARE OF THE POTENTIAL FOR INJURY FROM ENTRAPMENT OF FINGERS OR PARTS OF THE BODY.

EXERCISE DUE CARE AT ALL TIMES.

- Ensure that all the locking devices are engaged before use.
- Do not overload this stroller with additional children, goods or accessories. Bags and other items must not be hung from the handle. A basket is approved for the carriage of 3kg (6.61lb) of goods, evenly distributed.
- A pocket on the rear canopy is approved for the carriage of 0.2kg (0.44lb) of goods, evenly distributed.
- Keep away from fire.
- Please put away the poly-bag in time after you open it, avoiding a kid suffocates while playing with it.
- Please read the instruction for car seat carefully, if you'd like to use it as a part of the stroller.



INSTRUCTION

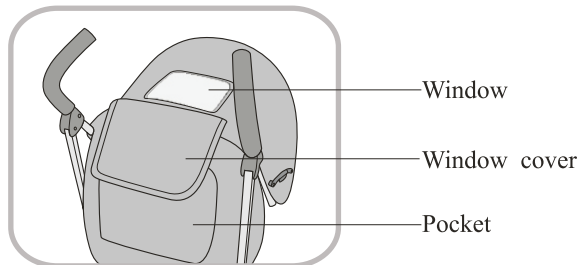
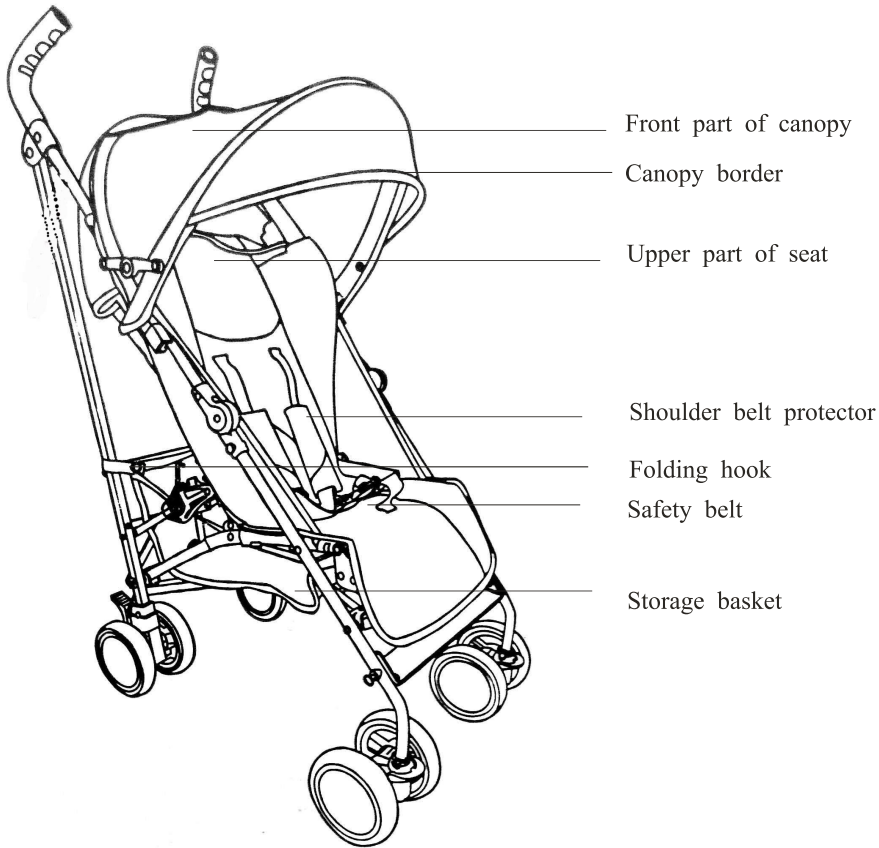

MOUNTING THE WHEELS

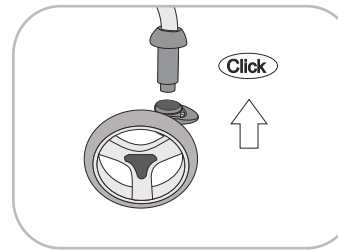

FRONT WHEELS:

Put the front wheel set on the hub (plastic tip of the tube) until you hear the locking device click.

Repeat the same procedure on the other side.

DISMANTLING THE WHEELS

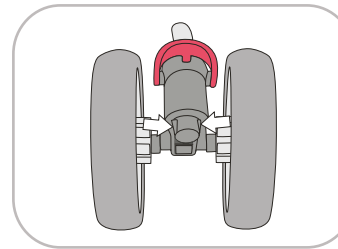

FRONT WHEELS:

To detach the front wheels press the locking device sticking out at the bottom of the wheel set and pull the wheel set until it slides off of the hub.

Repeat the same procedure on the other side.

REAR WHEEL BRAKES

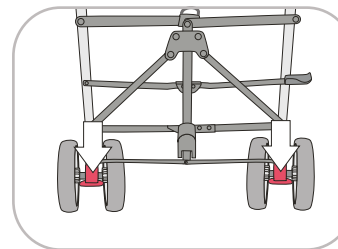

Push down the brake lever with your foot to set the parking brake.

NOTE: ALWAYS APPLY THE BRAKES WHENEVER THE STROLLER IS STATIONARY.

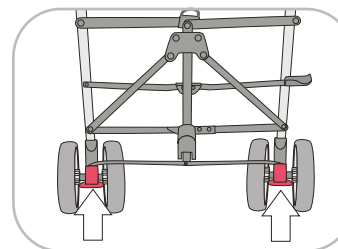

To release the brake, lift the lever with your foot.

BACKREST ADJUSTMENT



In this stroller the backrest may be adjusted in five positions.

To change its position press the backrest mechanism locks on both sides and adjust the backrest to the required position.

FOOTREST ADJUSTMENT

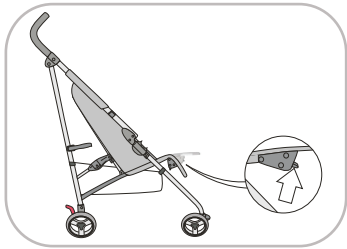

To adjust the footrest up, pull footrest to desired position.

To adjust down, press the locks on both sides and adjust to desired position.

USE OF HAND STRAP

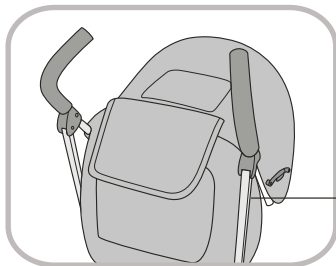

Always use the hand strap when using the stroller, to stop the stroller from rolling away.

PARTLIST

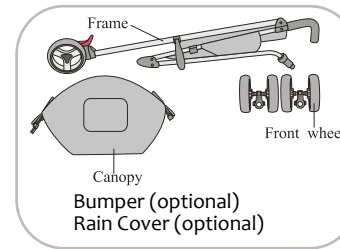

1. Frame 1PC
2. Canopy 1PC
3. Assembling front wheels 2SETS
User manual 1PC

NOTE: Open carton and poly bag, take out all parts (Please remove the poly bag and desiccant before assembling)

UNFOLDING THE STROLLER

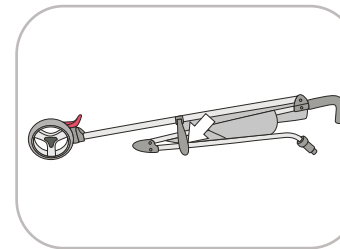

Open the folding hook.

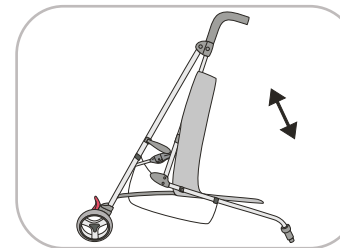

Push towards two sides with handle in left hand and front leg tube in right hand step.

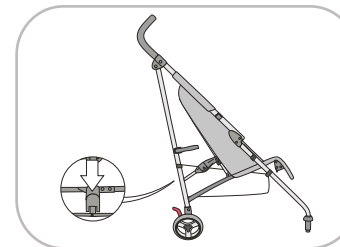

Step down the paddle second lock in back side until it opens completely. Before putting your child in the stroller make sure that the stroller has been unfolded properly.

FOLDING THE STROLLER

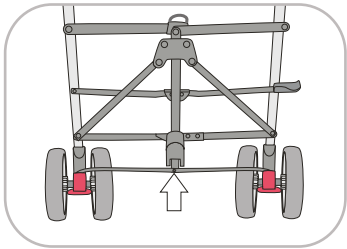

Fully engage rear brakes.
Push the seat back into the forward most position.
Detach the bumper bar. (If supplied)
Fold the hood.

Lift up the primary lock bar with your foot to disengage.

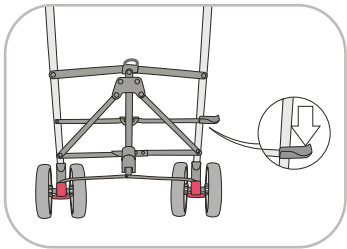

NOTE: Place the seat back in the upper most position before folding, otherwise damage may occur.

Now step down onto the secondary lock latch to fully release the frame, for folding.



Hold the handle and push forward to fold the stroller.

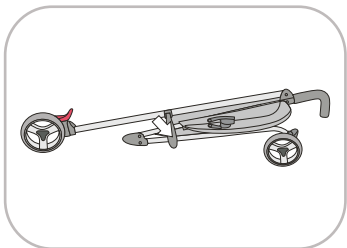

Keep folding down until the side folding lock 'clicks' shut or apply lock catch manually to secure.

MOUNTING THE CANOPY



Place the canopy ahead then insert the plastic connector in both sides of canopy into the frame.

DISMANTLING THE CANOPY



TO REMOVE CANOPY

Release all velcro fasteners.
Gently release both side brace bars.
Pull the canopy upwards out of side connectors and store

CANOPY ADJUSTMENT



TO OPERATE CANOPY

Slide the canopy into the locaters on the side of the main frame. Apply velcro fasteners at rear of seat back.



Extend the canopy out and press down both side brace bars to lock in open position.