

Edinburgh

Auto Fold Stroller

INSTRUCTION USER MANUAL



IMPORTANT – READ CAREFULLY AND KEEP FOR FUTURE REFERENCE!

Safety Standard: EN 1888-2:2018+A1: 2022

MADE IN CHINA

Safety Instructions:

IMPORTANT - READ CAREFULLY AND KEEP FOR FUTURE REFERENCE!

WARNING!

- **WARNING** Never leave the child unattended.
- **WARNING** ALWAYS use the restraint system.
- **WARNING** Ensure that all the locking devices are engaged before use
- **WARNING** This product is not suitable for running or skating.
- **WARNING** To avoid injury ensure that the child is kept away when unfolding and folding this product.
- **WARNING** DO NOT let the child play with this product.
- **WARNING** Check that the pram body or seat unit or car seat attachment devices are correctly engaged before use.
- Always engage the parking brake when the stroller is not moving.
- Engage the parking brake when securing or removing the child.
- It is recommend using the most reclined position for new born babies.
- Always keep child in view while in stroller.
- Any load attached to the handle and/or on the back of the backrest and/or on the sides of the vehicle will affect the stability of the vehicle.
- The stroller is intended for children from birth to 4 years or up to 22kg whichever comes first.
- Avoid serious injury from falling or sliding out.
- Not suitable for more than one child.
- DO NOT use stroller on stairs or escalators.
- DO NOT hang or place items on the stroller handle or frame unless approved by manufacturer.
- DO NOT allow child to stand in stroller.
- DO NOT push or lift the stroller by the bumper bar.
- DO NOT overload basket. The maximum weight of basket is 2 kgs.
- DO NOT use other accessories not provided or approved by manufacturer.
- Only replacement parts supplied or recommended by the manufacturer or distributor shall be used.

! WARNING!

- **WARNING!** This product should be assembled by an adult and adjustments must be made by the child's caregiver.
- **WARNING!** The caregiver is not allowed to leave while the child is using.
- **WARNING!** Placing any load on the handlebars will affect the stability of the stroller.
- **WARNING!** Keep children away from moving parts when adjusting the stroller.
- **WARNING!** Do not allow children to stand or play on foot boards.
- **WARNING!** Do not move the stroller up and down stairs or fold the stroller when children are in the stroller.
- **WARNING!** Children must use seat belts properly when using.
- **WARNING!** Strollers must be kept away from pools, lakeside stairs, heat sources and fires.
- **WARNING!** Keep plastic covers away from babies to avoid suffocation.
- **WARNING!** When the seatback angle is adjusted to be less than 150 degrees, it is not suitable for children under 6 months old.
- **WARNING!** The basket should not contain any items when folding.
- **WARNING!** Front bar should not be removed when the stroller is using.
- **WARNING!** The parking device shall be engaged when placing and removing the child.
- **WARNING!** Use of the most reclined position for new born babies.



max22kg

Product Overview

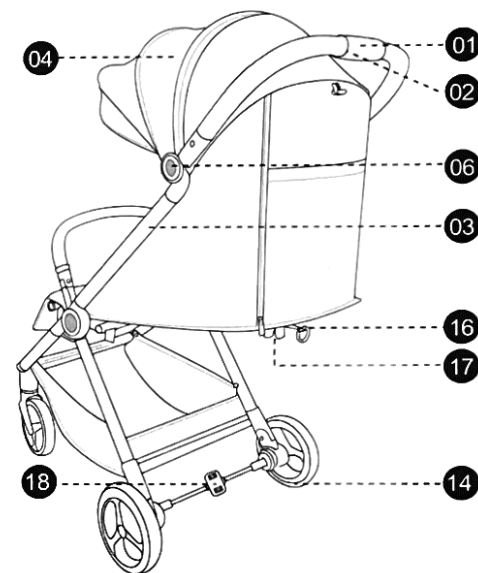
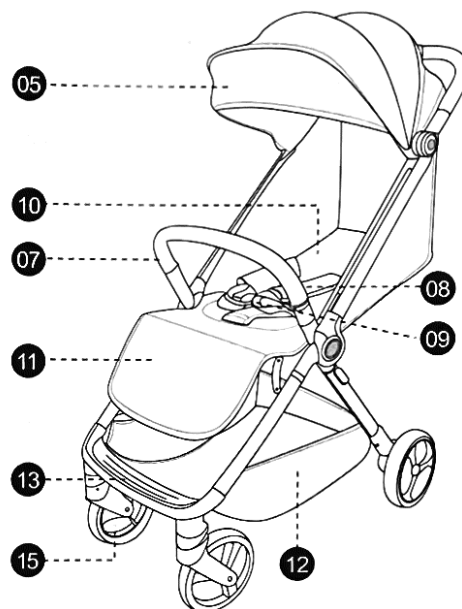

1. One Hand Fold
2. Second Fold Button
3. Handle Tube
4. Canopy
5. Canopy Sunvisor
6. Canopy Housing
7. Bumper Bar
8. Harness Straps
9. Harness Buckle

10. Seat Fabric Cover
11. Adjustable Leg rest
12. Basket
13. Footrest
14. Rear Wheels
15. Front Wheels
16. Seatback Adjustable Strap
17. Seatback Adjustable Button
18. Brake Pedal

Unpack Steps

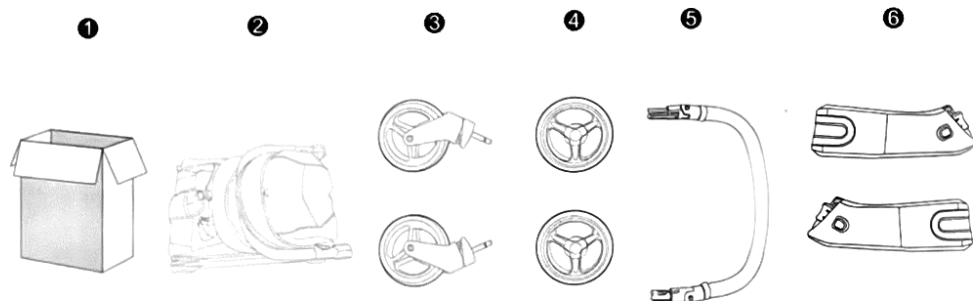

Open the package carton and take out the frame with fabric covers, front wheel, rear wheel and front bumper bar, and car seat adapters.

Unfold the Frame

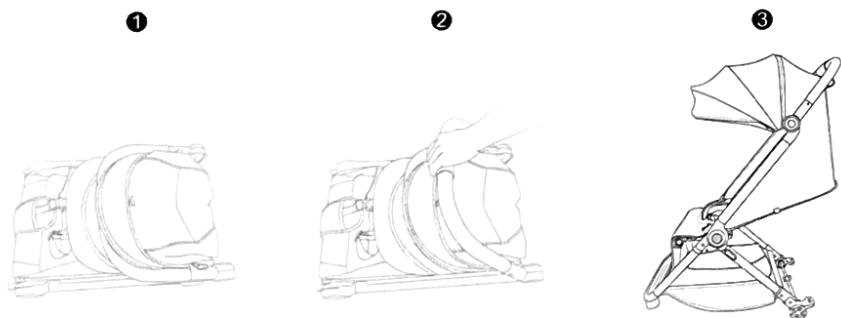

1. Remove and discard all packaging materials before unfolding the stroller. (diagram 1) .
2. Hold on handle tube and lift up the stroller frame until the side locks of stroller frames are clicked securely. (diagram 2/diagram 3).

Front Wheel Installation & Removal

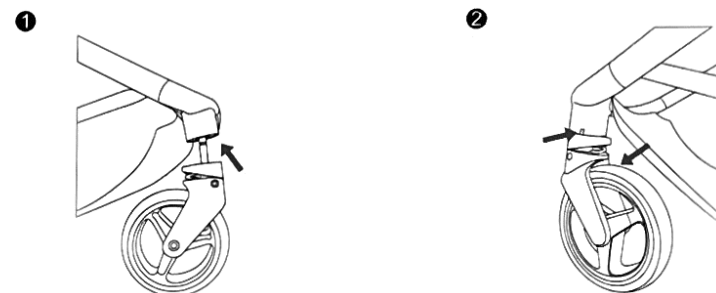

1.Installing the front wheels:

Align the hole and insert the front wheel vertically upwards, in while you will hear a sound in "click"(diagram 1). Push down to ensure the front wheel is secured.

2.Removing the front wheels:

Push the button inside and pull the front wheel out vertically (diagram 2).

Rear Wheel Installation & Removal

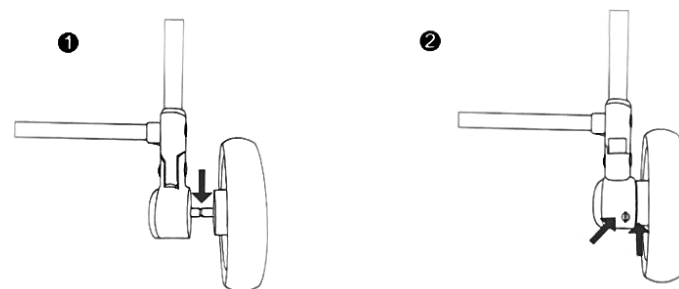

1.Installing the rear wheels:

Align the hole and insert the rear wheel horizontally, in while you will hear a sound in "click"(diagram 1). Pull the wheel outwards to ensure it is secured.

2.Removing the front wheels:

Pull outwards on the rear wheel release button by one hand, at the same time using another hand to pull out of rear wheel until it is removed(diagram 2).

Front Bumper Bar Installation & Removal

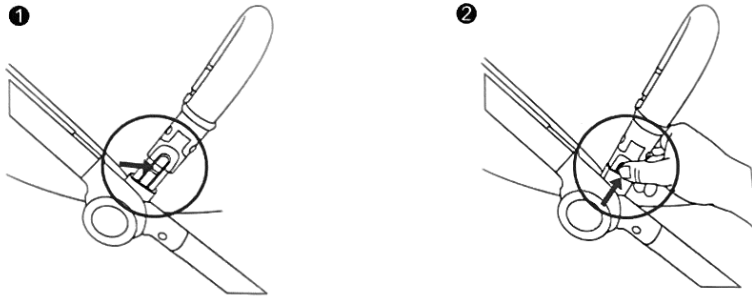

1.Installing the Front Bumper Bar:

Align the hole and insert the front bumper bar vertically, in while you will hear a sound in "click"(diagram 1). Pull the bumper bar outwards to ensure it is locked securely.

2.Removing the Front Bumper Bar:

Push the release button on the bumper bar ends and pull upwards the bumper bar to remove the bumper bar from stroller frame (diagram 2).

Folding the Stroller Frame

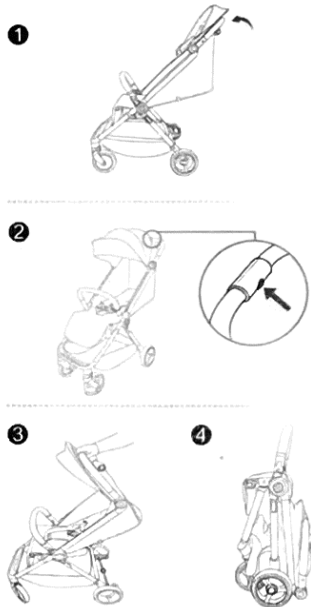

① Fold the canopy (diagram 1).

② To hold the One-Hand-Fold button by one hand, and use the fingers to press inside the second lock button (diagram 2),

③ ④ Rotate the handle but pushing forward and the stroller will be folded automatically (diagram 3 and 4).

Canopy Installation and Removal

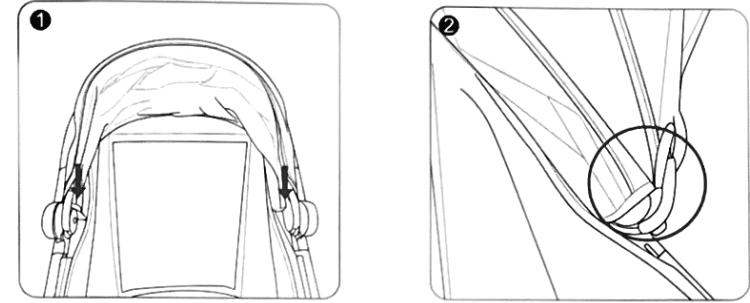

1.Canopy Installation:

Fit the support rod of canopy into the canopy housing areas, and fasten the elastic strap by hooks (diagram 1 and diagram 2). To zip the canopy with seat fabric cover top section.

2. Canopy Removal

Unfasten the elastic straps from canopy housing hook and unfasten the zipper with seat cover top section to remove the canopy from stroller frame.

How to use the canopy

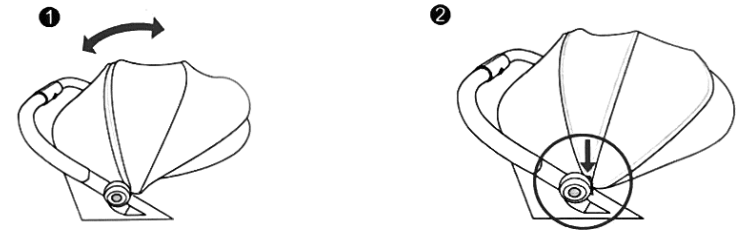

1.Pull or push the front of the canopy forward to desired position (diagram 1). The sunvisor can be extended or folded inside.

2.Open the zipper located on canopy to extend the canopy (diagram 2).

How to install & remove the seat cover from frame

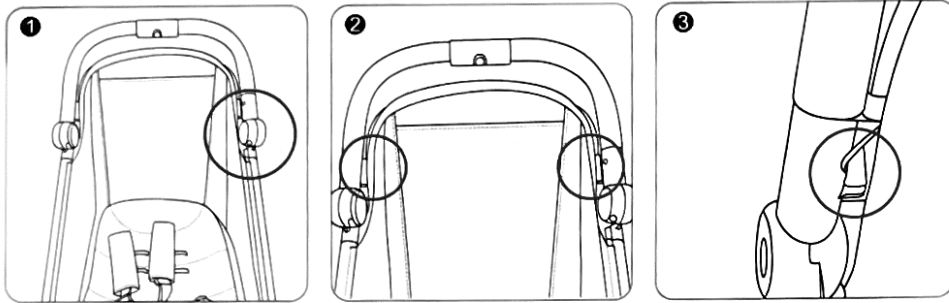

1. Slide the seat fabric cover side wings fixing rod onto the slot of handle tube (diagram 1), fix the top support rod onto connector and hang on by elastic strap (diagram 2 and diagram 3) .

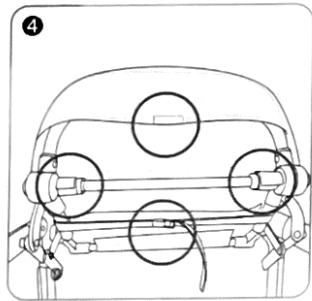

2. Fit on the front sleeve of seat cover onto the leg-rest tube and close by velcro, then close the velcros on front and back crossing tubes, tighten the support webbing by metal buckle in the middle (diagram 4).

Seat Cover Removal:

1. Loosen the support straps underneath of seat, and unfasten the elastic strap to fix top rod.
2. Unfasten the zipper with canopy, then lift upwards a little on the seat wings fixture through the slot on handle tube , pull outwards to remove the seat cover from stroller frame completely.

How to use the seat back window

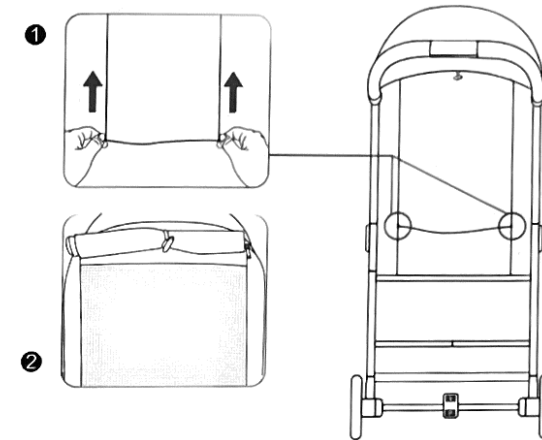

1. To pull the zippers upward on both sides of the window and then roll the window cover to the end to fix it with the elastic strap and oliver button (diagram 1 and diagram 2).
2. Release the elastic strap and zip the cover close the window (diagram 2).

Basket Installation and Removal

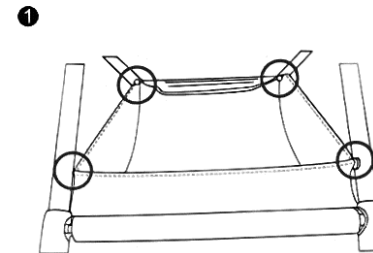

Fit the baskets fixing straps with hooks on frames (4 positions) and fit the fixing strap onto footrest (3 positions), and wrap the back fabric cover with rear crossing tube by velcro (diagram 1).

To remove the basket, take off the fixing straps from all hooks and footrest, release the velcros from backing crossing tubes to take away the basket.

How to adjust the seatback angle

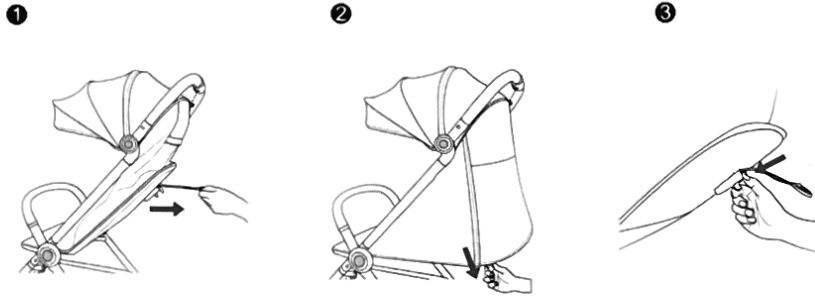

1. Use one hand to pull upwards the seatback adjustable strap to adjust the seatback to upper position (diagram 1)
2. Use to fingers to press inside on the seatback adjusting buttons (diagram 2 and diagram 3) and adjust the seatback to lower positions (desired position)

Leg-rest Adjustment



1. Press on the rest buttons on both sides at the same time(as shown in the red circle) and pull it down to be lower desired positions (diagram 1)
2. Pull the leg-rest upwards to be desired positions (diagram 2)

Car Seat Adapters

An infant car seat can be purchased to converted to a travel system.



TRAVEL SYSTEM (Optional extra)

1. Follow the instruction manual for your stroller! You may attach the infant car seat (Optional extra) on any approved stroller.
Click the infant car seat onto the approved adapter with the child looking towards the parent. Make sure the infant car seat audibly locks in place on both sides.
2. Always check that the infant car seat is firmly connected to the stroller.
To unlock, press and hold both release buttons (18) on the infant car seat and lift it.

NOTE! Please check compatibility of the infant car seat with your stroller manufacturer.

How to operate the brake

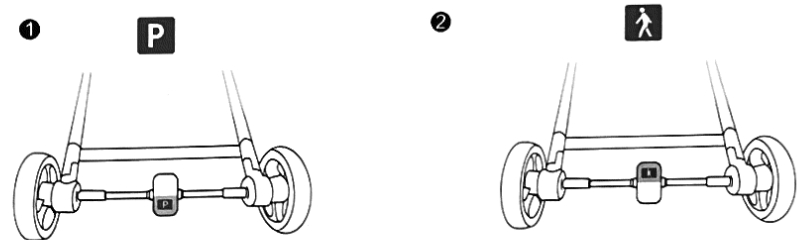

WARNING:

When using the brakes, always ensure the brakes are securely locked.

1. Brake Engage: Step down the brake pedal located on right side to engage the brake until it clicks and locks into place (diagram 1).
2. Release Brake, step down the brake release pedal located on left side to disengage the brake system (diagram 2).

Safety Belt Using and Adjustment

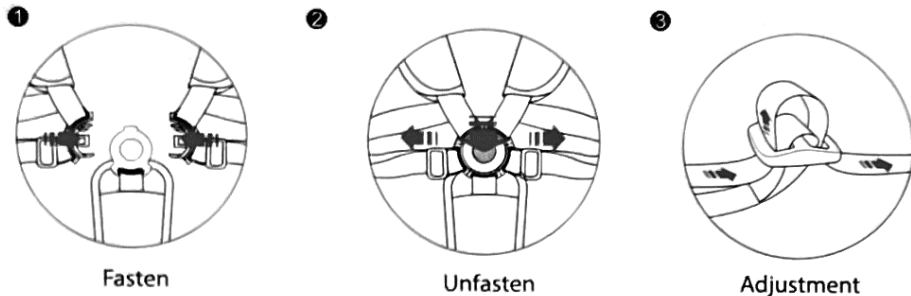

Fasten Buckle:

Assemble the shoulder strap tongue with waist strap tongue, then fit all the plugs into the buckle center and you will hear a firm "click" when they are installed securely (diagram 1).

Unfasten Buckle:

Unfasten Buckle: Press the center button of safety buckle firmly to release all straps (diagram 2).

Safety Strap Adjustment:

Slide up or down the strap through the adjustable button to adjust the shoulder strap, waist strap and crotch strap to be desired length to suit to your baby (diagram 3 and diagram 4).

The stroller has 2 height positions for babies under 6 months in lie-flat position, feed harness tabs through slots (a) in seat unit as shown. For children 6 months+ use the upper height position (b). (diagram 5).

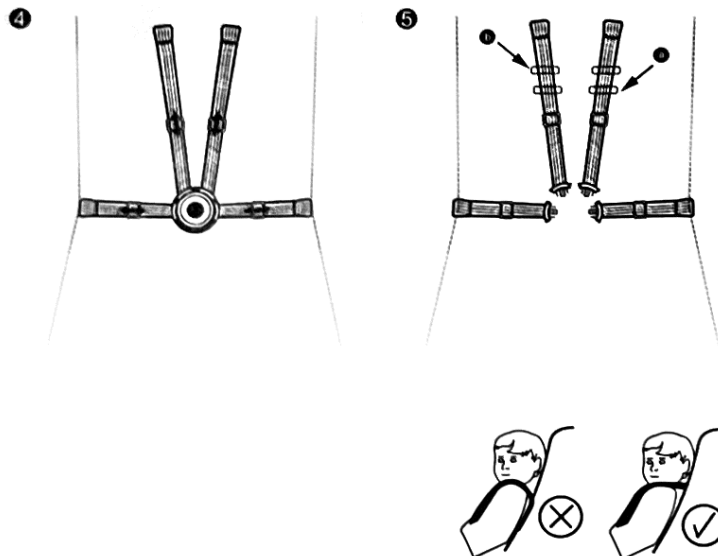

⚠ WARNING!

Always adjust the harness to fit your child correctly for their comfort and safety. A loose fitting harness can be very dangerous.

⚠ WARNING!

Always adjust the shoulder strap height according to baby height and ensure that both straps are at the same height.

Care and Maintenance

- Regularly check the screws, rivets and other fasteners to ensure the firmness and safety. Always replace any defective parts.
- It is important to clean and dry the stroller thoroughly after using in winter, by the sea, in the wild, or in moderate rain. Unremoved sea salt eats away at metal parts. After use in these environments, clean with clean water and dry thoroughly.
- Regularly check the braking device to ensure it's secured and in full working order.
- Maintain the safety of your stroller by seeking prompt repair for bent, torn, worn or broken parts. If any defective parts need to be repaired or replaced, please contact your retailer immediately.
- DO NOT expose this stroller to strong sunlight too long time. Exposure to UV rays may discolor the fabric even in normal use.
- Be careful not to tear the material when moving this stroller. Low viscous oils or lubricants may be used on moving parts. Vaseline is a good lubricant to be used on the front axle.
- Please DO NOT use machine to clean, sponge, neutral detergent and warm water can be used for cleaning. Allow to dry completely before folding or storing away.
- Do not use bleach. Do not iron.

Supplied by Baby Factory(NZ) Ltd.

www.babyfactory.co.nz

