

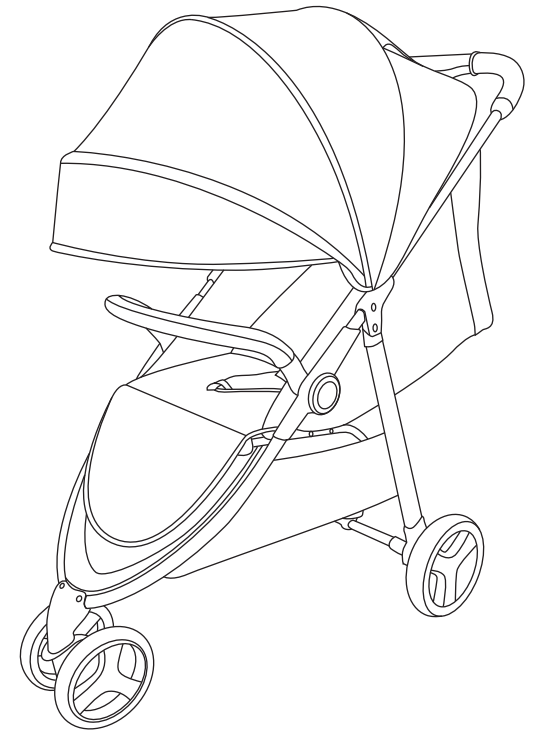

Verve 3 Wheeler

Instruction Manual



**IMPORTANT:
KEEP FOR FUTURE REFERENCE
READ CAREFULLY**



Supplied by:
Babyfactory NZ Ltd.
58 Stonedon Drive, East Tamaki,
Auckland, New Zealand
www.babyfactory.co.nz

Parts List

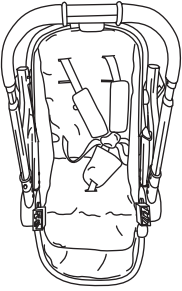
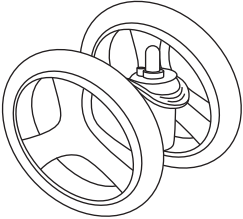
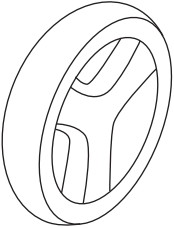
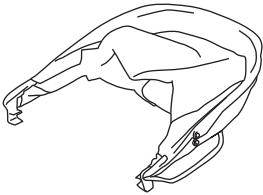
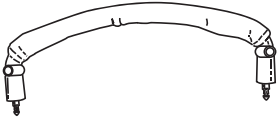
<p>A</p>  <p>stroller x1</p>	<p>B</p>  <p>front wheel x1</p>
<p>C</p>  <p>rear wheel x2</p>	<p>D</p>  <p>canopy x1</p>
<p>E</p>  <p>bumper bar x1</p>	

Care

Maintenance

- The product requires regular maintenance to ensure correct and safe performance.
- Regularly inspect the wheels, locks, brakes, harness, catches, seat adjusters, joints and fixings to ensure they are clean, operating correctly and in full working order.
- Replace tyres if they are excessively worn.
- Do not use this product if any part is broken, torn or missing and use only spares provided by the manufacturer.
- If parts become stiff or difficult to operate, ensure dirt is not the cause, then try a light application of a silicon lubricant, ensuring it penetrates between the components.
- Regular lubrication of moving parts will extend the life of your product and make opening and folding easier.
- Your stroller should be serviced and reconditioned before using for a second baby, or within 18 months, whichever is sooner.
- After exposure to damp conditions, dry off with a soft cloth and leave fully open in a warm environment. Storing damp will encourage mildew to form. Store in a dry place.
- Do not leave in sunlight for prolonged periods - some fabrics may fade.

Cleaning

- Fabrics: Spot clean only. Use mild soap or upholstery shampoo. NEVER use bleach. Dry in shade thoroughly before reuse and avoid direct heat and sunlight. Do not iron. Do not dry clean.
- Frame: Wipe frame with a soft clean cloth and mild soap. NEVER use bleach.
- Never clean any part of the stroller with abrasive, ammonia based, bleach based or spirit type cleaners.
- Ensure the product is fully dry before use or storage.
- Always ensure the stroller is stored in a dry place to prevent mold or mildew developing. Store away from any heat sources and not in the sun.

Safety

- Always apply the parking brake when the stroller is stationary.
- Ensure the parking brake is engaged during the loading and unloading of children.
- Do not allow your child to climb into the stroller.
- Never leave a raincover, hood or apron on indoors, in a hot atmosphere or near a heat source as your child may overheat.
- Be careful when going up or down kerbs.
- Remove your child and fold the stroller when going up or down escalators.
- If your stroller is used by someone unfamiliar with it e.g. Grandparents, always show them how it works.
- Do not use this stroller near an open fire or exposed flame.
- Take care in windy conditions.
- To prevent damage, always remove a raincover before folding the stroller.
- Do not place anything on top of a raincover.
- To prevent your child overheating, always fold or remove a raincover when indoors or in warm environments.
- A basket is provided for the carriage of 3kg of items evenly distributed.
- This product conforms to EN 1888:2012

Unfolding

Unpack all contents and check that all parts are present before starting assembly. Please refer to the parts list.

1. Release the pram (A) from the locked position by lifting the locking catch from over the locking rivet on the frame.
2. Standing behind the pram, lift the handle to open the frame.
3. The pram will 'click' when locked into position.

WARNING! Ensure the pram lock is fully engaged before placing child in the pram.

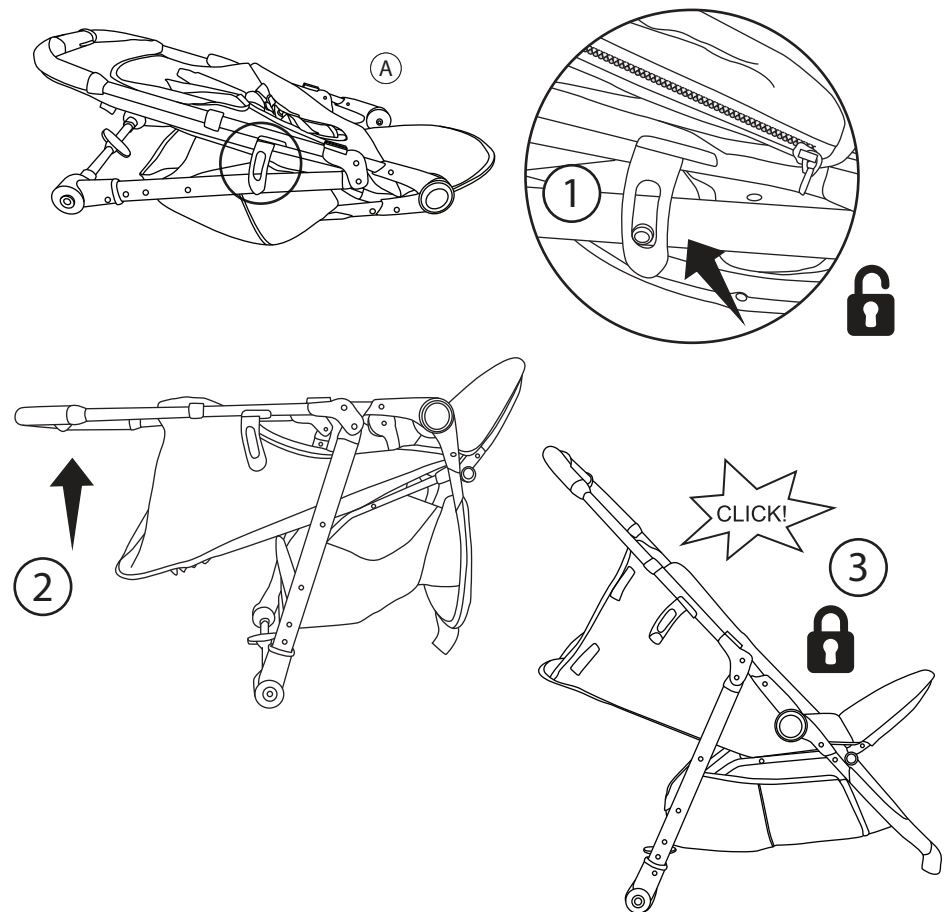

Assembly

1a. Insert the front wheel (B) pin into the center of the socket until you hear a 'click'. Give the wheel a firm tug to ensure that it is securely attached.

1b. To remove the front wheel, simply press the button at the back of the wheel socket and pull.

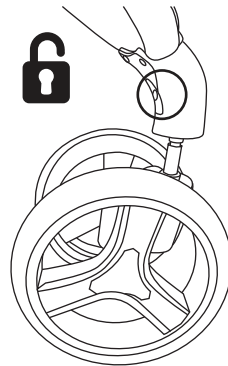
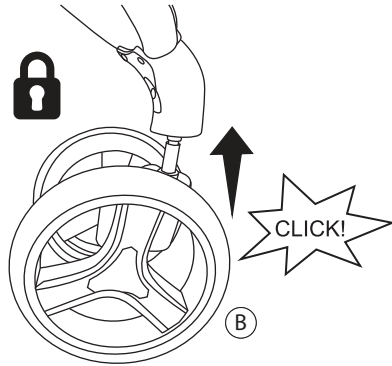

2a. Push each rear wheel (C) into the sides of the rear wheel axle until you hear a 'click'. Give them a tug to ensure they are attached securely.

2b. To remove the rear wheels, simply press the clip located on the rear wheel axle and pull the wheel off.

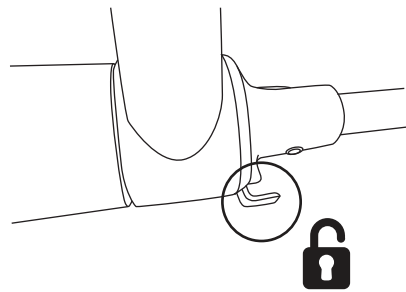
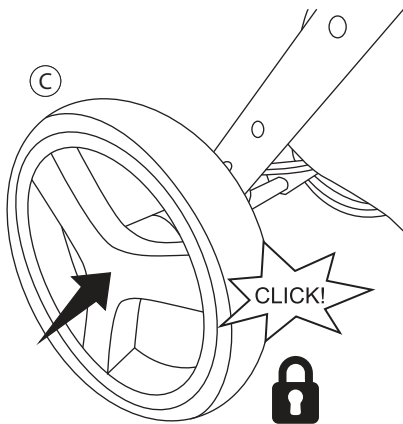

Safety

IMPORTANT: KEEP FOR FUTURE REFERENCE. READ CAREFULLY

⚠ WARNING:

- Read these instructions carefully before assembly and use and keep for future reference. The child may be hurt if you do not follow these instructions.
- This vehicle is intended for one child from birth (0 months) and up to a maximum weight of 15 kg.
- Never leave your child unattended.
- Ensure that all locking devices are engaged before use.
- To avoid injury ensure that your child is kept away when unfolding and folding this product.
- Do not let your child play with this product.
- ALWAYS USE THE HARNESS RESTRAINT SYSTEM.
- Always use the crotch strap in combination with the waist belt section of the harness.
- This product is not suitable for running or skating.
- Use the most reclined position for new born babies.
- Any load attached to the handle affects the stability of the stroller.
- YOUR CHILD'S SAFETY IS YOUR RESPONSIBILITY.
- Do not let children play with or hang on the stroller.
- Do not overload this stroller with additional children, goods or accessories.
- Bags and other items should not be hung from the handle as this can affect the stability of the stroller.
- Overloading, incorrect folding and the use of non-approved accessories is unsafe and may damage or break this stroller.
- Do not use parts or accessories which are not approved by the manufacturer.

Folding

1. Fold the canopy
2. Slide the folding button across.
3. At the same time, push up the safety lock.
4. And push the stroller handle down until the lock engages with a 'click'.

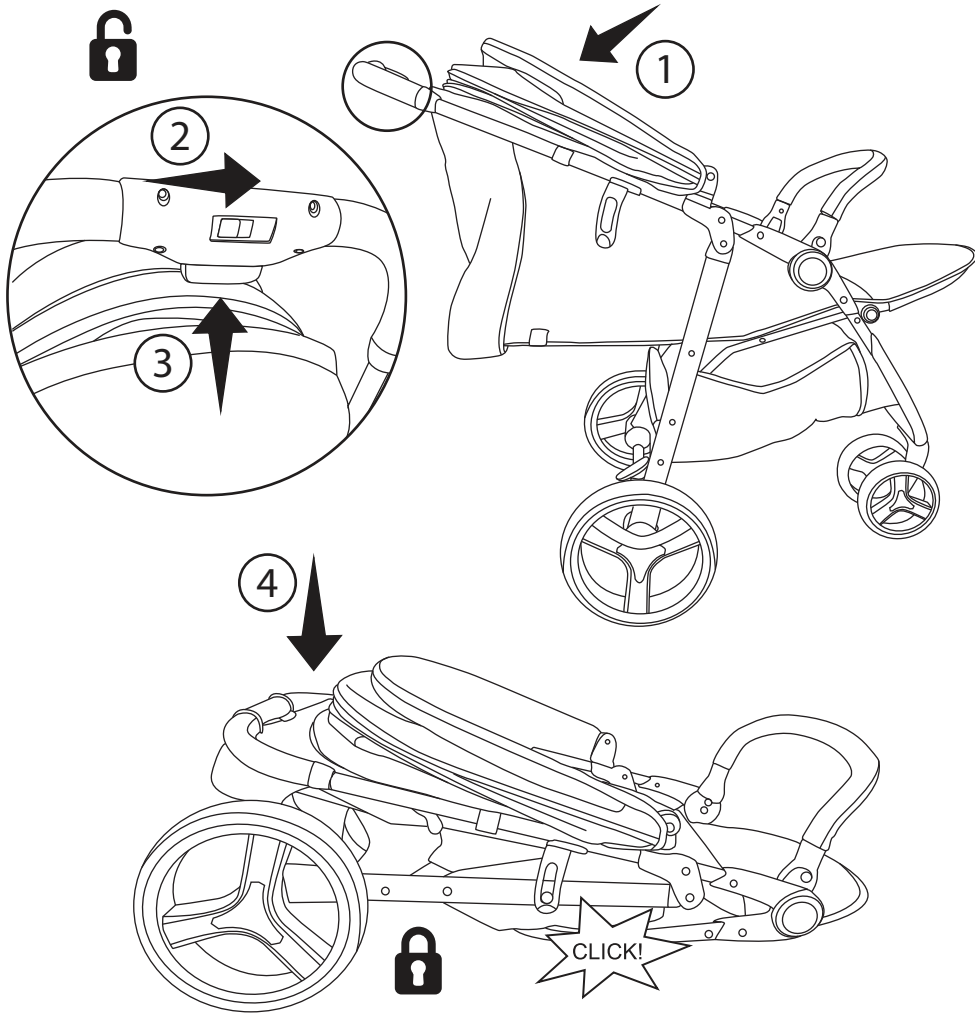

Assembly

3. Attach the canopy (D) to the pram. Line up the canopy connectors with the guides on the pram frame. Slide the connectors into the guides to secure.

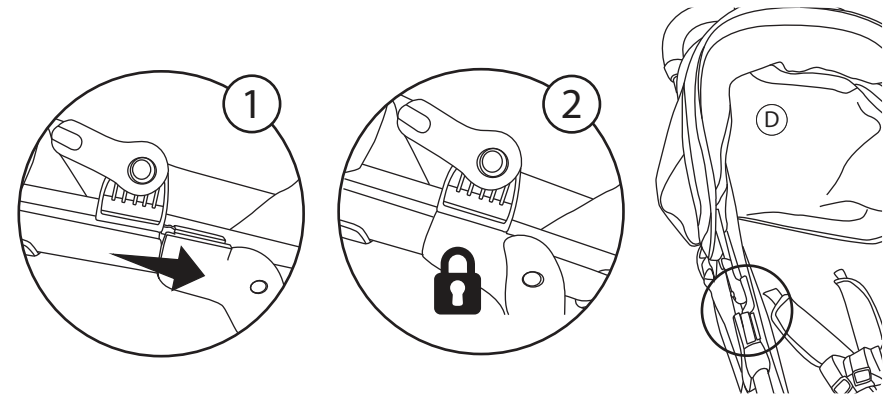

- 4a. Insert the ends of the bumper bar (E) into the attachment points on the pram frame. Wait to hear them 'click' into position. Lift gently to ensure it is locked into place.

- 4b. To remove, press the buttons located either side of the bumper bar housing.

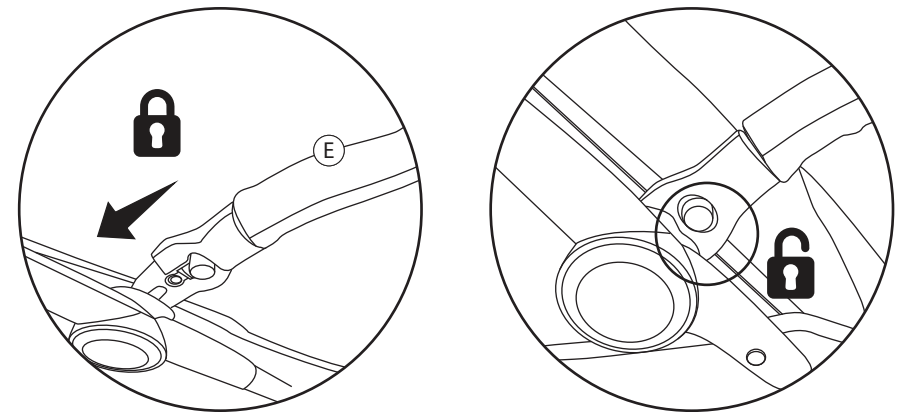

Backrest Adjustment

1. Locate the backrest adjustment mechanism at the rear of the seat.

Squeeze the clip on the webbing strap.

2. Slide the clip up or down the webbing strap to gently pull up or lower the backrest. Release the clip at desired backrest recline.

WARNING! Always ensure that the seat is securely fixed in position before use.

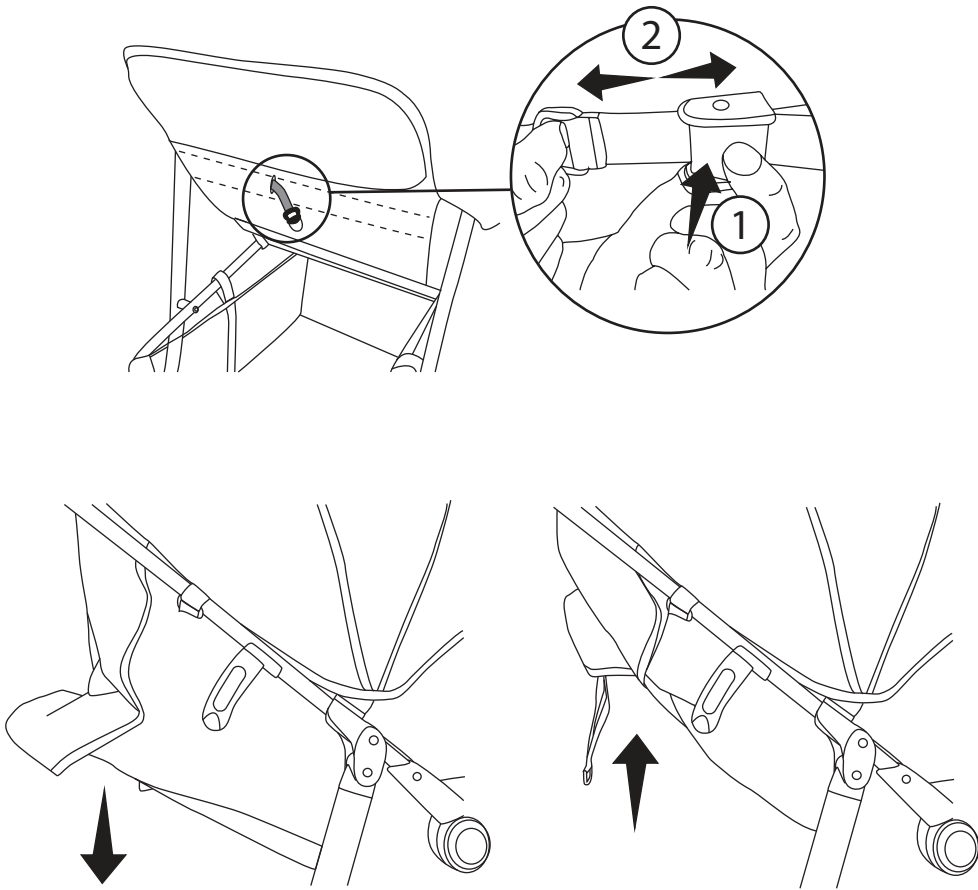

Swivel Wheels

When travelling along straight surfaces or uneven terrain, the front wheel may spin.

To lock the front swivel wheel into place, press down on pedal at the front of the wheel.

To go back to 360° swivel mode, pull up the pedal.

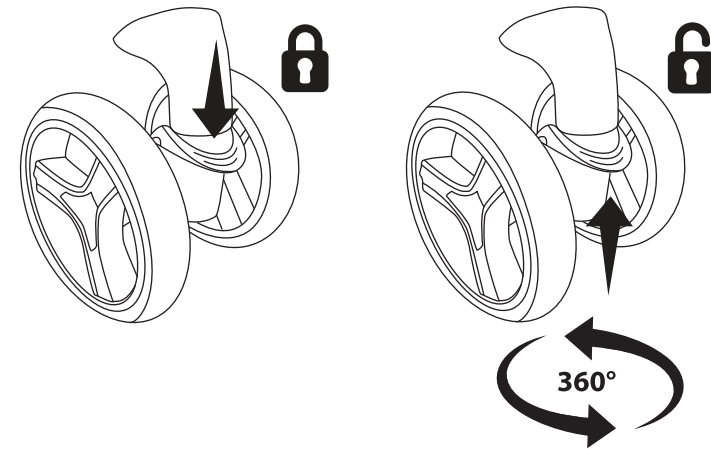

Brakes

To engage the brake push down brake locking pedal. Lift up pedal to release brake. The brake will 'click' when locked into position.

WARNING! Always apply the parking brake when the stroller is stationary.

WARNING! Ensure the parking brake is engaged during the loading and unloading of children.

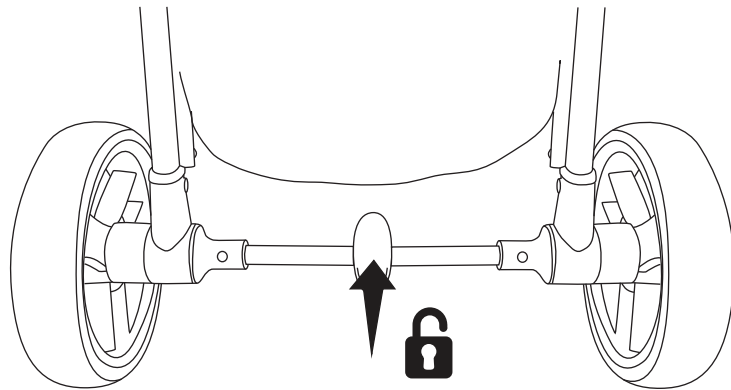
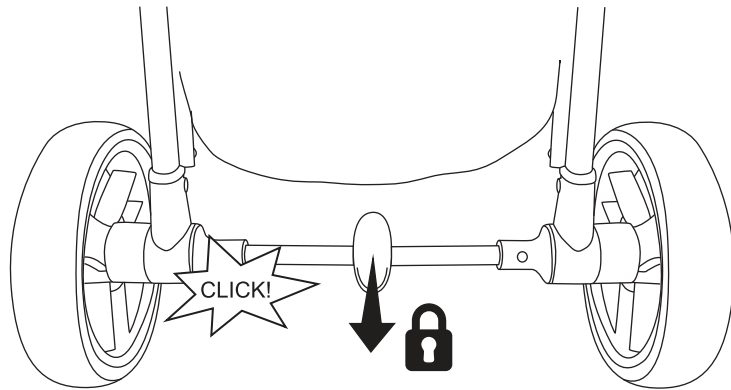

Footrest Adjustment

Press on each adjuster in turn while simultaneously pressing down lightly on the footrest.

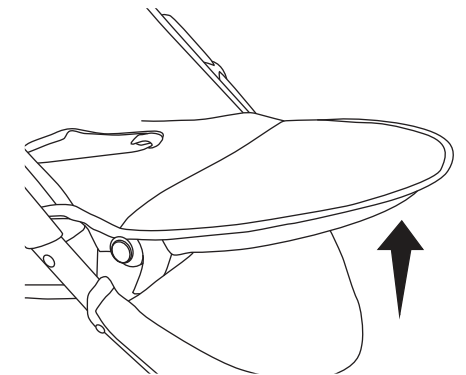
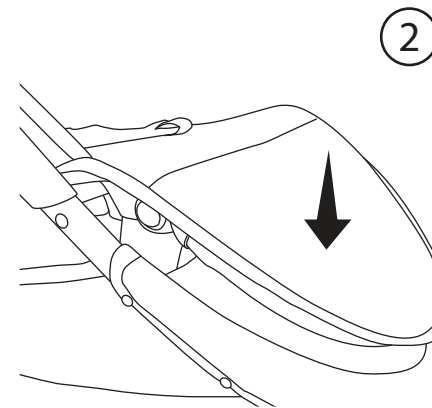
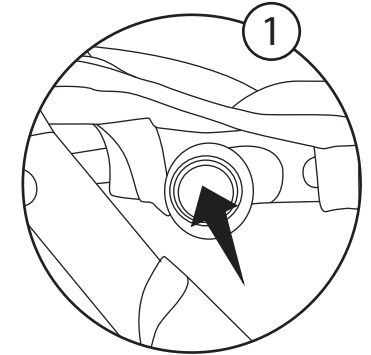
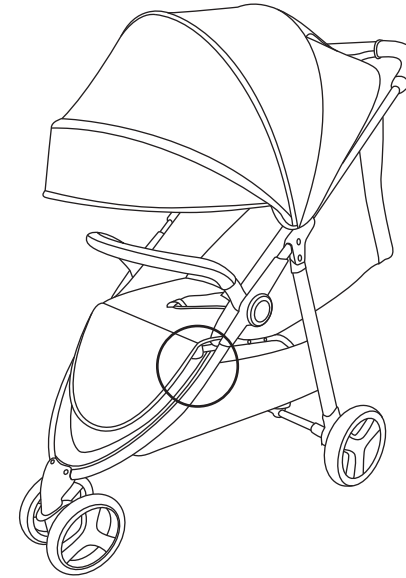

Harness

1. Slide the shoulder strap buckle onto the housing of the waist strap buckle. Repeat for the other side.
2. Insert the completed buckle into the buckle housing until it engages securely in place. Listen for the 'click'. Repeat for the opposite side.

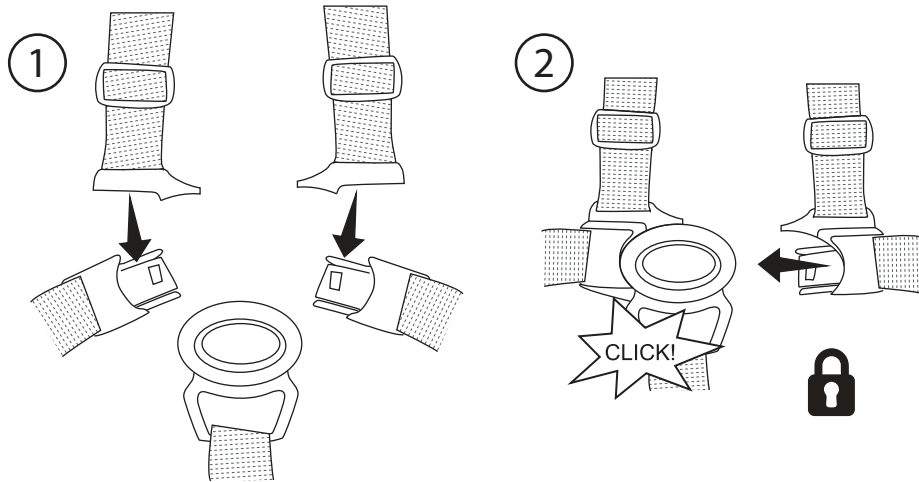

3. Press the centre button to release child from harness.

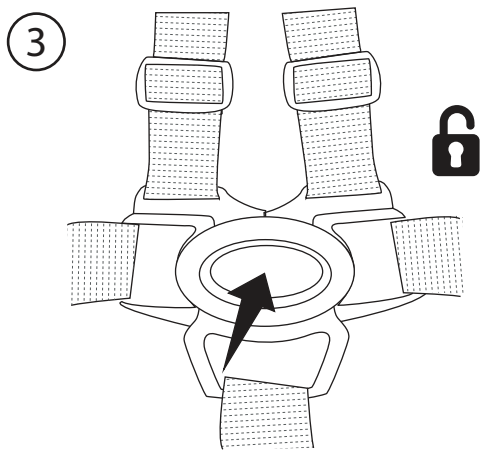

Harness

4. To adjust the shoulder straps, move the slides as shown.
WARNING! Always adjust the harness to fit your child correctly for their comfort and safety. A loose fitting harness can be very dangerous.
5. The stroller has 3 shoulder height positions. Undo the harness and remove the shoulder pads to adjust the shoulder height. Remove harness strap from webbing holders. Redo harness.
WARNING! Adjust the shoulder strap height according to baby height.

