

Maintenance

This product requires regular maintenance to ensure correct and safe performance.

Regularly inspect the wheels, locks, brakes, harness, catches, seat adjusters, joints and fixings to ensure they are clean, secure and in full working order. Replace tyres if they are excessively worn.

If parts become stiff or difficult to operate, ensure dirt is not the cause, then try a light application of a silicon lubricant, ensuring it penetrates between the components. Regular lubrication of moving parts will extend the life of your product and make opening and folding easier.

Your stroller should be serviced and reconditioned before using for a second baby, or within 18 months, whichever is sooner.

After exposure to damp conditions, dry off with a soft cloth and leave fully open in a warm environment. Storing damp will encourage mildew to form. Store in a dry place.

Do not leave in sunlight for prolonged periods - some fabrics may fade.

Cleaning

Plastic and metal parts may be sponged lightly using warm water and a mild detergent.

Dry thoroughly before storing.

Refer to sewn in labels for fabric care instructions.

Never clean any part of the product with abrasive, ammonia based, bleach based or spirit type cleaners.

Sky Stroller

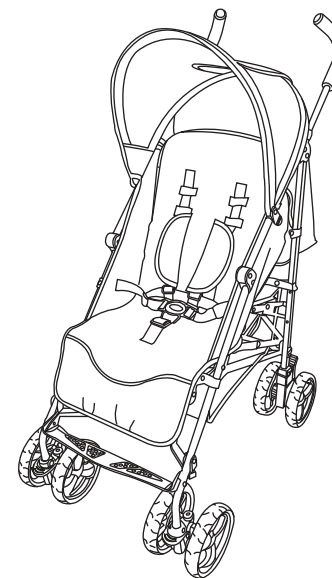

**IMPORTANT:
RETAIN FOR FUTURE REFERENCE
READ CAREFULLY**

Specification of product

Age	0 Months+
Load capacity	Under 17 kgs
No. of passenger	1 person
Weight	Approx. 6.9 kgs
Assembled Size	90(L)cm x 47(W)cm x 102(H)cm

Parts

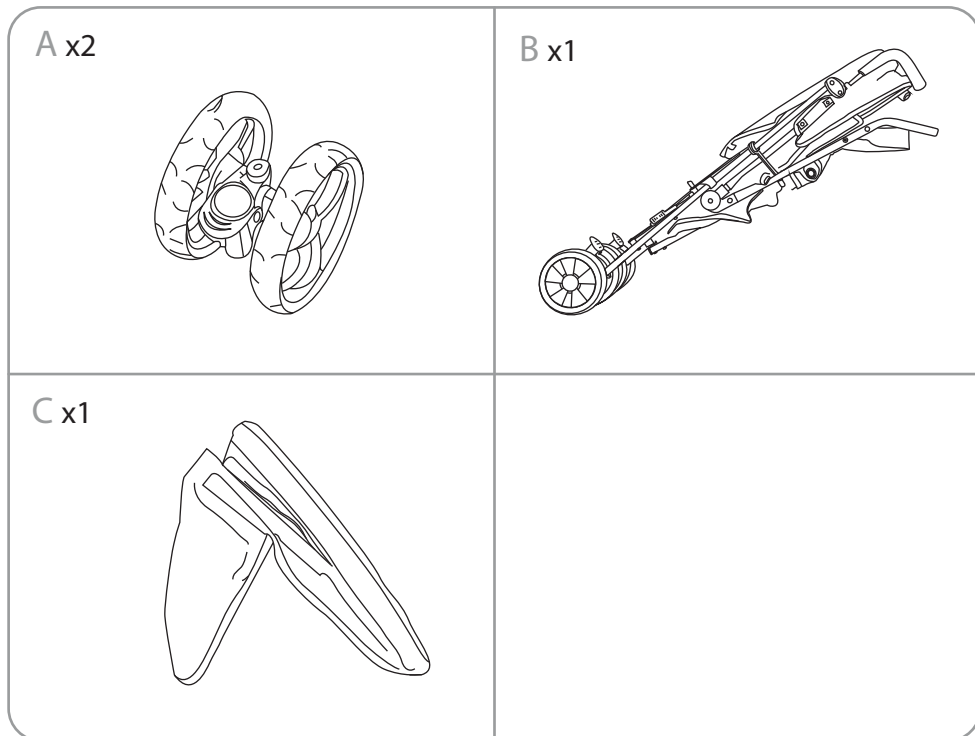

⚠Warning! Safety

- Be aware of the risk of open fire and other sources of heat, such as electric bar fires, gas fires etc. in the vicinity of the stroller.
 - It may be unsafe to use any accessories other than those approved by the manufacturer.
 - Lift and carry the stroller safely. Please ensure all locking devices are engaged before lifting stroller - injuries can occur from moving parts. Only carry stroller if folded and locking or storage latches are engaged. Please apply storage latch if latch does not engage automatically.
 - Never leave a raincover, hood or apron on the product indoors, in a hot atmosphere or near a heat source, as your child may overheat.
 - This product is intended for domestic use only. It is not for commercial use.
- This product complies with AS/NZS 2088:2013.

Warning! Safety

⚠️ WARNING: USE THE TETHER STRAPS TO STOP THE STROLLER ROLLING AWAY.

Remember, your child safety is your responsibility:

- Always fit and use the tether strap when the stroller is in use.
- When using the stroller, always ensure your hand is positioned in and around the tether strap. The strap is a compulsory safety feature which must be used at all times. It is for the safety and benefit of your child.
- The correct use and maintenance of this stroller are essential.
- Be sure that all clamps and buckles are securely fixed and in place before use.
- When in the stroller, your child must always wear the safety harness, correctly fitted and adjusted, at all times.
- Always use the harness correctly fitted and adjusted, with your child in the seat.
- Never leave the harness buckles when not fitted to a child in the stroller because the harness can form loops which may pose a strangulation hazard.
- The maximum weight of the child for which this stroller is intended is 17kg.
- The stroller will become unstable if the manufacturer's recommended load is exceeded.
- Use the stroller on flat or gentle sloping surfaces. It may be unstable on higher sloping and uneven surfaces - be aware of the possibility of the stroller tipping over.
- Care should be taken if the stroller is used on stairs or escalators.
- Care must be taken when folding and unfolding the product to prevent finger entrapment.
- This product is suitable to be used with a new born baby. Please ensure the seat is in its full recline position when using with a new born child.
- Check all parts before use for breakage or fatigue. Discontinue use immediately if any part is found to be damaged or broken.
- Maximum load of basket is 2kg.
- Do not carry additional children. This stroller is manufactured for the use with one child only.
- Always be aware of the risks provided by fire and other significant sources of heat such as radiators etc. which may be in the immediate vicinity of your stroller.

Assembly

1. Release the stroller (B) from the locked position by lifting the locking catch from over the locking rivet on the stroller frame.
HINT. You may have to squeeze the stroller legs and handles together first so as to release the tension on the rivet.
Standing behind the stroller and holding it by the handles, allow the wheel pins to fall forward. With your foot, press down on the locking bar pedal until the entire frame locks into the open position.

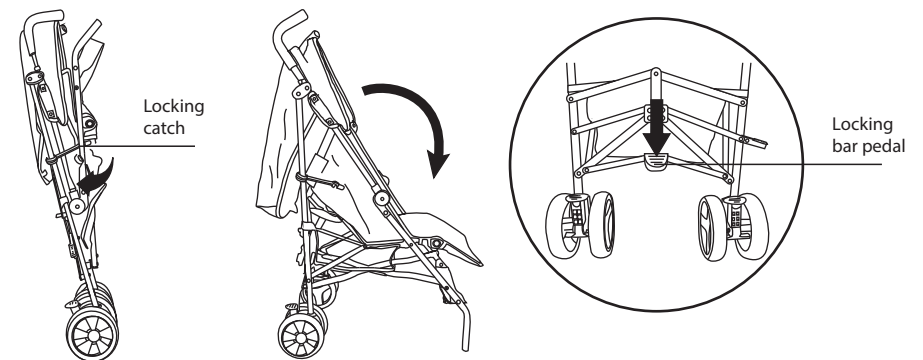

2. To attach the front swivel wheels (A), insert wheel housing onto the front leg and push upward until you hear it lock into position. Repeat for other leg.

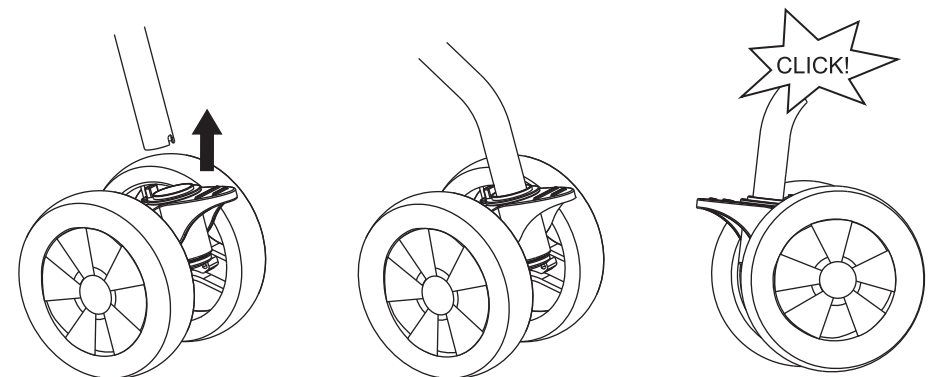

Assembly

3. To attach the canopy (C), place the canopy on the chassis, inline with the seat unit. Attach both the plastic connector posts onto each side of the chassis just below the velcro tabs. Stick the velcro tabs together.

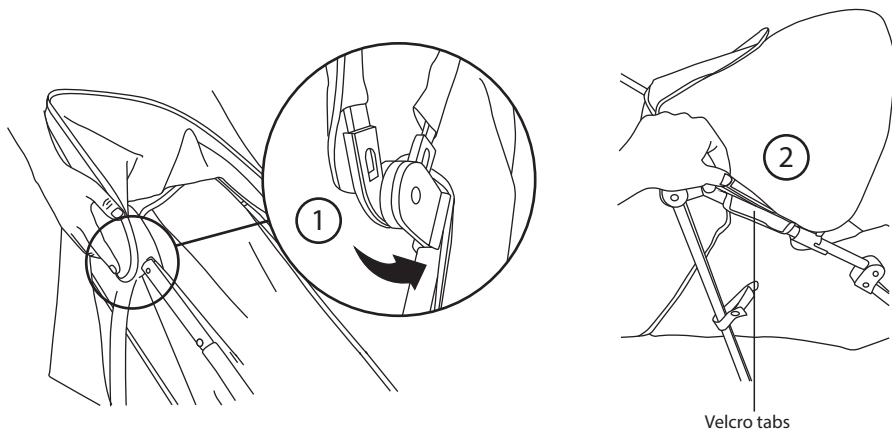

4. Ensure the straps at the rear of the stroller seat and basket are attached to the back frame with press studs.

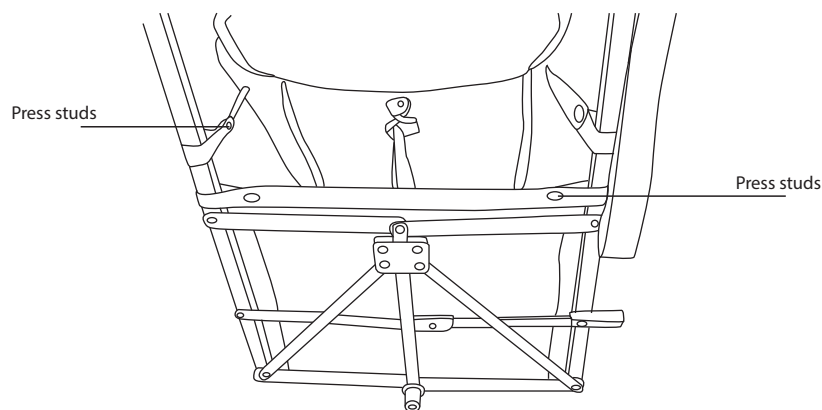

Warning! Safety

⚠ WARNING: TO AVOID INJURY OR DEATH READ THESE INSTRUCTIONS CAREFULLY BEFORE USE AND KEEP FOR FUTURE REFERENCE. THE CHILD MAY BE HURT IF YOU DO NOT FOLLOW THESE INSTRUCTIONS.

⚠ WARNING: FOLLOW THE MANUFACTURERS INSTRUCTIONS.

⚠ WARNING: ALWAYS APPLY THE BRAKES WHENEVER THE STROLLER IS STATIONARY.

⚠ WARNING: DO NOT LEAVE THE CHILD UNATTENDED.

⚠ WARNING: SECURE THE CHILD IN THE HARNESS AT ALL TIMES.

⚠ WARNING: DO NOT CARRY EXTRA CHILDREN OR BAGS ON THIS STROLLER.

⚠ WARNING: MAKE SURE CHILDREN ARE CLEAR OF ANY MOVING PARTS IF YOU ADJUST THE STROLLER OTHERWISE THEY MAY BE INJURED.

⚠ WARNING: USE THE HARNESS AT ALL TIMES.

Backrest Adjustment

Locate backrest adjustment mechanism at the rear of the seat, squeeze the clip on the reclining harness and gently lower the backrest.

To raise the backrest, squeeze the clip on the reclining harness and gently pull up the backrest to desired height.

WARNING! Always ensure that the seat is securely fixed in position before use.

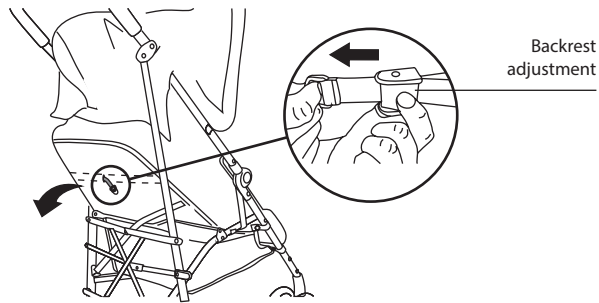

Folding

To fold, lift the pedal upwards and push down the second lock pedal with your foot. Push the handles over to a close. Lock the stroller locking catch located on the side of your stroller.

NOTE. Always fold your canopy before folding your stroller.

NOTE. Always ensure the backrest is in its full, upright position.

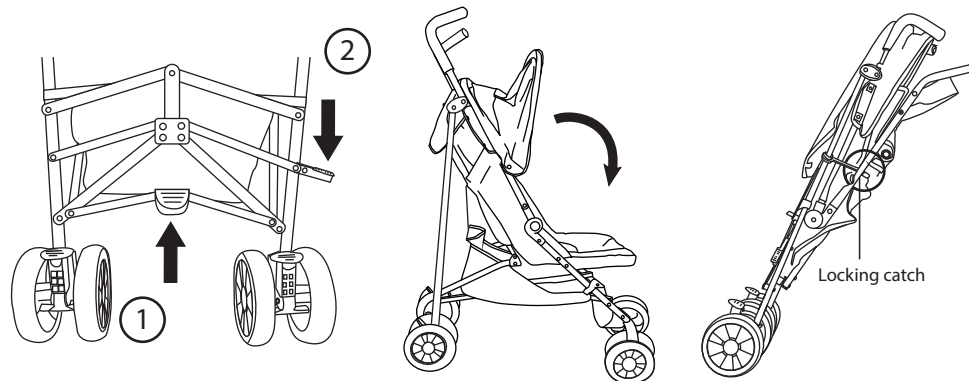

Canopy Adjustment

Your canopy can be opened or closed by pulling the canopy rim forward or pushing backwards.

Your canopy has a viewing window to see baby.

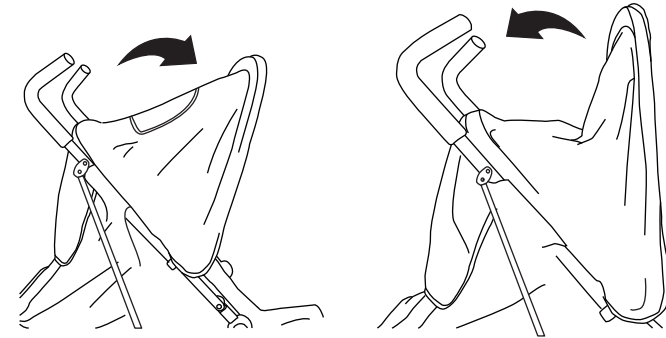

Footrest Adjustment

Press on each adjuster in turn while simultaneously pressing down lightly on the footrest.

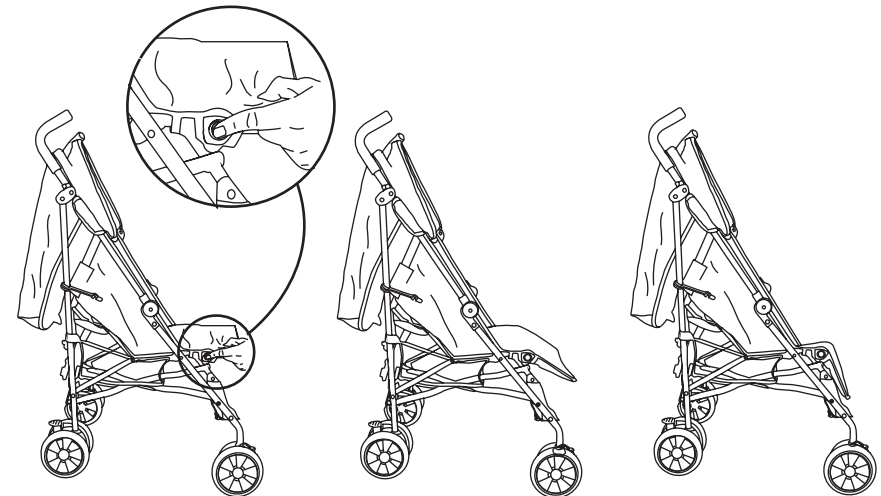

Harness

Slide the shoulder strap buckle (1) into the housing of the waist strap buckle (2). Repeat for the other side.

Insert the completed buckle (3) into the buckle housing (4) until it engages securely in place. Repeat for the opposite side.

To adjust the shoulder straps (5), move the slides as shown.

To adjust the shoulder height, remove strap from the webbing holders (6) as shown.

WARNING! Always use the harness and ensure it is correctly fitted securely while child is in the seat.

WARNING! Adjust the shoulder strap length according to baby height.

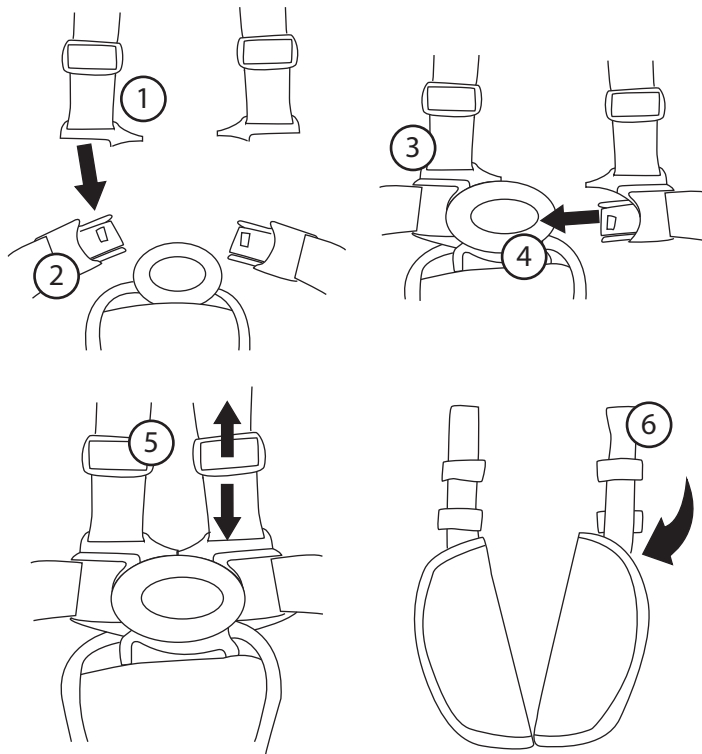

Swivel Wheels

Your stroller has swivel wheels. To lock swivel wheels press the pedal down to secure. Repeat on both wheels. Push up to release.

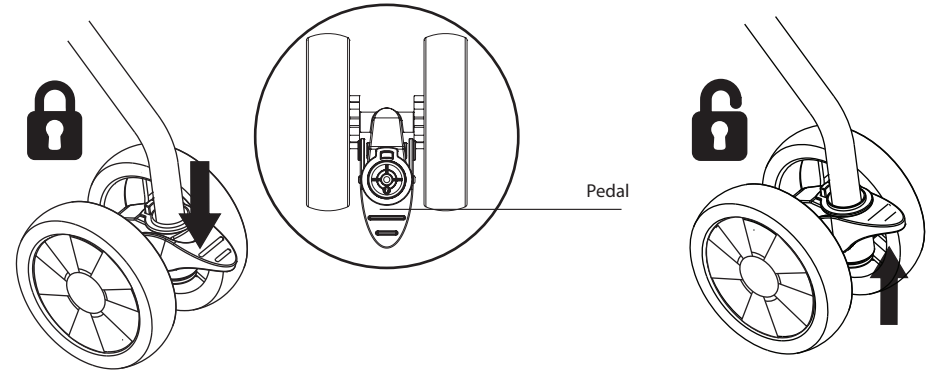

Brakes

To engage the brake push down brake locking pedals. Lift up pedals to release brake.

WARNING! Always engage wheel brakes when the stroller is not moving.

WARNING! Always ensure both levers are locked in position securely.

