



# Maxigrow

## Car Seat

### Instruction Manual

ECE R44/04

9-36kg

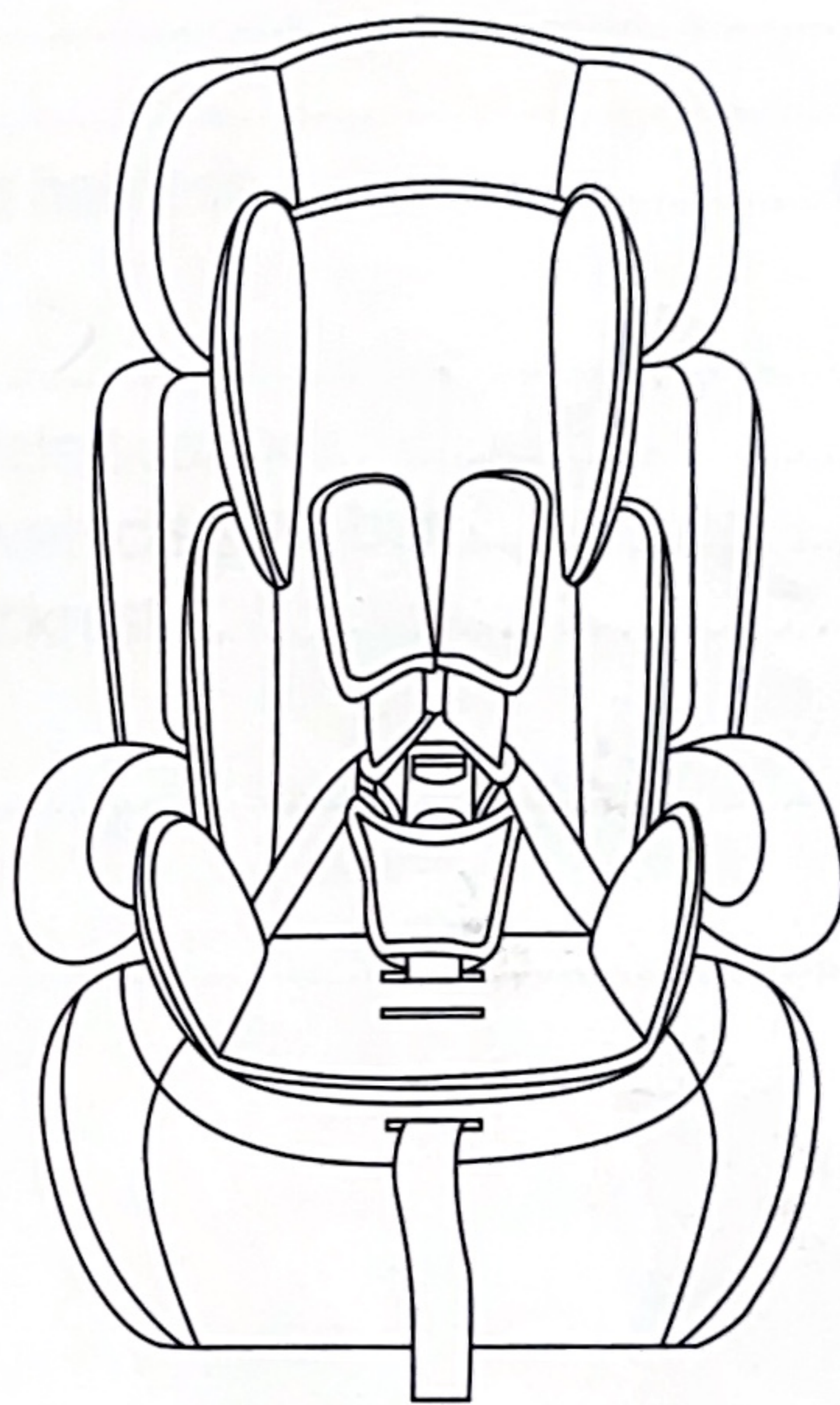

**IMPORTANT:**

**READ CAREFULLY AND**

**KEEP FOR FUTURE REFERENCE**

# Contents

---

Contents.....	02
Safety.....	03-05
Installation positions .....	06
Parts List .....	07
Adjusting the car seat.....	08
1. Adjusting the buckle.....	08
2. Adjusting the harness.....	08
3. Adjusting the headrest.....	09
4. Removing and installing the 5-point harness .....	09-10
Installation.....	11
5. Group 1 (9-18kg) with a 3-point vehicle seat belt .....	11-12
6. Group 2/3 (15-36kg) with a 3-point vehicle seat belt.....	12-13
7. Group 2/3 (15-36kg) without the backrest.....	14
Care and maintenance .....	15
Troubleshooting .....	16

---

## Safety

### Notice

This is a "Universal" car seat, and is approved to ECE Regulation R44, for general use in motor vehicles. A correct fit is likely if the vehicle manufacturer has declared in the vehicle hand book that the vehicle is suitable to accept a "Universal" child restraint for this age group and weight.

This car seat has been declared as "Universal" under more stringent test conditions than those applied to earlier designs which do not carry this notice.

If in doubt, please contact your retailer or the manufacturer.

This car seat can only be used if your vehicle is fitted with a 3-point vehicle seat belt approved to UN/ECE Regulation No. 16 or other equivalent standards.

**IMPORTANT! READ CAREFULLY BEFORE USE AND KEEP FOR FUTURE REFERENCE.** Read this user manual **BEFORE** installing your car seat. **Incorrect installation could endanger your child. Please always keep the instruction manual with the car seat for future reference.**

**WARNING!** NO child restraint can guarantee full protection from injury in an accident. However, proper use of a child restraint will **reduce** the risk of serious injury or death to your child.

**WARNING!** Assembly and installation operations **must be** carried out by adults.

**WARNING!** For the correct usage of the airbag in **combination** with the seat; read the vehicle handbook.

**WARNING!** DO NOT allow child restraint straps to **become** twisted, keep them flat.

## Safety

**WARNING!** DO NOT install or use this car seat without following the instructions in this manual or you may put your child at serious risk of injury or death.

**WARNING!** DO NOT make any modifications to this car seat or use it along with component parts from other manufacturers.

**WARNING!** When using this child restraint system, the belt must be used correctly; make sure that the lap belt is not above the child's belly.

**WARNING!** DO NOT leave this car seat unsecured in your vehicle because an unsecured car seat can be thrown around and may injure occupants in a sharp turn, sudden stop, or collision. Remove it if not in regular use.

**WARNING!** DO NOT use this child restraint without the seat cover.

**WARNING!** The seat cover should not be replaced with any seat cover besides the ones recommended by the manufacturer. The seat cover constitute an integral part of the child restraint performance.

**WARNING!** DO NOT put anything other than the recommended seat cover in this child restraint.

**WARNING!** DO NOT allow the car restraint harness or belt guide to become trapped or caught in the vehicle seat or door.

**WARNING:** NEVER leave your child unattended with a child restraint.

**WARNING!** NEVER use a second-hand car seat or a car seat whose history you do not know because they may have structural damage that endangers your child's safety.

**WARNING!** Please keep this child restraint away from sunlight, otherwise it may be too hot for the child's skin.

**WARNING!** DO NOT place other items on top of the car seat if it is in the car boot to prevent damage.

**WARNING!** DO NOT continue to use this car seat after it has suffered any violent crash. Replace immediately as there may be invisible structural damage from the crash.

**WARNING!** Remove this car seat from the vehicle seat when it is not in use.

**WARNING!** To avoid suffocation, remove plastic bag and packaging materials before using this product.

# Safety

**WARNING!** The plastic bag and packaging materials should then be kept away from babies and children.

**WARNING!** Consult the retailer for issues concerning maintenance repair and part replacement.

**WARNING!** DO NOT install this car seat under the following conditions: vehicle seats facing sideways or rearward with respect to the running direction of the vehicle. Vehicle seats movable during installation.

**WARNING!** In case of emergency or accidents, it is most important to have your child taken care of with first aid and medical treatment immediately.

The Babylo Maxigrow Car Seat is suitable for:

Group	Weight	Approx. Age	Child Restraint Direction	Fittings Methods
I	9-18 kg	9 mths - 4 yrs	Forward-facing	3-point seat belt
II	15-25 kg	3 to 7 yrs		
III	22-36 kg	6 to 12 yrs		

# Installation Positions

In the vehicle rear seats. ✓

This child safety seat may only be installed in front seats in the following circumstances:

1. If the vehicle is not equipped with rear seats.
2. If all rear seats are already occupied by children exceeding 135cm in height.
3. If it is not possible to install all child restraint systems in the rear seats.

## Notice

- If your center rear passenger seat is only fitted with a 2-point lap belt the child safety seat must not be used. It is only suitable with a 3-point safety belt. ?1



- ✓ 3-point belt
- ✗ 2-point belt
- A Diagonal belt
- B Lap belt



**! WARNING!**  
Refer to the vehicle's instruction manual to install the seat in the front seat.

# Parts List

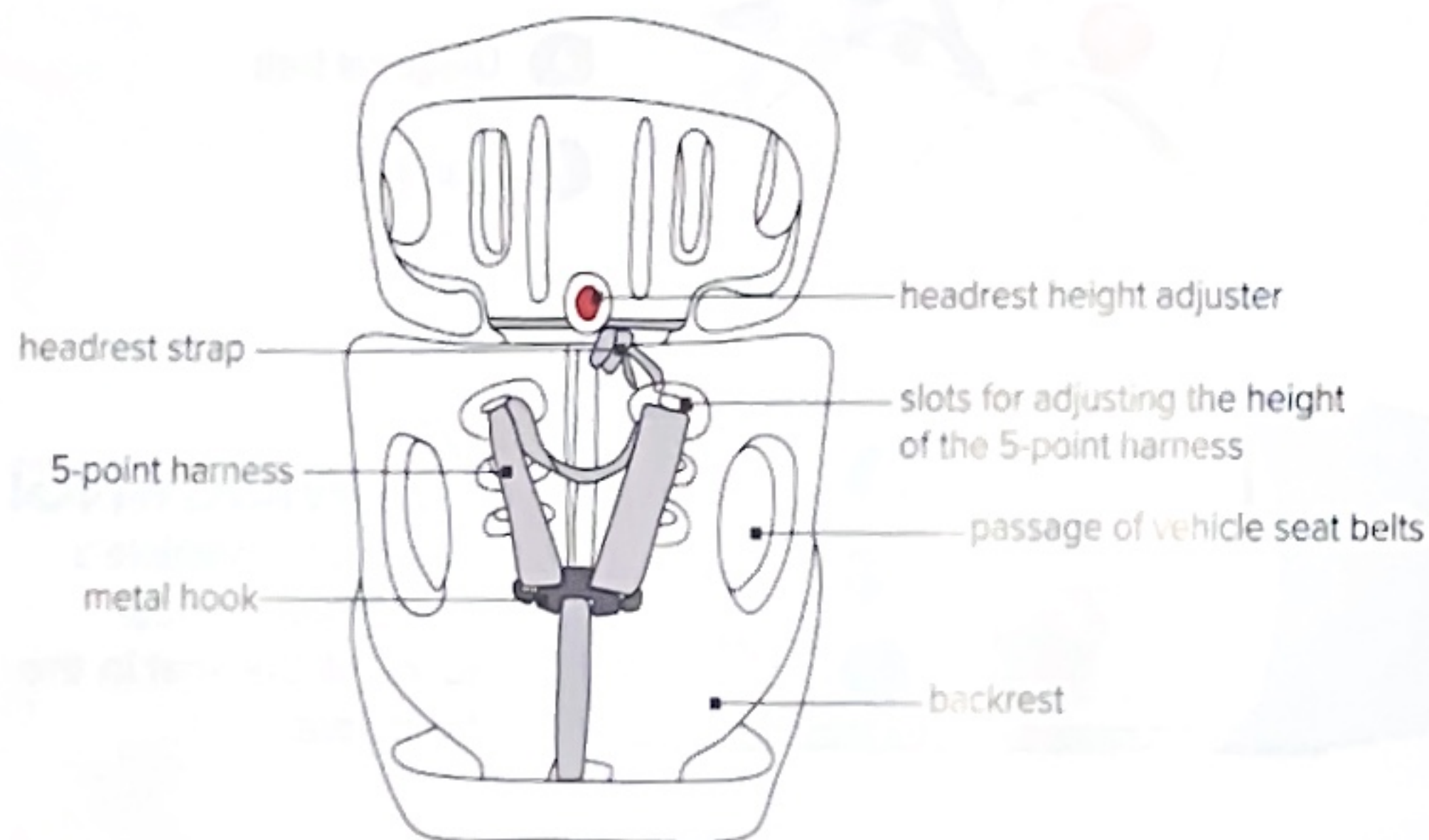
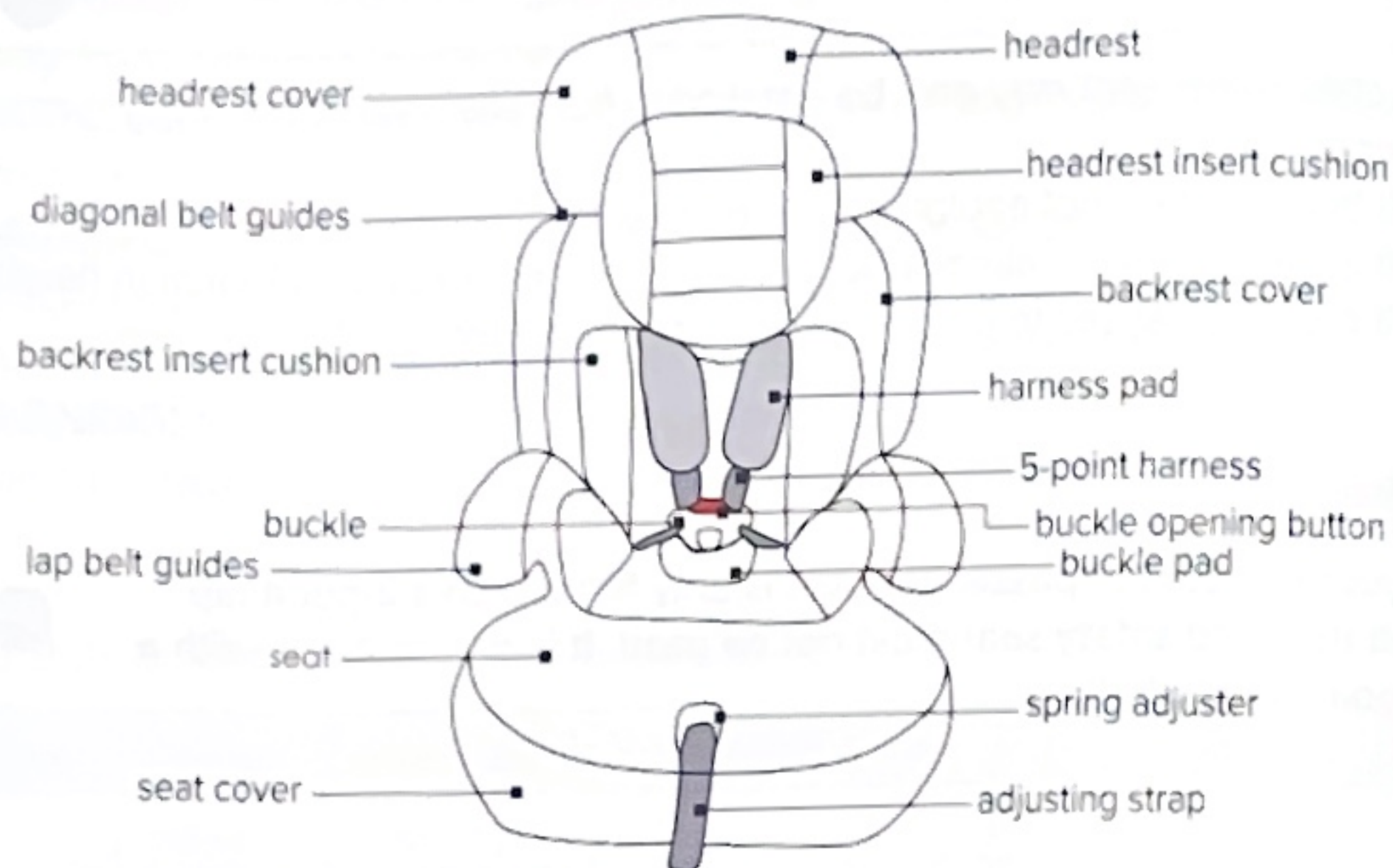

# Adjusting the Car Seat

## 1. Adjusting the buckle

**Open buckle:**  
Press red button until buckle latches are released from the buckle (fig. 1)

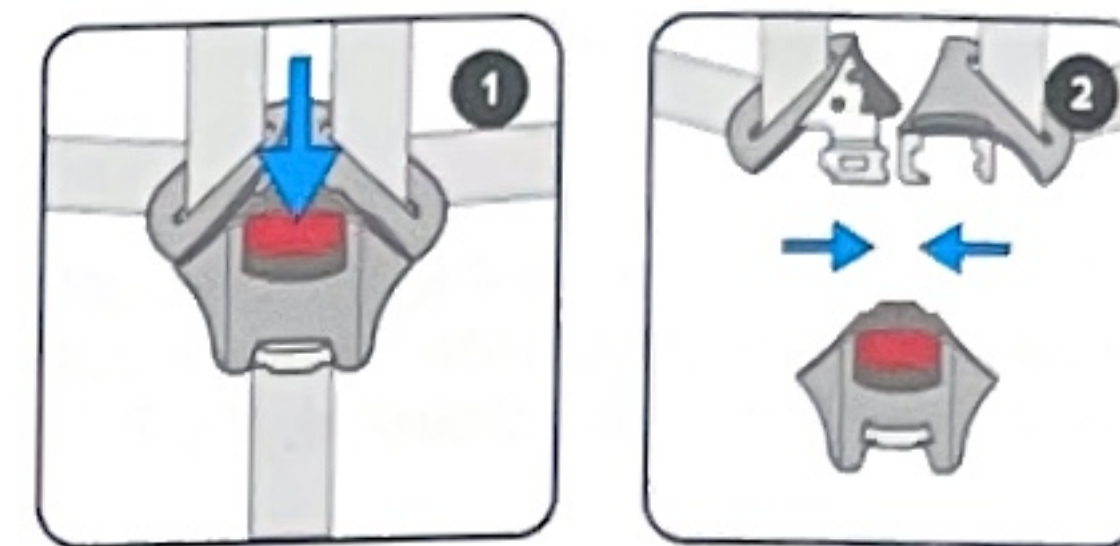

**Lock buckle:**  
Guide the two buckle latches together (fig. 2), putting them into the harness buckle house (fig. 3). A "click" will signal when locked. Note. The buckle will not lock with one latch only.

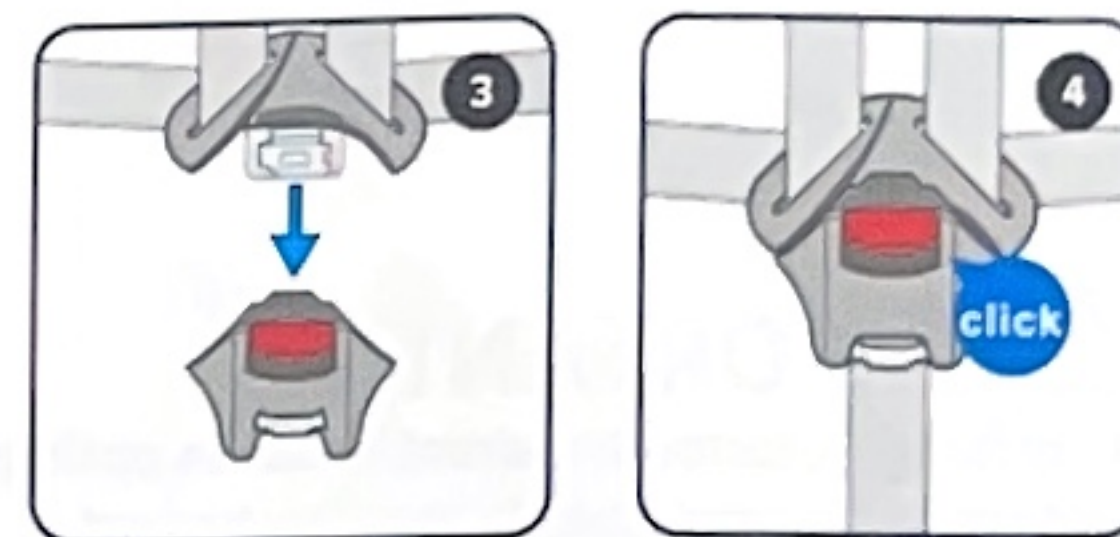

## 2. Adjusting harness

**Tighten harness:**  
Pull the adjuster strap until the harness lies flat and close against your child's body (fig. 5). Note. The harness should allow 1 finger width, approx. 1cm at the top of the shoulders for ideal fit.

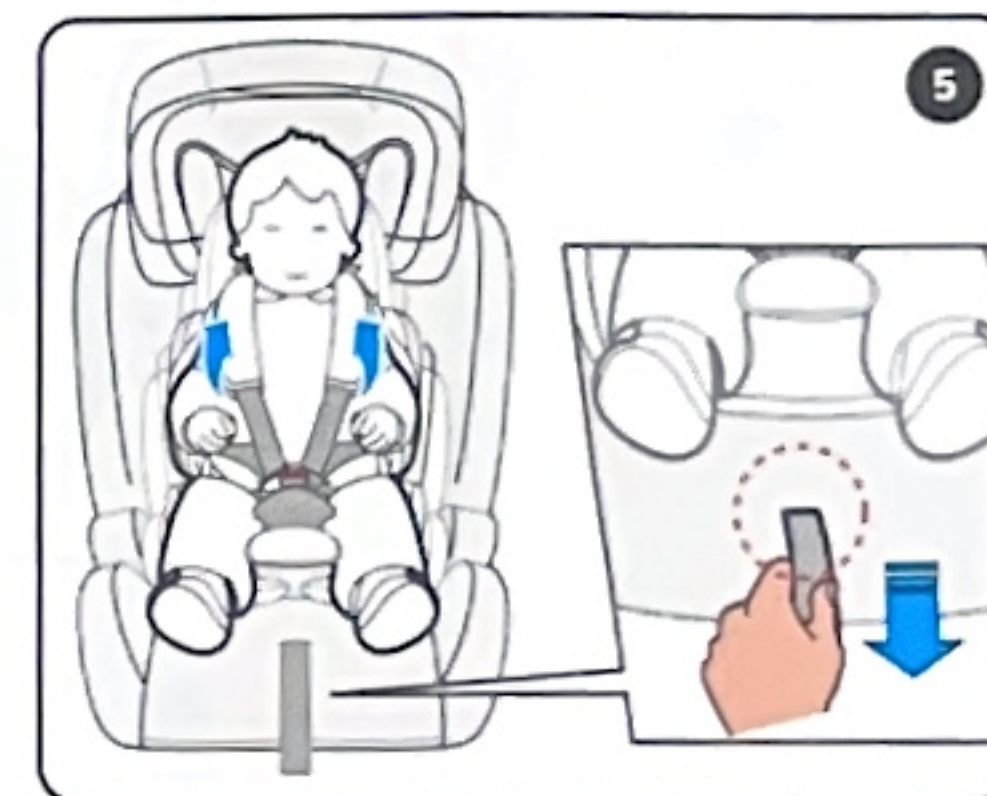

### **! WARNING!**

Do not add additional items such as blankets or padded clothing. Bulky items can lead to incorrect harness tightening. In an accident the child can slip out of the restraint if not properly tightened.

**Loosen harness:**  
Press the centre adjuster and at the same time pull both shoulder belts forwards (fig. 6) DO NOT pull on the shoulder pads.

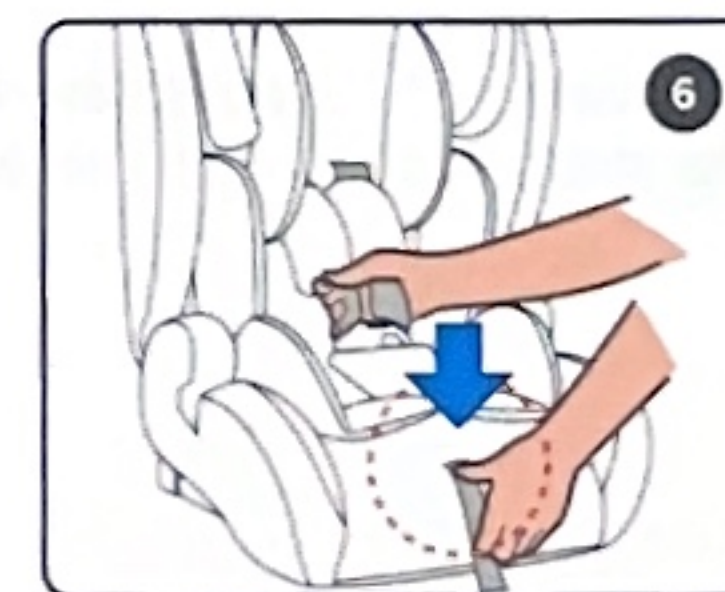

# Adjusting the Car Seat

## 3. Adjusting headrest

3.1. Loosen the harness (see section 2.)  
3.2. Adjust the headrest to the correct height by pushing the height adjuster and lift or push the headrest to the desired position (fig. 7).

3.3. The headrest must be adjusted so that there is a space two fingers wide between the headrest and your child's shoulders (fig. 8).

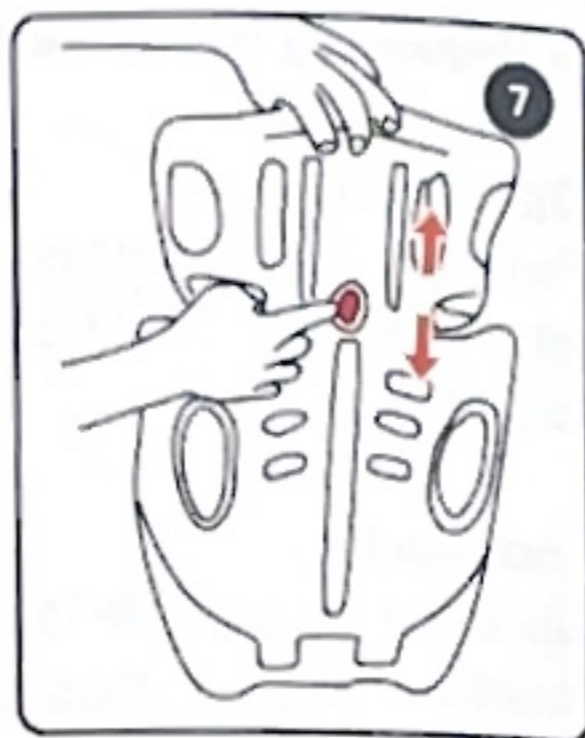

### IMPORTANT

A correctly adjusted headrest ensures optimal protection for your child in the safety seat.



## 4. Remove and install harness

4.1. At the back of the seat, remove the shoulder straps from the metal hook (fig. 9).



# Adjusting the Car Seat

4.2. Pull the straps out from the front of the seat (fig. 10).

4.3. Press the red button on the buckle to open it (fig. 11).

4.4. Thread the shoulder pads out through the backrest and remove from the seat (fig. 12).

4.5. Remove one buckle latch from the harness (fig. 13).

4.6. Lift back the seat cover and pull the harness through to remove completely (fig. 14). Rethread the buckle latch back onto the harness for safe keeping.

4.7. Under the cover, undo the main buckle strap from the metal retainer and then pull the buckle away from the seat to remove it (fig. 15). Store the metal retainer with the buckle.

4.8. Tighten the adjuster strap to store the metal hook under the seat (fig. 16).

4.9. To re-fit the harness: Simply follow the steps in the opposite order. Make sure the belt is not twisted.

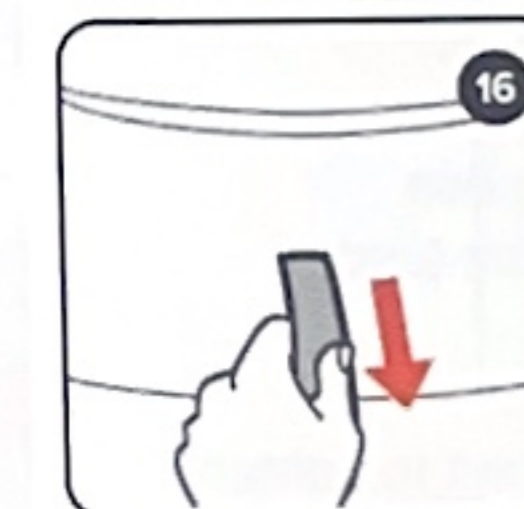
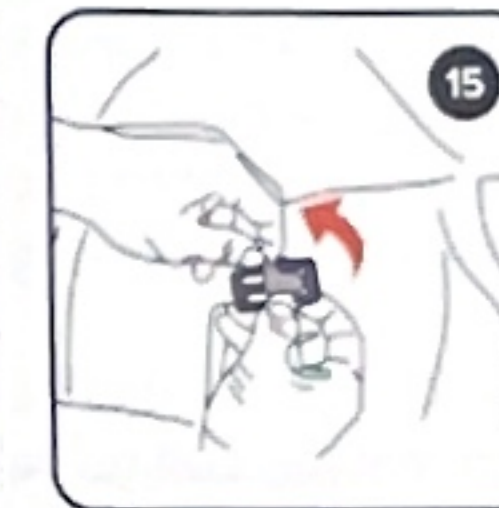
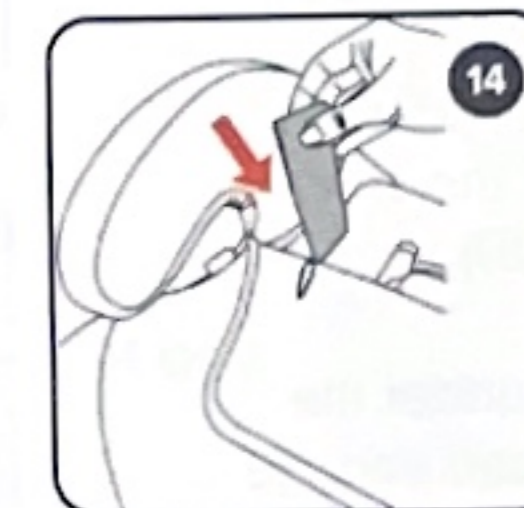
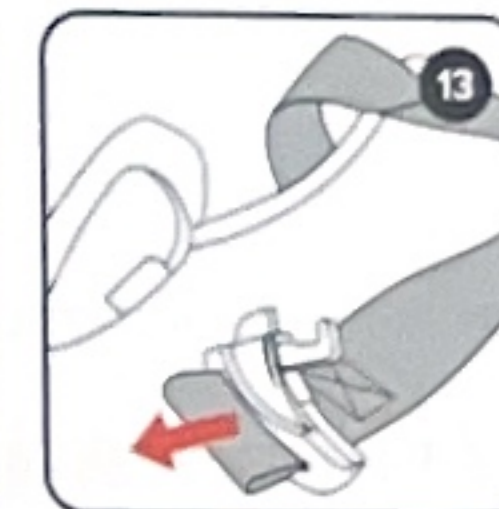
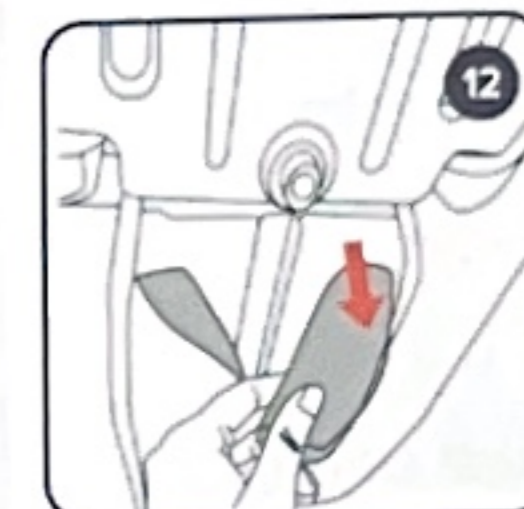
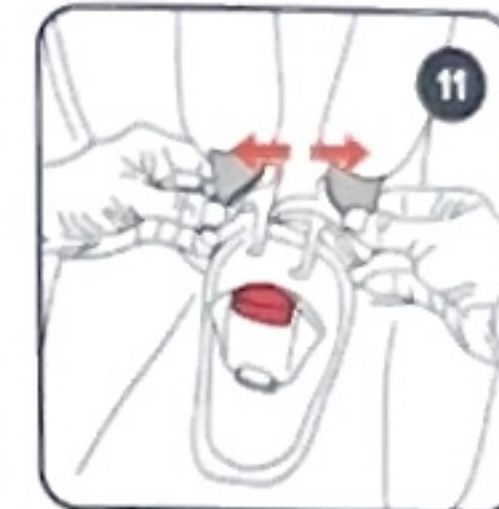
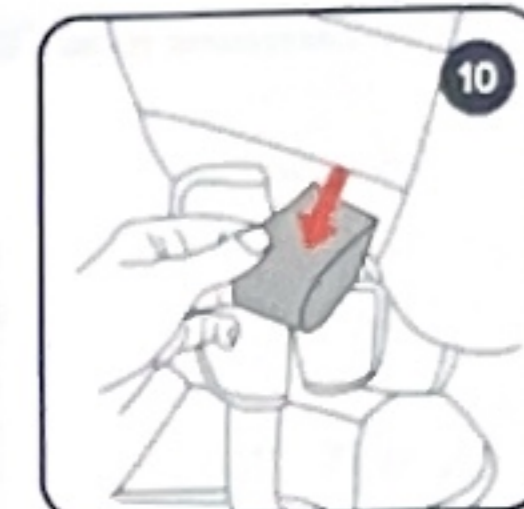

# Installation

## 5. Group 1 (9-18kg) 3-point vehicle seat belt

5.1. Place the child seat on the vehicle seat so that it rests fully on the seat and against the backrest without leaving any space (fig. 17).

Note. Do not place the child seat on a vehicle seat that is reclined.

5.2. Open buckle and remove the infant cushion (fig. 18).

Note. the infant cushion is not included with all models.

5.3. Pull out the vehicle seat belt and insert the diagonal belt through the diagonal belt guide (fig. 19).

Thread the diagonal belt under the seat covers and over the arm rest (lap belt guide) (fig. 20).

5.4. Position the lap belt under the arm rest (lap belt guide) and engage the buckle tongue in the vehicle seat belt buckle (fig. 21/ 22).

5.5. Guide the vehicle lap belt through the base belt guide (under the fabric flap) (fig. 23).

5.6. Pull on the diagonal belt to tighten the vehicle belts and replace the infant cushion (fig. 24).

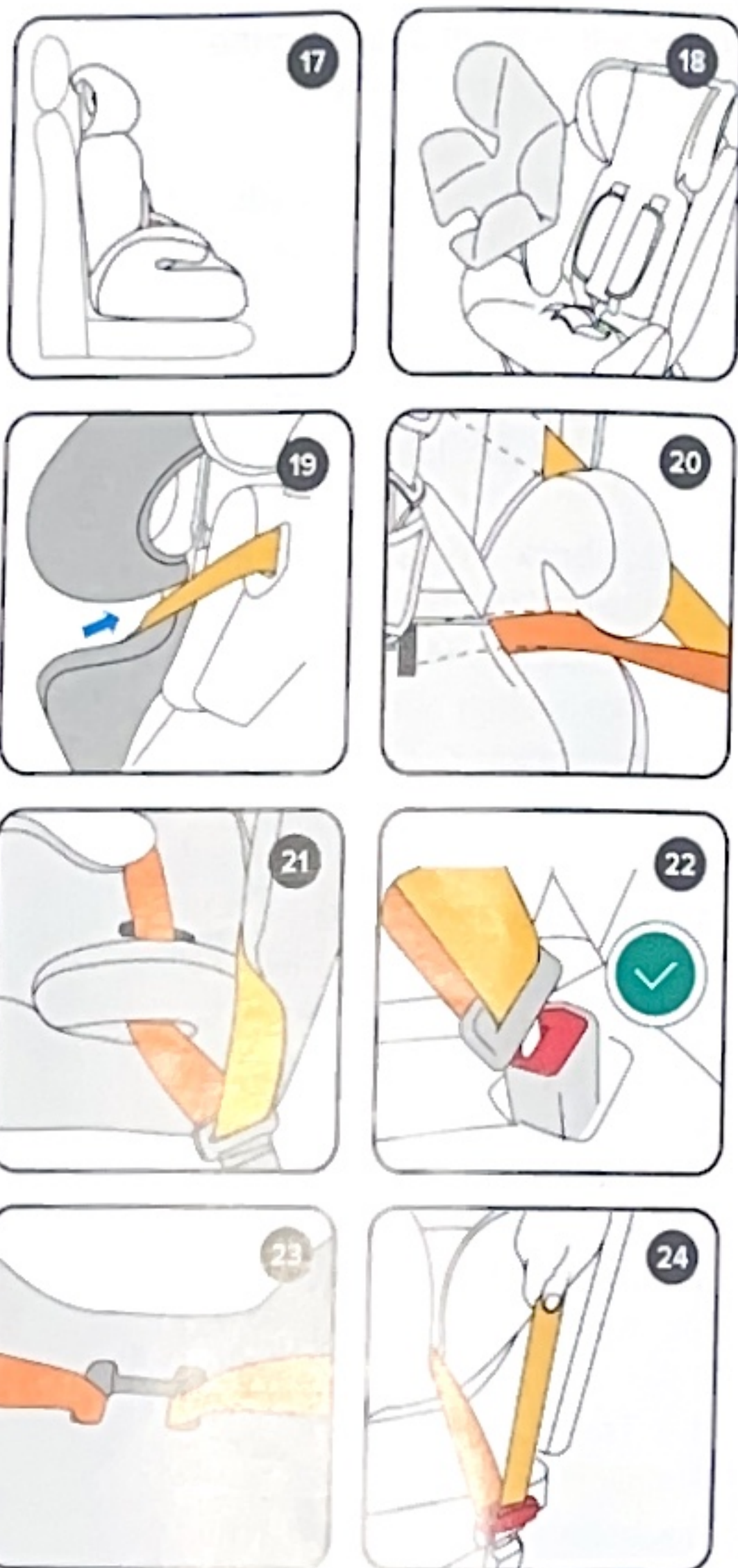

**CAUTION!**  
Make sure belt is not twisted and buckle is engaged.

# Installation

## 5. Group 1 (9-18kg) 3-point vehicle seat belt

5.7. Shake the child safety seat to make sure it is firmly installed in the vehicle (fig. 25).

5.8. Have your child sit down in the child seat. Adjust the headrest to required height (see section 3), adjust the harness and lock buckle (see section 1), and tighten harness (see section 2).



## 6. Group 2/3 (15-36kg) 3-point vehicle seat belt

6.1. Remove the harness when using for Group 2/3 (see section 4).

6.2. Place the child seat on the vehicle seat so that it rests fully on the seat and against the backrest without leaving any space (fig. 26).

Note. Do not place the child seat on a vehicle seat that is reclined.

6.3. Open buckle (fig. 27) (see section 1).

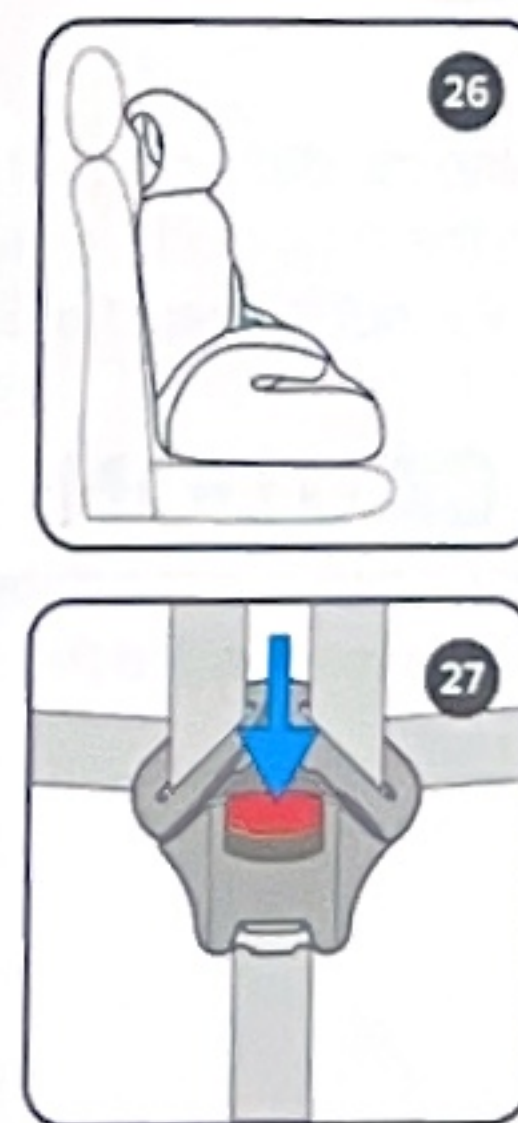

# Installation

6.4. Sit your child in the child seat. Adjust headrest to required height (see section 3).

6.5. Pull out the vehicle seat belt and guide it in front of your child to the vehicle seat buckle. Engage the buckle tongue into the vehicle seat buckle (fig. 28).

6.6. Place the diagonal belt section over the arm rest (lap belt guide) (fig. 29).

6.7. Place both lap belt sections under the arm rests (lap belt guide) (fig. 30).

## ⚠ CAUTION!

The lap belt section must lie as low as possible over the child's hips on both sides.

6.8. Guide the diagonal seat belt section through the shoulder belt guide and ensure it is not twisted (fig. 31).

## ⚠ CAUTION!

Make sure belt is not twisted and buckle is engaged (fig. 32).

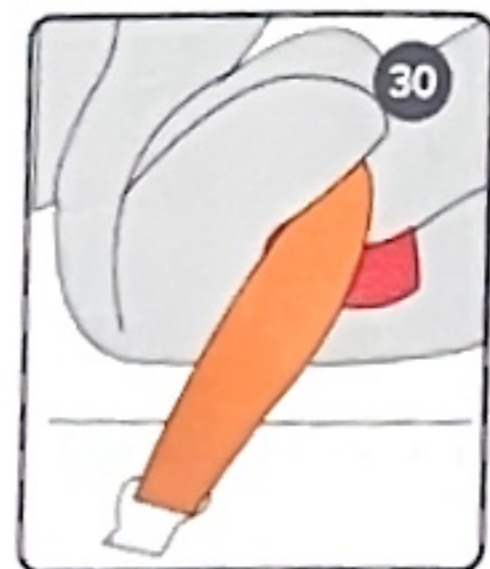
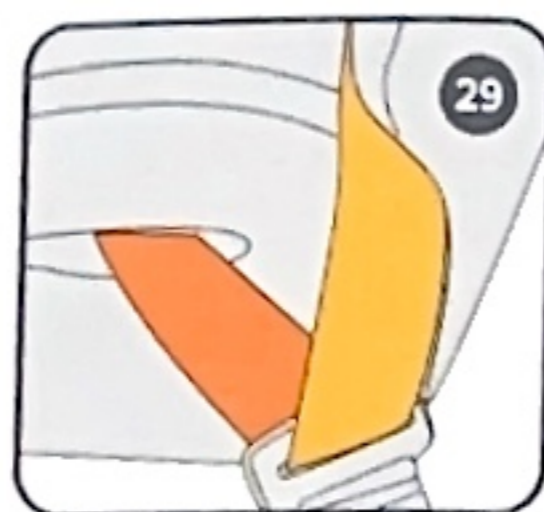
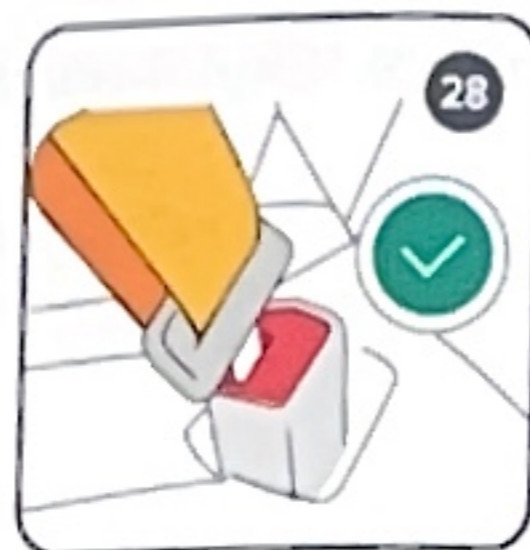
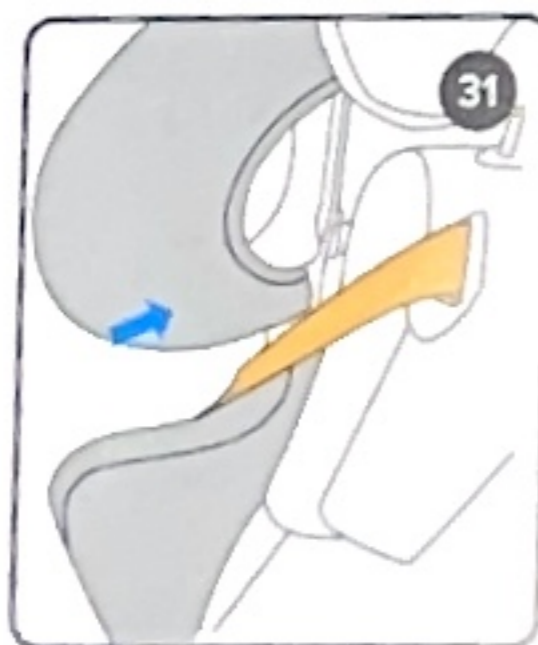

# Installation

## 7. Group 2/3 (15-36kg) 3-point vehicle seat belt without the backrest

7.1. Hold the seat base with one hand and push against the seat backrest with the other hand until the backrest detaches from the base (fig. 33/ 34).

7.2. Sit your child in the booster seat. Note, the booster seat must be placed as close as possible to the vehicle seat backrest, to allow the most comfortable position for the child.

7.3. Pull out the vehicle seat belt and guide it in front of your child to the vehicle seat buckle. Engage the buckle tongue into the vehicle seat buckle (fig. 35).

7.4. Place the diagonal belt section over the arm rest (lap belt guide) (fig. 36).

7.5. Place both lap belt sections under the arm rests (lap belt guide) (fig. 37).

## ⚠ CAUTION!

The lap belt section must lie as low as possible over the child's hips on both sides and the diagonal belt section must be positioned over the center of the child's shoulder.

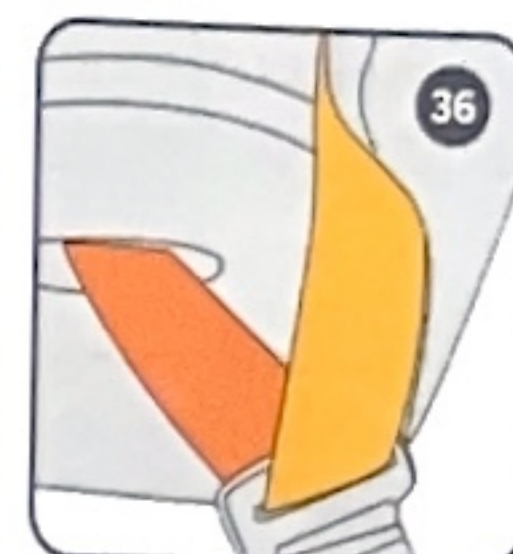
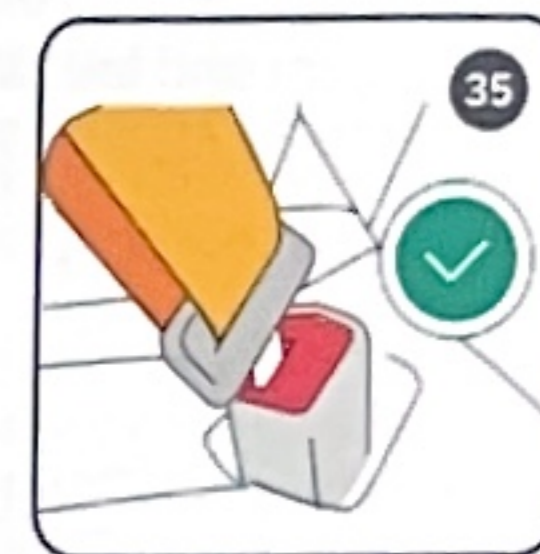
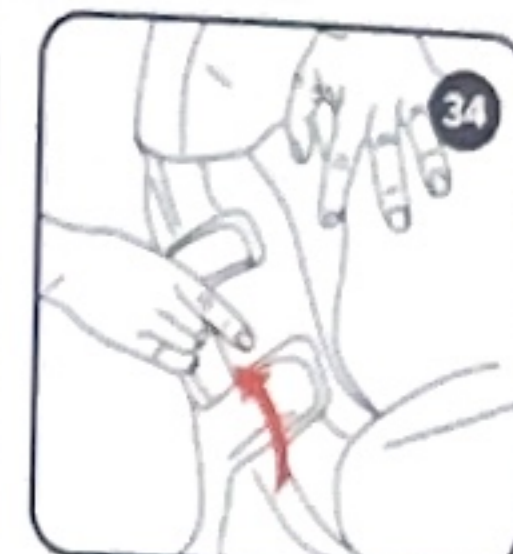

# Care and Maintenance

## Maintenance

It is important to only use the original upholstery as this is an essential part of the functionality.

Please remove the booster seat from the vehicle seat if not in use.

Put the booster seat in a cool, dry place where your child cannot access it.

## Cleaning

DO NOT wash fabrics. Spot clean only using a soft sponge with diluted detergent or water. Dry in shade and not in the sun. Do not iron. Do not dry clean. Wipe metals and plastic parts with a mild detergent and lukewarm water. DO NOT use chemical cleaners or bleaches (ammonia, petrol, solvents etc.) under any circumstances.

# Troubleshooting

Issue	Possible Cause	Solution
The 5-point harness does not adjust easily.	Twisted harness straps.	Undo the buckle and flatten the straps. If the twist is in the back, unhook the harness from the splitter plate, untwist, and reattach.
The 5-point harness does not tighten fully.	Dirt/food or foreign objects on straps can fall into buckle mechanism/locking mechanism.	Regularly check that the harness release button is free from debris especially before travel. Shake out loose debris from the seat regularly, especially after snacks or travel.
	The straps are dirty and cannot pass through the adjustment mechanisms easily.	Heavier soiling can be removed using a soft brush. Clean straps use a damp cloth with warm water and a very mild soap. Gently wipe the surface to remove grime.
Harness buckle is not fastening or feels stiff.	Dirt, food or foreign objects in the harness can fall into buckle mechanism.	Routinely check the buckle area for crumbs, dirt, or foreign objects. Vacuum the seat regularly.
Fabrics are dirty.	Dirt and debris accumulation, improper cleaning methods.	Shake out loose debris from the seat regularly, especially after snacks or travel. Vacuum the seat regularly. Covers can be hand washed in cool water.
Excessive car seat movement in Group 1 mode.	Incorrectly installed car seat.	It is normal for a car seat that has been installed in Group 1 using a 3-point car seat belt to have some side to side movement. A properly installed seat should move less than 2.5cm (1 inch) left or right but should have no front to back movement. Follow this instruction manual step by step to ensure the car seat is installed correctly.

Due to variation in style and design the illustrations used in this instruction manual are generic. Variation in design may occur in the images shown.



Supplied by Baby Factory NZ. Ltd.  
58 Stonedon Drive, East Tamaki, Auckland, New Zealand

[www.babyfactory.co.nz](http://www.babyfactory.co.nz)