

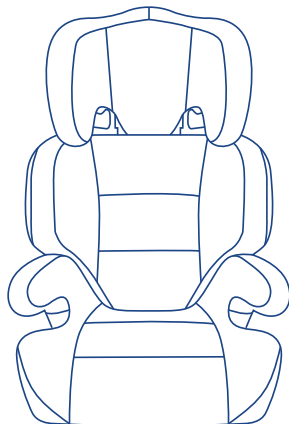

INSTRUCTION MANUAL



EST-09
Group 2/3
15kg to 36kg
(Approximately 4 years - 11 years)

ECE R 16 No 44.04

EST-09 Car Seat

NOTICE

1. This is a “Universal” child restraint. It is approved to Regulation No.44.04 series of amendments, for general use in vehicles and it will fit most, but not all car seat.
2. A correct fit is likely if the vehicle manufacturer has declared in the vehicle handbook that the vehicle is capable of accepting a “Universal” child restraint for this age group.
3. This child restraint has been classified as “Universal” under more stringent conditions than those which applied to earlier designs which do not carry this notice.
4. If in doubt, consult either the child restraint manufacturer or the retailer.



EST-09 Car Seat

Only suitable if the approved vehicles are fitted with 3 point safety belts, approved to UN/ECE Regulation No.16 or other equivalent standards.

EXTREME HAZARD

Do not use in passenger seats equipped with airbags(SRS)



SAFETY WARNINGS



EST-09 Car Seat

THESE INSTRUCTIONS ARE IMPORTANT. PLEASE READ CAREFULLY AND RETAIN FOR FUTURE REFERENCE.

PLEASE READ THOROUGHLY PRIOR TO INSTALLATION AS INCORRECT INSTALLATION COULD BE DANGEROUS.

- This child seat should be used for children of 15kgs to 36kgs (approx 4 years to 11 years) (Group 2/3).
- This seat can only be installed forward facing using a three-point lap and diagonal seat belt.
- These instructions can be retained on the baby seat for life period.
- Do not use this child seat at home. It has not been designed for home use and should only be used in your vehicle.
- The safest seating position for this child is on the rear seat of a vehicle.

EST-09 Car Seat

- Never use the child seat without fastening the vehicle belt correctly correctly and never attempt to use it without fastening into the vehicle.

- Do not add to or modify the seat in any way.

- Do not leave your child unattended in the seat at any time.

- Car interiors can become very hot when in direct sunlight.

It is therefore recommended that the child seat should be covered when not in use. This prevents components, particularly those attached to the child seat ,becoming hot and burning the child.

- Luggage and other heavy or sharp objects should be secured in the car. Loose objects are liable to cause injury in the event of an accident.

- Store this child seat in a safe place when it is not being used. Avoid placing heavy objects on top of it. Do not allow your child seat to come into contact with corrosive substances e.g. Battery acid.

EST-09 Car Seat

- The device should be changed when it has been subject to violent stresses in an accident.
- The rigid items and plastic parts of a child restraint must be so located and installed that they are not liable, during everyday use of the vehicle to become trapped by movable seat or in a door of the vehicle.
- Any straps holding the restraint to the vehicle should be tight. Any straps restraining the child should be adjusted to the child's body and the straps should not be twisted.
- It is important to ensure that any lap strap is worn low down, so that the pelvis is firmly engaged.
- It is dangerous to make any alterations or additions to the device without the approval of the competent authority, and a danger of not following closely the installation provided by the child restraint manufacturer.

EST-09 Car Seat

- When the chair is not provided with a textile cover, the chair should be kept away from sunlight, otherwise it may be too hot for the child's skin.
- Ensure that children are not left in their child restraint system unattended.
- Any luggage or other objects liable to cause injuries in the event of a collision shall be properly secured.
- The child restraint must not be used without the cover.
- The seat cover should not be replaced with any other than the one recommended by the manufacturer, because the cover constitutes an integral part of the restraint performance.
- Do not use any load bearing contact points other than those described in the instructions and marked in the child restraint.

THE TYPE OF APPROVED SEAT BELT YOU MUST HAVE

EST-09 Car Seat

WARNING: THE CAR SEAT SHOULD NOT BE FITTED IN A PASSENGER SEAT OF A CAR THAT HAS AN AIRBAG FITTED. (SRS)

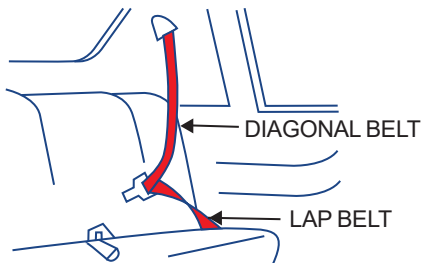

Your child seat can only be installed forward facing using a three-point lap and diagonal seat belt in the front or rear passenger seats of the car.

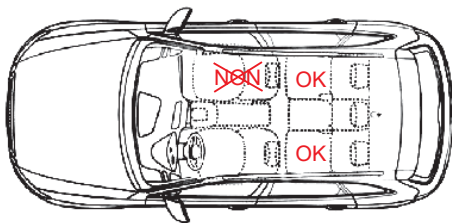

C | S
— COZY N SAFE —

CHILD CAR SEAT PARTS



EST-09 Car Seat

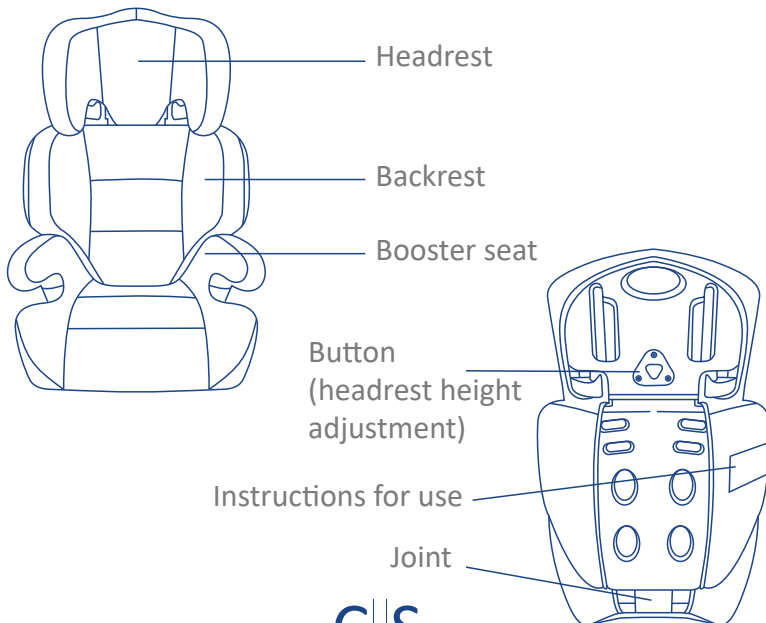

ATTACHING THE BACKREST



EST-09 Car Seat

The child seat is composed of a seat cushion and a backrest with an adjustable headrest.

Instructions for use

- Place the backrest flat behind the seat cushion (A).
- Insert into the seat joint.
- Pull the backrest into an upright position (B & C).

Danger! When pulling up the backrest, nothing must come between the backrest and the seat cushion in the area of the joint.

Caution! Please keep your fingers away from the joint to prevent injury.

EST-09 Car Seat

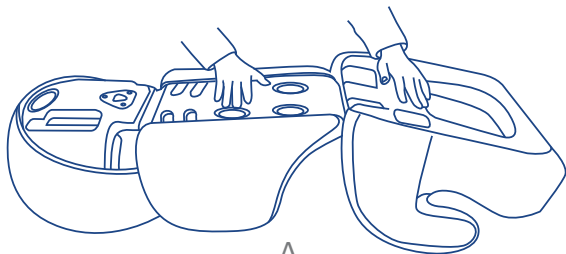

A

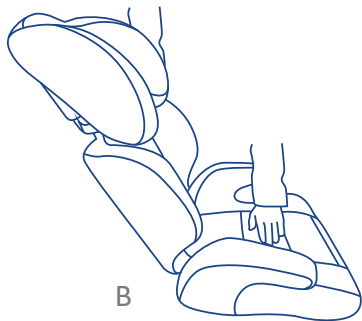

B

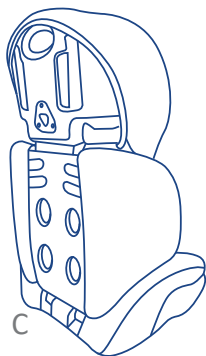

C

C | S
— COZY N SAFE —

ADJUSTING THE HEADREST HEIGHT

EST-09 Car Seat

15-25kg Group 2

According to the child's height, the headrest can be adjusted up and down.

Step 1. Put your left (or right) hand on the backrest.

Step 2. To raise the headrest place your knee on the seat cushion and press the button with your finger whilst simultaneously lifting the headrest with your left (or right) hand.

Step 3. Move the headrest up and down as needed to ensure that the position is correct for your child.



FITTING THE CAR SEAT



EST-09 Car Seat

FITTING THE CAR SEAT USING THE BELT GUIDE

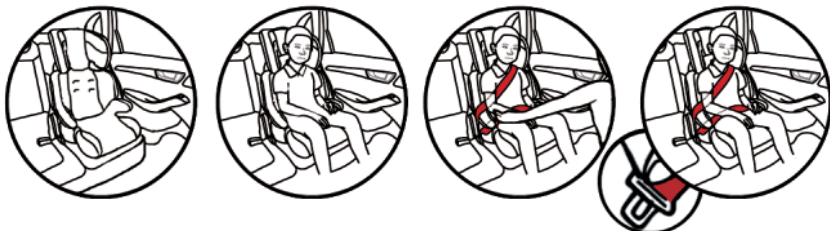

Step 1. Place the safety seat on the vehicle's seat ensuring it is firmly pressed against the car backrest.

Step 2. Place the child in the child safety seat.

EST-09 Car Seat

Step 3. Fasten the seat belt, making sure that both sections of the seat belt webbing goes under the armrest, the diagonal belt goes through on the top of the armrest, then feed it through the red belt guide on the side of the headrest but not through the belt guide hook. Check that the webbing has not become twisted and tighten the seat belt by pulling the diagonal strap upwards.

Make sure the seat belt has not become twisted.

Also check that the cover is not impeding the movement or fit of the seat belt webbing in any way.

To release your child, simply unfasten the seat belt in the normal way.

EST-09 Car Seat

BOOSTER SEAT 22-36kg Group 3

IMPORTANT: Remove the seat backrest

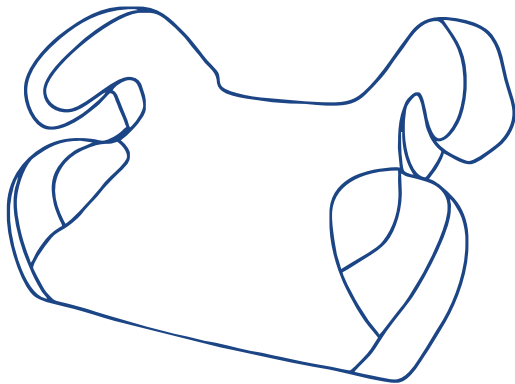

EST-09 Car Seat

FITTING THE CAR SEAT USING THE BELT GUIDE

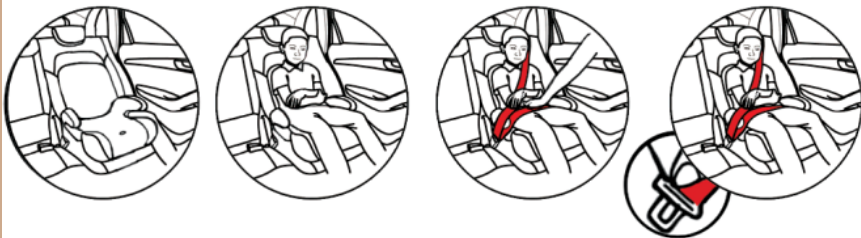

Step 1. Place the booster on the seat of the vehicle ensuring it is firmly against the vehicles seat and back rest.

Step 2. Place the child in the child safety seat.

EST-09 Car Seat

Step 3. Fasten the seat belt, making sure that the lap belt webbing goes under both armrest and diagonal belt webbing goes through on the top of the armrest.

Check the webbing has not become twisted then tighten the seat belt by pulling upwards on the diagonal strap.

Make sure the seat belt has not become twisted.

Also check that the cover is not impeding the movement or fit of the seat belt webbing in any way.

To release your child, simply unfasten the seat belt in the normal way.

EST-09 Car Seat

DAILY CARING INSTRUCTIONS

1. Remove/replacing the cover

Undo the elastic of the car seat, remove the cover directly off the seat where as you can put on the cover.

2. Cleaning

Use only neutral detergent and warm water to wash, do not wash by machine.

Spin-dry or tumble dry are not recommended.

THE COVER SHOULD BE HAND WASHED ONLY.



EST-09 Car Seat

PROCEDURE AFTER AN ACCIDENT

1. The child car seat must be replaced when it has been subjected to violent stresses in an accident.
2. Correctly install the child car seat according to the instruction manual.
3. Do not remodel or alter the car seat in any way as this may be dangerous.

CHILD INFORMATION
(KEEP WITH CAR SEAT AT ALL TIMES IN
CASE OF EMERGENCY)

NAME:

.....

DATE OF BIRTH (DD/MM/YYYY):

.....

ADDRESS:

.....

.....

.....

ALLERGIES/MEDICAL CONDITIONS:

.....

.....

.....

EMERGENCY CONTACT 2:

NAME:

.....

PHONE NUMBER:

.....

EMERGENCY CONTACT 2:

NAME:

.....

PHONE NUMBER:

.....



www.cozynsafe.com

DISTRIBUTED BY

Baby Factory (NZ) Ltd
58 Stonedon Dr, East Tamaki
Auckland 2013, New Zealand
Ph 09 2744986
www.babyfactory.co.nz